

Flat 3, Waterloo Court Lapwing Lane, West Didsbury, Manchester, M20 2NT



JP & Brimelow
ESTATE AGENTS



🛏️ 2 🚿 2 🛋️ 1 ☰ C

VIDEO TOUR AVAILABLE This exceptional and distinctive top-floor apartment is located within the highly sought-after Waterloo Court on Lapwing Lane, occupying what is arguably one of the finest positions in the development, right in the heart of West Didsbury. Beautifully presented throughout and finished to a high specification, the spacious accommodation comprises a generous entrance hallway with space for a home office area, a bright and airy lounge/dining room, a modern fitted kitchen, a stylish three-piece bathroom, and two well-proportioned double bedrooms. The principal bedroom further benefits from a contemporary three-piece en-suite shower room. Additional features include a secure telephone entry system, gas central heating via a combination boiler, allocated off-road parking, and a substantial private boarded loft with a pull-down ladder, offering excellent storage space. The property is just moments from the vibrant selection of bars, cafés, restaurants, and independent shops along Burton Road, while also benefiting from excellent transport links, with the Metrolink within easy walking distance providing convenient access to Manchester city centre and beyond. Early viewing is highly recommended to fully appreciate the quality, space, and unique appeal of this outstanding home.

£300,000





EPC Chart

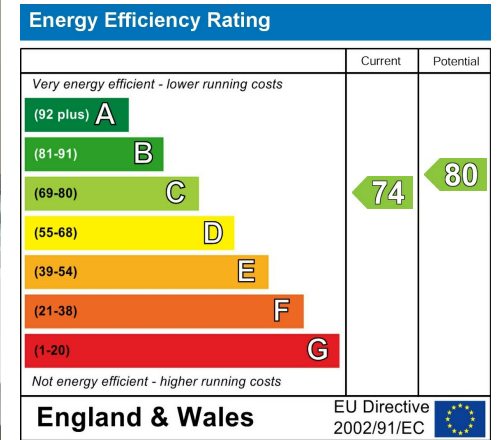

Tenure: Leasehold Council Tax Band: C

Second Floor

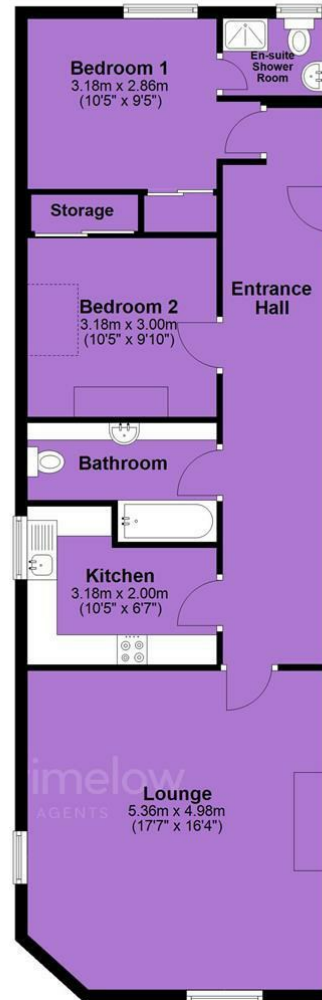

JP & Brimelow Estate Agents Ltd
430 Barlow Moor Road, Manchester, M21 8AD
Tel: 0161 8822233
E: sales@jpbrimelow.co.uk www.jpandbrimelow.co.uk



JP & Brimelow
ESTATE AGENTS

NOTICE: JP & Brimelow Estate Agents Ltd for themselves and for the vendors or lessors of this property whose agents they are give notice that:

- (i) the particulars are set out as a general outline only for the guidance of intending purchasers or lessees, and do not constitute, nor constitute part of, an offer or contract;
- (ii) all descriptions, dimensions, references to the condition and necessary permissions for use and occupation, and other details are given in good faith and are believed to be correct but any intending purchasers or tenants should not rely on them as statements or representations of fact but must satisfy themselves by inspection or otherwise as to the correctness of each of them;
- (iii) no person in the employment of JP & Brimelow Estate Agents Ltd has any authority to make or give any representation or warranty whatever in relation to this property.

 [jpandbrimelowstateagents](https://www.instagram.com/jpandbrimelowstateagents)

 [@jpandbrimelow](https://www.twitter.com/jpandbrimelow)

