



## Appleby Close

Darlington DL1 4AJ

Offers Over £90,000





This footer paragraph is an example only and should not be relied upon as complying with current legislation. These particulars, whilst believed to be accurate are set out as a general outline only for guidance and do not constitute any part of an offer or contract. Intending purchasers should not rely on them as statements of representation of fact, but must satisfy themselves by inspection or otherwise as to their accuracy. No person in this firms employment has the authority to make or give any representation or warranty in respect of the property.

# Appleby Close

## Darlington DL1 4AJ



- 2 Bedroom 2nd Floor Apartment
- Charming Style Viewing Advised
- Modern Interior Newly Decorated And Carpeted Throughout

- Kitchen Diner Area
- Located Close To Train Station
- EPC Grade C

- Allocated Parking Bay
- Ideal First Home Or Investment
- No Chain

Welcome to this charming apartment located on Appleby Close in the heart of Darlington. This delightful property offers a perfect blend of comfort and convenience, making it an ideal choice for individuals or small families seeking a welcoming home.

Upon entering, you will find a spacious reception room that provides ample space for relaxation and entertaining. The natural light that floods through the windows creates a warm and inviting atmosphere throughout the apartment.

The property features two well-proportioned bedrooms, each offering a peaceful retreat for rest and relaxation. These rooms are designed to accommodate your personal style and furnishings, ensuring a comfortable living experience.

Completing this lovely apartment is a modern bathroom, equipped with essential amenities to cater to your daily needs.

Situated in a desirable location, this apartment benefits from easy access to local shops, schools, and transport links, making it a practical choice for those who value convenience.

In summary, this apartment on Appleby Close presents an excellent opportunity for anyone looking to settle in Darlington. With its generous living spaces, two bedrooms, and a prime location, it is a property that should not be missed. We invite you to come and experience the charm of this delightful home for yourself.

### Communal Entrance

With intercom system, main door and stairs to the apartment.

### Hallway

A hallway that efficiently connects the principal rooms and includes a useful storage cupboard, contributing to the practical arrangement of the accommodation.

### Lounge

21'1" x 12'3" (6.42m x 3.74m)

A spacious lounge measuring 6.42 by 3.74 metres, filled with natural light from a

pair of French doors and an additional window. The neutral decor, complemented by soft carpeting, creates a calm and inviting atmosphere, ideal for relaxing or entertaining.

### Kitchen

12'3" x 6'8" (3.74m x 2.02m)

A charming kitchen with a practical layout, featuring light wood cabinetry and contrasting dark worktops. The space includes a window that allows natural light, undercounter space for appliances, and a built-in oven with a gas hob, providing a functional area for cooking and meal preparation.

### Bedroom 1

12'2" x 12'2" (3.72m x 3.72m)

The main bedroom offers a comfortable and generously sized space of 3.72 by 3.72 metres. It features a window that fills the room with daylight, a neutral palette, and dark carpeting, creating a restful environment.

### Bedroom 2

11'5" x 7'3" (3.47m x 2.20m)

A smaller bedroom measuring 3.47 by 2.20 metres, with a window providing natural light. The room is simply decorated with neutral walls and dark carpet, making it suitable as a guest room, nursery, or home office.

### Bathroom

11'2" x 4'7" (3.40m x 1.40m)

A modern bathroom featuring a white suite with a pedestal sink, toilet, and a bath with a over head shower and glass screen. The walls are tiled in a dark slate style, which contrasts with the white fittings and adds a contemporary feel. A small window ensures ventilation and natural light.

### Outside

Situated in communal grounds with allocated parking bay.

### Tenure

Freehold

### Property Details

Local Authority: Darlington

Council Tax Band: B

Annual Price: £

Conservation Area No

Flood Risk Very low

Floor Area 0 ft 2 / 0 m 2

Plot size 0.02 acres

Mobile coverage

EE

Vodafone

Three

O2

Broadband

Basic

9 Mbps

Superfast

80 Mbps

Satellite / Fibre TV Availability

BT

Sky

Virgin

### Note

IMPORTANT NOTE TO PURCHASERS: We endeavour to make our sales particulars accurate and reliable, however, they do not constitute or form part of an offer or any contract and none is to be relied upon as statements of representation or fact. The services, systems and appliances listed in this specification have not been tested by us and no guarantee as to their operating ability or efficiency is given. All measurements have been taken as a guide to prospective buyers only, and are not precise. Floor plans where included are not to scale and accuracy is not guaranteed. If you require clarification or further information on any points, please contact us, especially if you are travelling some distance to view. Fixtures and fittings other than those mentioned are to be agreed with the seller. We cannot also confirm at this stage of marketing the tenure of this house

2ND FLOOR  
677 sq.ft. (62.9 sq.m.) approx.

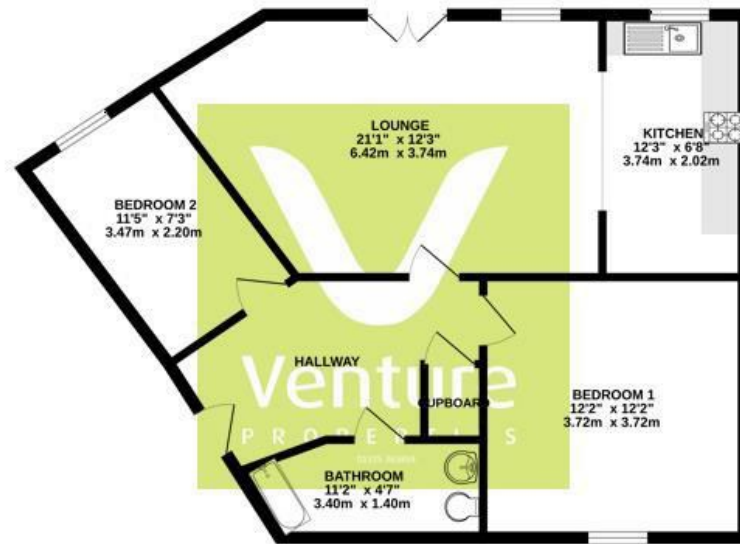

TOTAL FLOOR AREA: 677 sq.ft. (62.9 sq.m.) approx.  
While every attempt has been made to ensure the accuracy of the floorplan contained herein, measurements of floors, structure, rooms and any other items are approximate and no responsibility is taken for any error, omission or mis-statement. This plan is for illustrative purposes only and should be used as such by any prospective purchaser. The services, systems and appliances shown have not been tested and no guarantee as to their operability or efficiency can be given.  
Made with iStockphoto ©2026

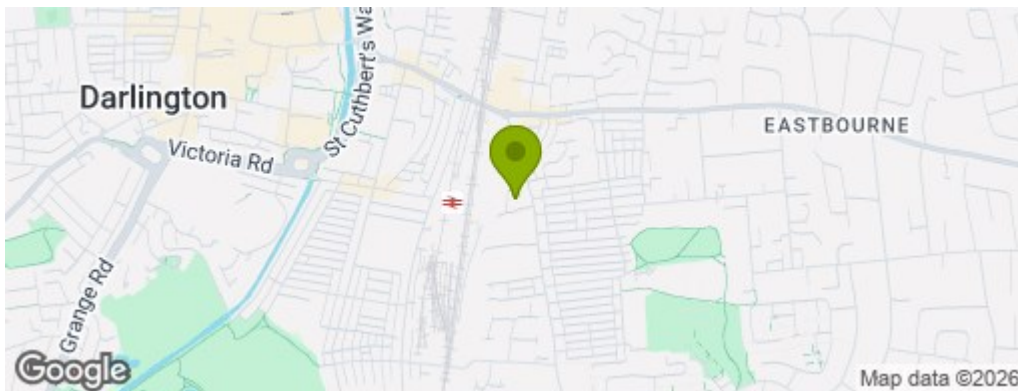

## Property Information

01325 363858

45 Duke Street, Darlington, County Durham, DL3 7SD  
sales@venturepropertiesuk.com