

ALLDAY  
& MILLER

Mortise House, Hayes, UB3 3FP  
£410,000

 2  2  1  B





## Mortise House, Hayes, UB3 3FP

**£410,000**

- Two Double Bedrooms
- Large Private Balcony
- Great Condition
- Modern Fitted Integrated Kitchen
- 0.3 miles to Hayes & Harlington
- Secure Underground Parking
- Two Bathrooms
- Lift Access
- Long 900+ Year Lease
- EPC Rating: B



## Description

This delightful home offers a perfect blend of comfort and modern living comprises of a spacious light filled reception with a modern fitted kitchen which provides access to the private balcony, two double bedrooms ( master with ensuite ) and to complete is a family bathroom.

Additionally, residents will benefit from dedicated parking, access to communal grounds and a bike shed.

## Situation

Mortise House situated on Pump Lane is a prime location in the heart of Hayes being close to a number of local amenities including the town centre with a number of local shops, cafes, takeaways and coffee shops. Hayes and Harlington station with the Elizabeth line is just moments away making the journey into central London a breeze. Along with the bus station providing several routes to the local surrounding area. A number of highly regarded schools within the local area including Harlington school and Botwell House Catholic primary school.





## Floor Plans

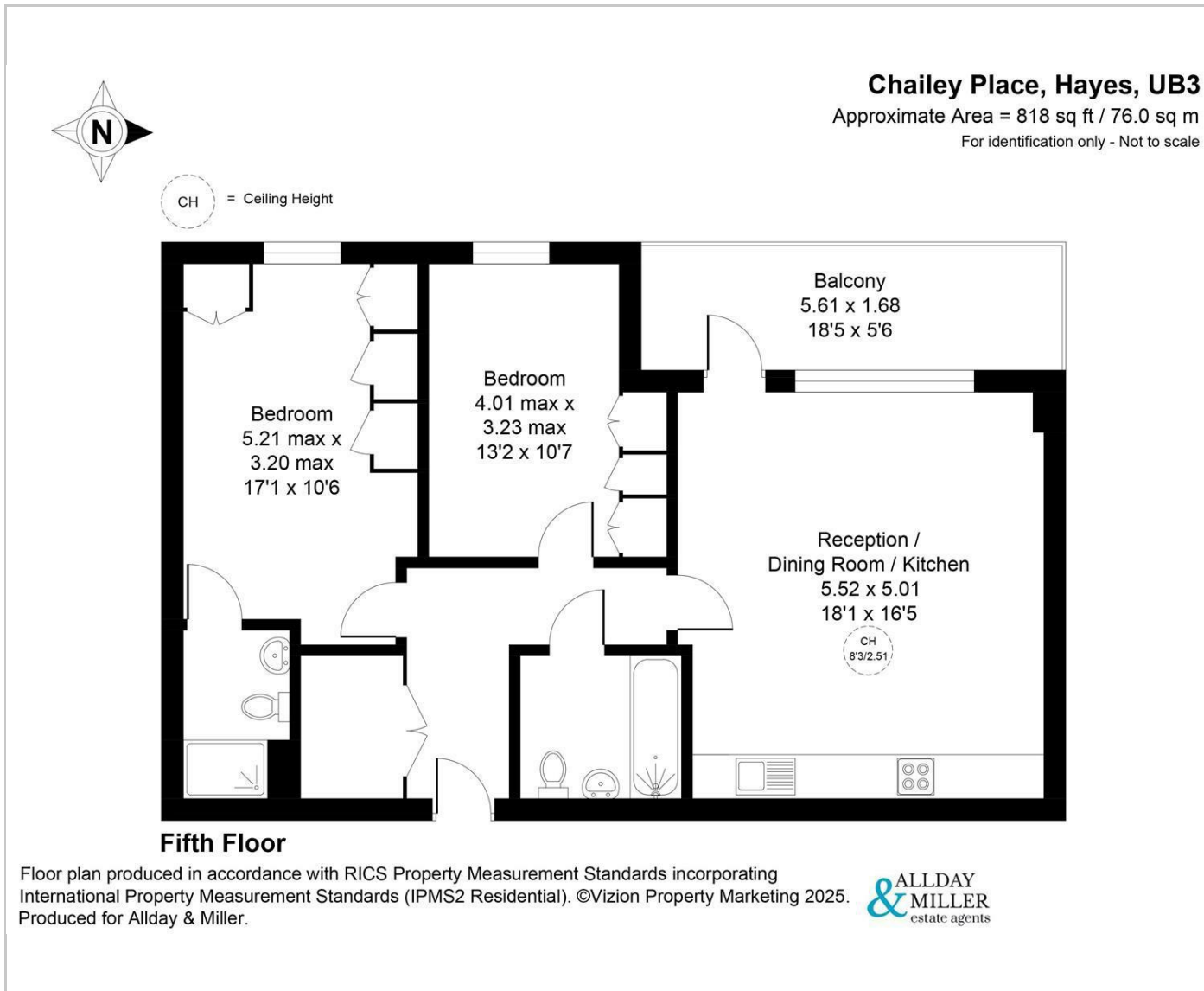

## Area Map

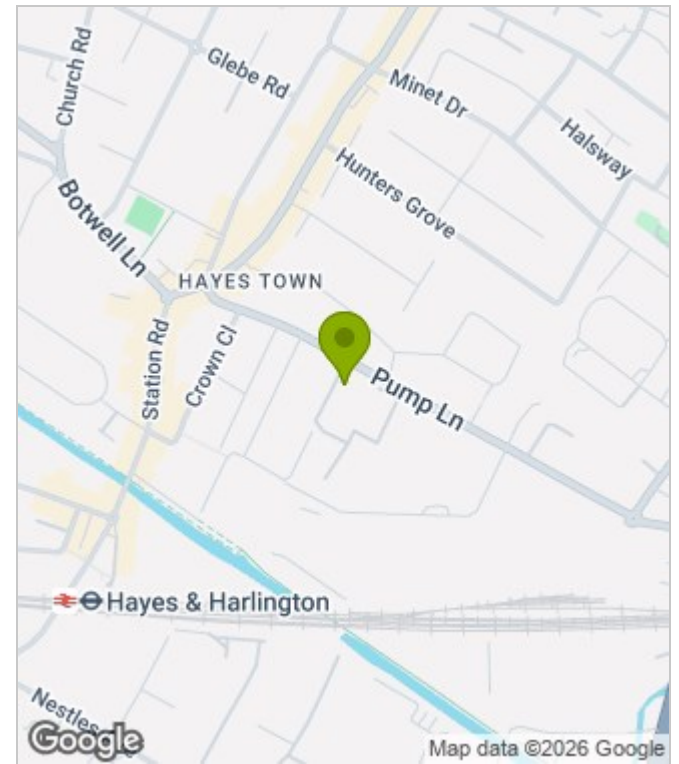

## Energy Performance Graph

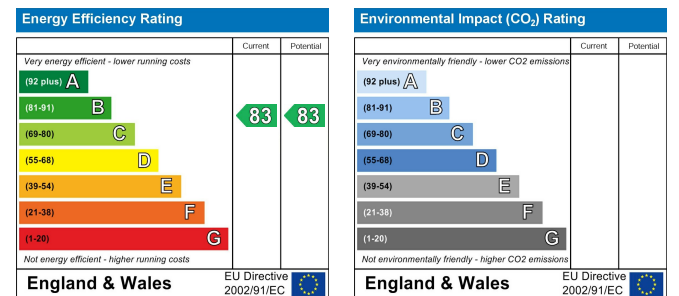

These particulars, whilst believed to be accurate are set out as a general outline only for guidance and do not constitute any part of an offer or contract. Intending purchasers should not rely on them as statements of representation of fact, but must satisfy themselves by inspection or otherwise as to their accuracy. No person in this firm's employment has the authority to make or give any representation or warranty in respect of the property.