

Fords.

SALES | LETTINGS | NEW HOMES

St. Marks Close High Wycombe HP13 6HQ



St. Marks Close High Wycombe HP13 6HQ

Asking price £275,000

This two bedroom apartment is located within walking distance to High Wycombe town centre and railway station. The accommodation comprises entrance hallway, open plan fitted kitchen/lounge/dining room, master bedroom with en-suite, additional double bedroom and family bathroom. The property benefits from UPVC double glazing, gas central heating, allocated parking.

Description



Situation



Floor Plans

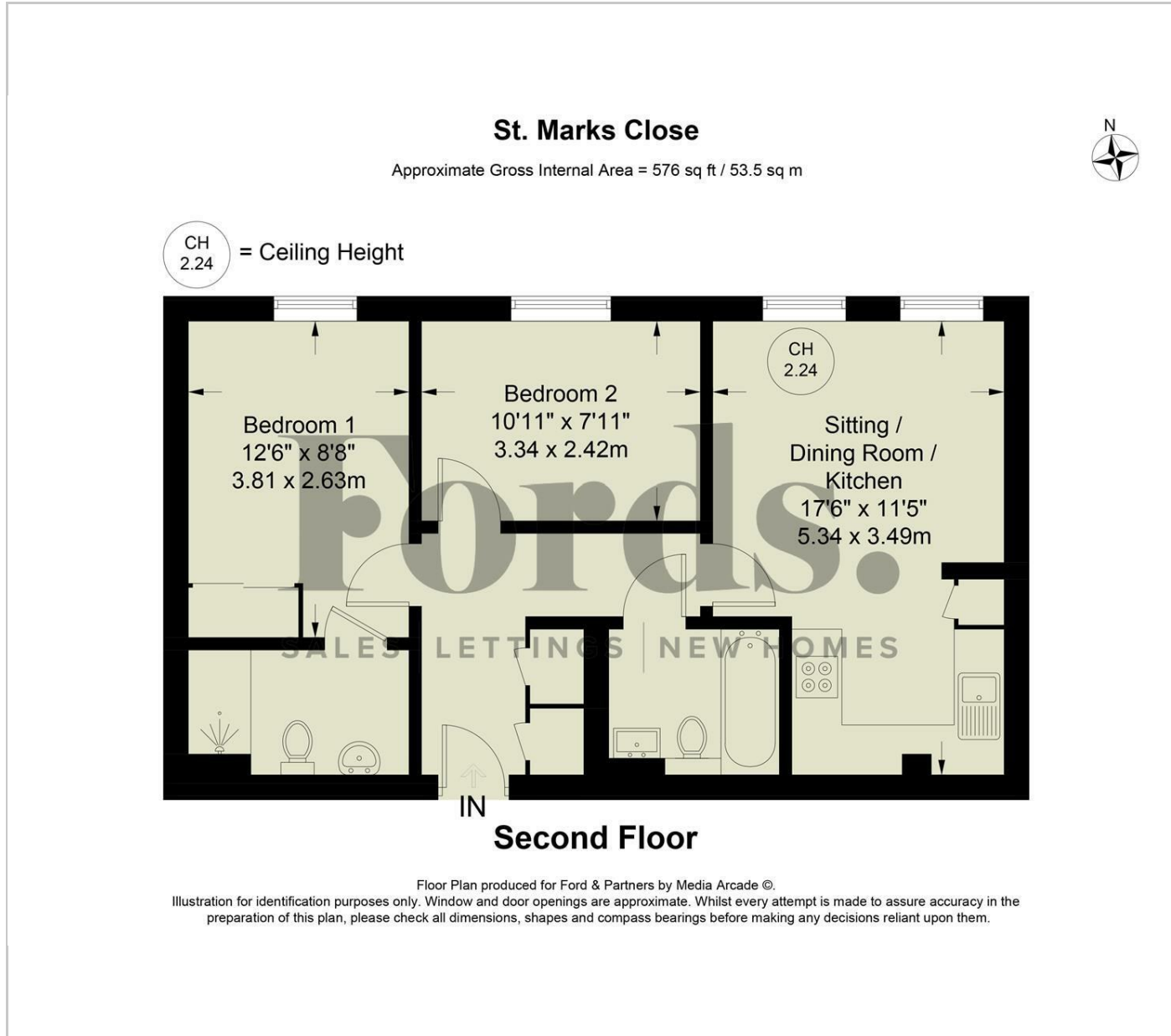

Area Map

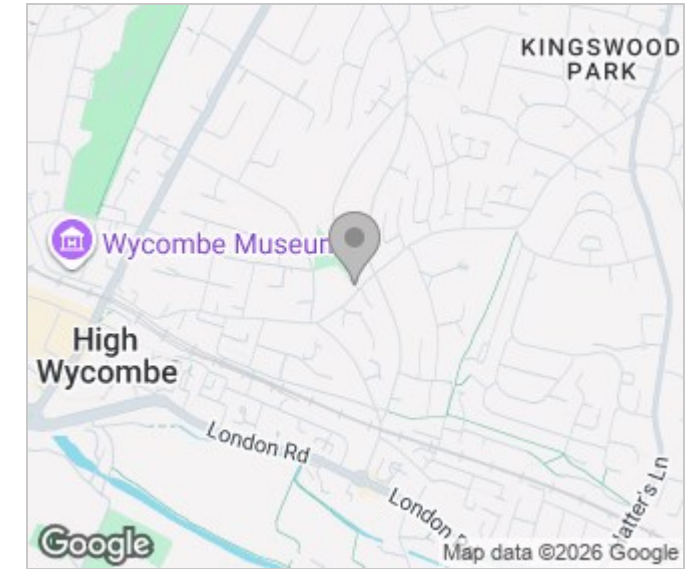

Energy Performance Graph

