



BOYSON ROAD, SE17

£625,000

Modern development
Residents' bike store
Balcony
Chain free
Off-street parking
Communal gardens

@marshandparsons
marshandparsons.co.uk

MARSH &
PARSONS



ABOUT THE PROPERTY

A well-presented three bedroom, two bathroom apartment in excellent condition. The bright living room opens onto a fitted kitchen, and leads to a private south facing balcony. The property offers three well-proportioned bedrooms, including a principal bedroom with en suite, plus a contemporary family bathroom. Additional benefits include allocated off-street parking, residents' bicycle storage, and access to communal gardens.

Roffo Court is quietly positioned just off Walworth Road, offering convenient access to Elephant & Castle station, providing excellent transport links. A wide selection of local shops, cafés, and restaurants are nearby, along with the green open spaces of Burgess Park.



STEP INSIDE BOYSON ROAD

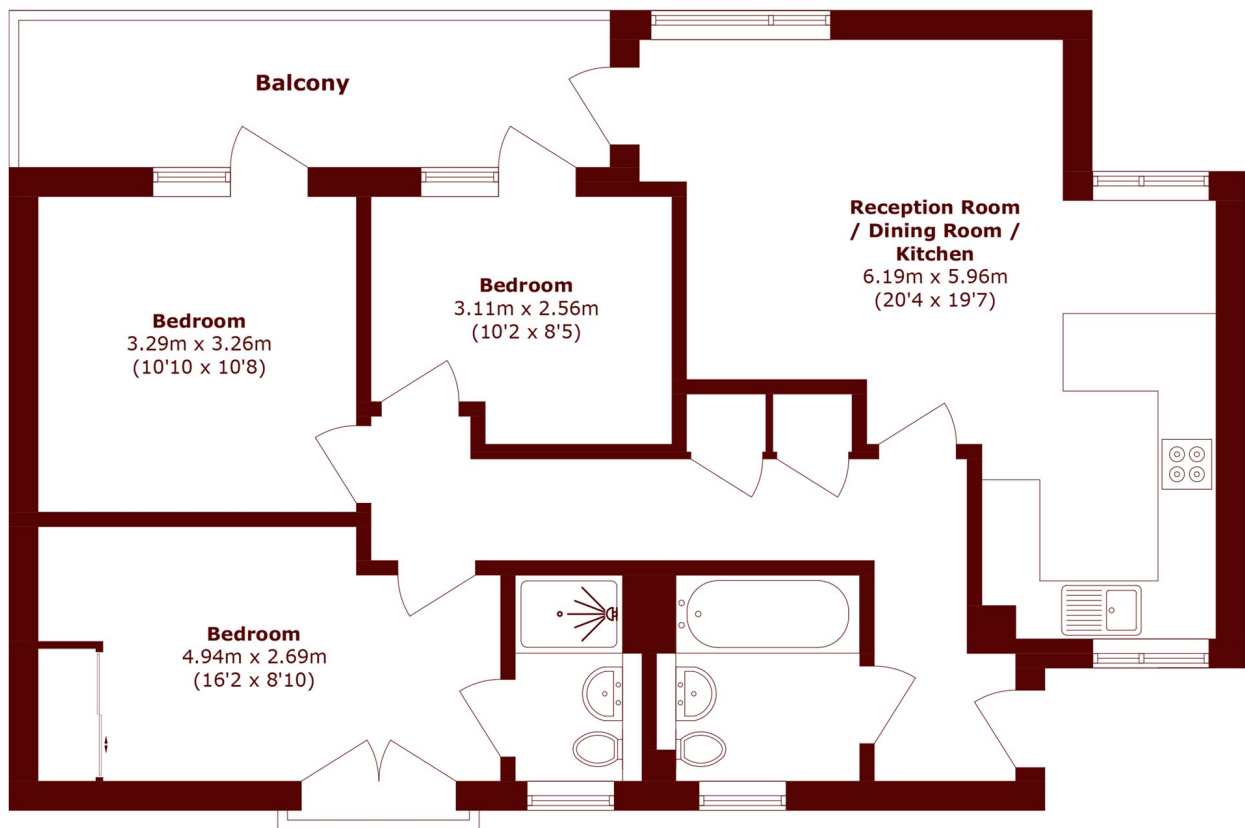

Total area (approx.): 77.4 sq. m (833.1 sq. ft)

Balcony area (approx.): 9.2 sq. m (99.0 sq. ft)

Kennington
020 7587 1533

Energy Rating: We aim to make our particulars both accurate and reliable. However, they are not guaranteed; nor do they form part of an offer or contract. If you require clarification on any points then please contact us, especially if you're traveling some distance to view. Please note that appliances and heating systems have not been tested and therefore no warranties can be given as to their good working order

**MARSH &
PARSONS**