



## Bourne Terrace , London, W2

**£2,500 Per annum**

A two-bedroom lower ground floor apartment set within a well-maintained purpose-built building on a quiet residential street in W2. The accommodation is arranged over approximately 723 sq ft and comprises an entrance hallway, kitchen, living room, two double bedrooms, and a bathroom. There is also an enclosed balcony area with sliding doors opening onto a private, low-maintenance garden. The property has just been redecorated throughout and is ready for immediate occupation. Offered unfurnished.

Local authority: Westminster City Council  
Council Tax Band: D  
Deposit Required: 5 weeks

- Recently Refurbished
- Private Patio
- Wooden Flooring
- Two Bedrooms

### Viewing

Please contact our Intra Capital Estates Office on 0207 183 6676 if you wish to arrange a viewing appointment for this property or require further information.

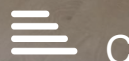



Floor Plan

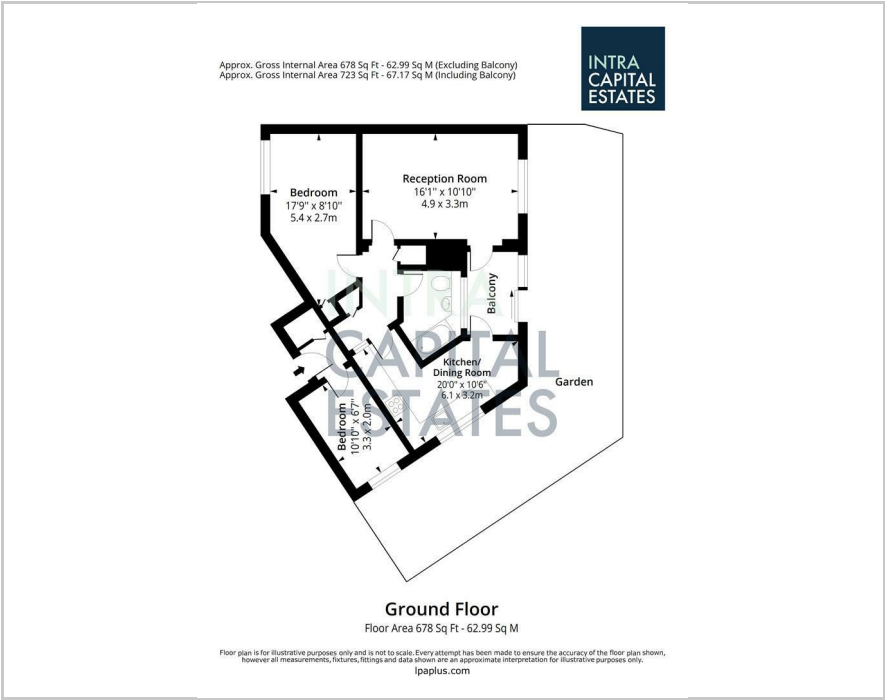

Area Map



Energy Efficiency Graph

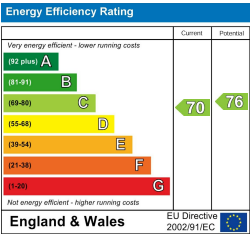

These particulars, whilst believed to be accurate are set out as a general outline only for guidance and do not constitute any part of an offer or contract. Intending purchasers should not rely on them as statements of representation of fact, but must satisfy themselves by inspection or otherwise as to their accuracy. No person in this firms employment has the authority to make or give any representation or warranty in respect of the property.

INTRA-CAPITAL ESTATES

Paddington Works, 8 Hermitage Street, London, W2 1BE  
Tel: 0207 183 6676 Email: info@intra-capital.co.uk  
www.intra-capital.co.uk

Intra-Capital Estates is a trading name of Intra Capital Estates Limited, a private limited company registered in England and Wales.  
Registered number: 11840427. VAT registration number: 31763281. Registered office Paddington Works, 8 Hermitage Street, London, W2 1BE.

MODERN APPROACH  
TRADITIONAL VALUES

