



Ashtons

Wrays Cottages, Huntington Road, York, YO31 9BZ

Wrays Cottages

Huntington Road, York
YO31 9BZ

£240,000



Located in the popular village setting of Huntington, to the north of York, is this charming Victorian cottage offering more space than first appears, along with a generous courtyard-style garden to the rear. Ideally placed for a range of local amenities including shops, eateries and regular bus connections into York city centre and the railway station, the property presents an excellent opportunity for first-time buyers or investors alike.

Internally, the property is entered via an entrance vestibule which leads through to the bright and welcoming living room positioned to the right, featuring a large window that allows natural light to flood the space. To the rear of the property is a fitted kitchen comprising a range of shaker-style wall and base units, providing ample storage and worktop space, along with room for a selection of freestanding appliances. Beyond the kitchen is a recently upgraded shower room finished with contemporary wall tiling and modern black fixtures and fittings, with a WC positioned to the rear and accessed via a secondary hallway.

To the first floor are two well-proportioned double bedrooms, both offering space for a range of freestanding furniture.

Externally, the property benefits from an enclosed courtyard-style garden to the rear, along with a deep storage cupboard ideal for bins or outdoor furniture. On-street parking is available immediately outside the property.

Offered with no onward chain, early viewing is highly recommended.

* Please note a selection of rooms have been dressed using AI for illustrative purposes.*





Wrays Cottages Huntington Road, York YO31 9BZ

Freehold
Council Tax Band - A

- Period Cottage
- Two Double Bedrooms
- Well Presented Throughout
- Enclosed Courtyard Style Garden
- Modern Kitchen & Bathroom
- Sought After Village Setting
- No Onward Chain
- EPC D

GROUND FLOOR
360 sq.ft. (33.4 sq.m.) approx.



TOTAL FLOOR AREA: 674 sq.ft. (62.6 sq.m.) approx.
Whilst every attempt has been made to ensure the accuracy of the floorplan, measurements of rooms and any other items are approximate. If included in the plan the garage/stores will form part of the overall floor area and no responsibility is taken for any error, omission or mis-statement. This plan is for illustrative purposes only and should be used as such by any prospective purchaser. The services, systems and appliances shown have not been tested and no guarantee as to their operability.
Made with Metropix ©2024

1ST FLOOR
314 sq.ft. (29.2 sq.m.) approx.

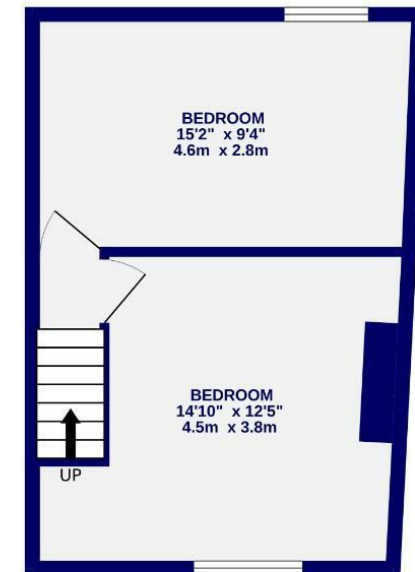

These particulars have been prepared as accurately and as reliably as possible, but should not be relied upon as 'statement of fact'. If there is any point which is of particular importance to you, please contact the office and we would be pleased to check the information. We have not tested any services, appliances, equipment or facilities and nothing in these particulars should be deemed to be a statement that they are in good working order, or that the property is in good structural condition or otherwise. Any areas, measurements, floor plans or distances referred to are given as a guide only and are not precise. Purchasers must satisfy themselves by inspection or by otherwise regarding the items mentioned above and as to the correctness of each of the statements contained in these particulars. No person in the employment of Ashtons has any authority to make or give any representation or warranty whatsoever in relation to this property or these particulars nor enter into any contract relating to the property on behalf of the vendor.