



26 Epping Close, Chadderton, Oldham, OL9 9ST

£399,950

🛏 4 🚿 3 🚗 4



- Extended Detached Property
- Four Spacious Bedrooms
- Three Reception Rooms
- Ideal Family Home
- Prime Location
- Great School Catchment Area
- Driveway Parking
- EPC Rating - C



Step inside this well-presented and deceptively spacious (over 1,400 sq/ft) extended Four-Bedroom Detached family property, ideally situated in the heart of the ever-popular Firwood Park development in Chadderton. Perfectly positioned on a quiet cul-de-sac, this property has been thoughtfully extended and upgraded providing a versatile layout ideal for growing families or those seeking extra space to work from home.

Conveniently located close to high-performing local schools, including Mills Hill Primary and The Radclyffe School, with excellent commuter links via the north-west motorway network and Mills Hill train station. As well as also providing easy access to local amenities, parks, shops, and Oldham town centre.



Don't Miss Out!

Home
located
the

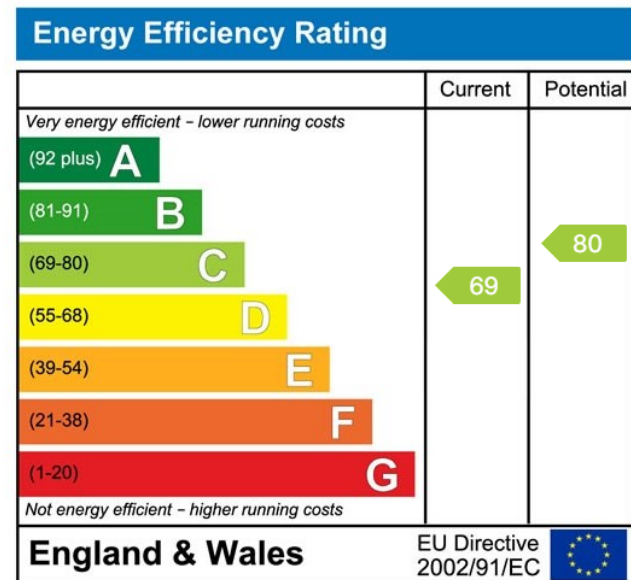
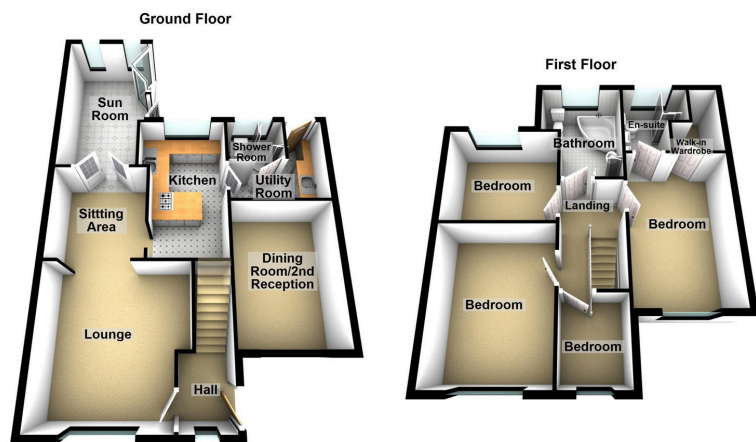

Chadderton Office

509 Middleton Road,
Chadderton, Oldham,
OL9 9SH

chadderton@kirkham-property.co.uk
t: 0161 626 5688