



5 Tilemakers Yard 2a Isis Street

, London, SW18 3QN

£3,900 Per month



This spacious three-bedroom, two-bathroom townhouse is set within a secure gated mews development on Isis Street, just moments from Earlsfield Station. Arranged over three floors and spanning over 1,080 sq. ft., the property includes a generous open-plan kitchen and living area, three well-proportioned bedrooms, two modern bathrooms, and a private patio. The home offers excellent natural light throughout and is ideally located for local shops, cafes, and transport links. Available unfurnished.

Council Tax Band - E

EPC - B

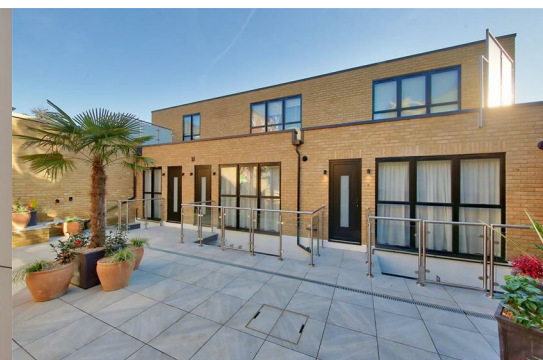

Area Map

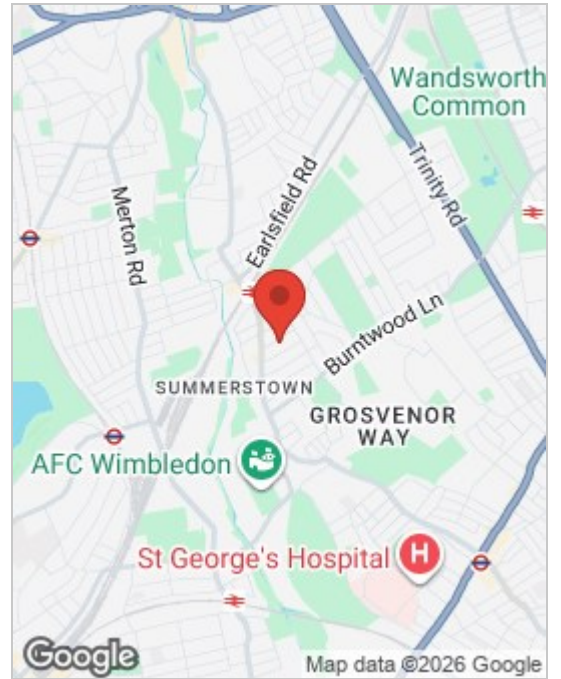

Floor Plan

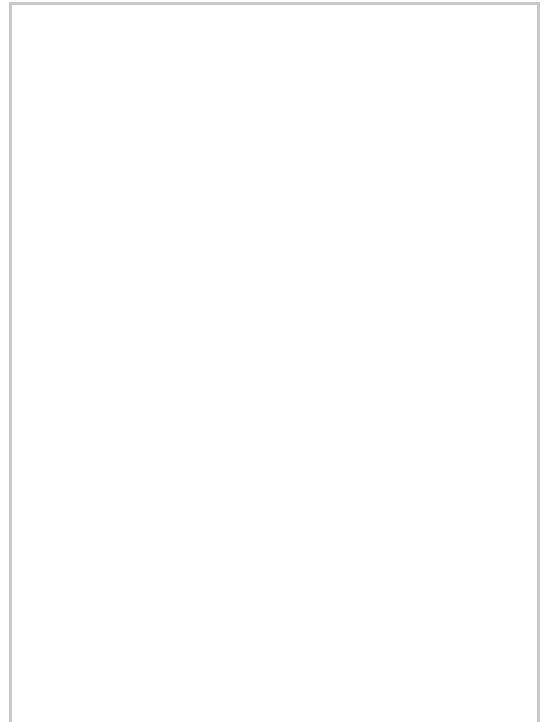

Energy Efficiency Graph

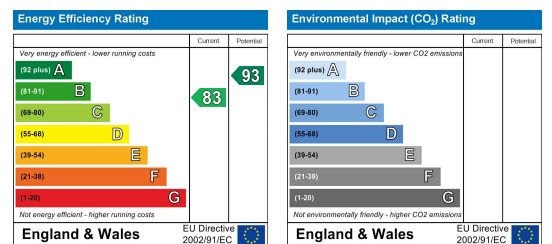

These particulars, whilst believed to be accurate are set out as a general outline only for guidance and do not constitute any part of an offer or contract. Intending purchasers should not rely on them as statements of representation of fact, but must satisfy themselves by inspection or otherwise as to their accuracy. No person in this firm's employment has the authority to make or give any representation or warranty in respect of the property.