

**SW19**

*it's all in the postcode...*



**Boundary Road**

**£465,000**

- Period flat
- Private south facing garden
- Sought after location
- Lovely condition
- Two bedrooms
- Council tax Band C
- EPC Rating D



020 8544 2828

Wimbledon: Wimbledon Park: Colliers Wood

[www.SW19.com](http://www.SW19.com)

SW19 Estate Agents Ltd. Is registered in England & Wales No. 05508737

*it's all in the postcode...*

Beautifully presented two-bedroom period conversion flat, ideally situated on a sought-after residential street within walking distance of Colliers Wood High Street and the Northern Line tube station. This charming home features a spacious kitchen/breakfast room with doors opening directly onto a delightful private south-facing garden, perfect for relaxing or entertaining. Finished to a high standard throughout, this fantastic flat offers a wonderful opportunity for buyers seeking a home they can move straight into and enjoy from day one.



020 8544 2828  
Wimbledon: Wimbledon Park: Colliers Wood  
[www.SW19.com](http://www.SW19.com)  
SW19 Estate Agents Ltd. Is registered in England & Wales No. 05508737

*'it's all in the postcode...'*

# Boundary Road SW19

Approx. Gross Internal Area 570 Sq Ft - 52.95 Sq M

Approx. Gross Reduced Height Under 1.5m Area 17 Sq Ft - 1.58 Sq M

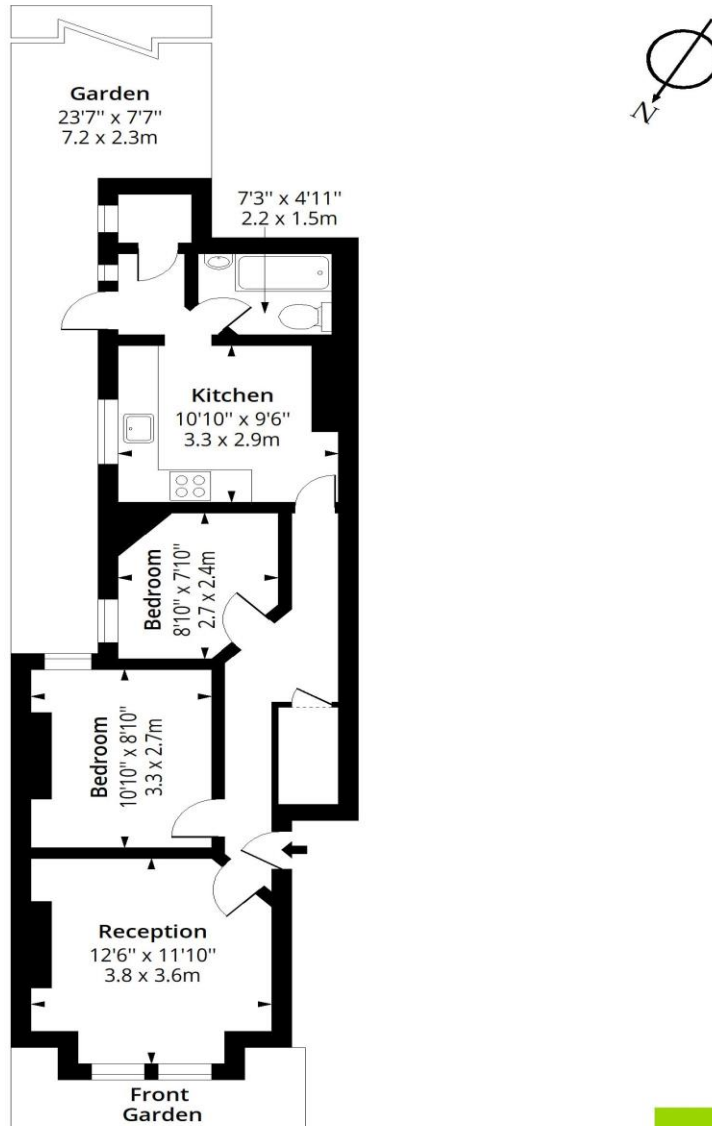

## Ground Floor

Floor Area 587 Sq Ft - 54.53 Sq M



Measured according to RICS IPMS2. Floor plan is for illustrative purposes only and is not to scale. Every attempt has been made to ensure the accuracy of the floor plan shown, however all measurements, fixtures, fittings and data shown are an approximate interpretation for illustrative purposes only. 1 sq m = 10.76 sq feet.

lpaplus.com

Date: 15/6/2026

These particulars are for guidance only and should not be relied upon as a statement or representation of fact. All measurements given are approximate only and should not be relied upon for ordering carpets, equipment etc. Purchasers should satisfy themselves by inspection or otherwise as to the accuracy of the statements contained within. Neither SW19 estate agents ltd or related companies or their employees can confirm structural conditions of the property or that any appliances or other facilities are in working order. Purchasers are strongly recommended to arrange their own survey.

020 8544 2828

Wimbledon: Wimbledon Park: Colliers Wood

www.SW19.com

SW19 Estate Agents Ltd. Is registered in England & Wales No. 05508737

*'it's all in the postcode...'*