

# Peter David

# Properties Ltd

Residential Sales and Lettings



## 15 Foxcroft Drive

Brighouse, HD6 3PQ

**£240,000**



# 15 Foxcroft Drive

Rastrick, Brighouse, HD6 3PQ

**£240,000**



Nestled in the tranquil setting of Foxcroft Drive, Brighouse, this charming semi-detached bungalow presents an excellent opportunity for those seeking a spacious and adaptable home. Boasting three well-proportioned bedrooms, this property is perfect for families or those looking to downsize without compromising on space.

The bungalow features a generous living room and dining area, creating an inviting atmosphere for both relaxation and entertaining. An adjoining conservatory offers a delightful space to enjoy the garden views, making it an ideal spot for morning coffee or afternoon reading. While the property is in need of modernisation, it provides a fantastic blank canvas for buyers to imprint their personal style and preferences.

Outside, the property benefits from a well-maintained garden, perfect for outdoor activities or simply enjoying the fresh air. Additionally, a garage and parking space ensure convenience and ease of access.

Situated at the end of a quiet cul-de-sac, this bungalow is ideally located close to local schools, making it a great choice for families. With its spacious layout and potential for enhancement, this property is a rare find in a desirable area. Don't miss the chance to make this bungalow your own and create a wonderful home in Brighouse.

## **Entrance Hallway**

The entrance hallway leads in from the side of the home providing access to the kitchen, living room, bedroom, bathroom and dining room. With laminate flooring and access to the loft hatch.

## **Kitchen**

Overlooking the front of the home, the kitchen has wooden base and wall units with ample worksurface and storage space. There is space for a fridge freezer, dishwasher and

washing machine. The oven and hob are integrated and a sink and drainer overlook the front garden.

## **Living Room**

A spacious living room overlooking the front of the home. A gas fireplace provides the focal point with coving and wall mounted lighting providing further points interest.

## **Dining Room**

With laminate flooring and a light blue colour scheme, the dining room is semi open plan to the conservatory allowing natural light to flood the space. The dining room also leads onto bedrooms two and three.

## **Bedroom One**

A well sized double bedroom to the rear aspect with fitted wardrobes and cabinets.

## **Bedroom Two**

With dual aspect windows to the side and rear of the home, this double bedroom has a lovely outlook.

## **Bedroom Three**

A well sized single bedroom to the rear of the home which would also work well as an office space.

## **Bathroom**

With a walk in shower, hand basin and w/c.

## **Conservatory**

Overlooking the side of the home with a private outlook, the conservatory has tiled flooring and an external door out to the side of the home.

## **Garage**

Ideal for additional parking and storage space with an electric door and power supply. .

## **External**

The property is situated at the end of a cul-de-sac behind a

driveway and front lawn. The garage is located to the side of the home with a footpath providing access to the side and rear garden which includes a patio area and a raised terrace with mature greenery providing a private space in which to relax.

### Directions

For Satnav please use the postcode HD6 3PQ

### Viewings

Viewings are strictly by appointment only. Please contact Peter David Properties.

### Mortgages

We recommend KB Mortgage Services, on hand to discuss all of your mortgage and protection needs. Kate, the founder of KB Mortgage Services, is available both in branch and through home visits - if you would like to arrange an appointment contact us today.

### DISCLAIMER

1. MONEY LAUNDERING REGULATIONS: Intending purchasers will be asked to produce identification documentation at a later stage and we would ask for your co-operation in order that there will be no delay in agreeing the sale.

2. General: While we endeavour to make our sales particulars fair, accurate and reliable, they are only a

general guide to the property and, accordingly, if there is any point which is of particular importance to you, please contact the office and we will be pleased to check the position for you, especially if you are contemplating travelling some distance to view the property.

3. Measurements: These approximate room sizes are only intended as general guidance. You must verify the dimensions carefully before ordering carpets or any built-in furniture.

4. Services: Please note we have not tested the services or any of the equipment or appliances in this property, accordingly we strongly advise prospective buyers to commission their own survey or service reports before finalising their offer to purchase.

5. THESE PARTICULARS ARE ISSUED IN GOOD FAITH BUT DO NOT CONSTITUTE REPRESENTATIONS OF FACT OR FORM PART OF ANY OFFER OR CONTRACT. THE MATTERS REFERRED TO IN THESE PARTICULARS SHOULD BE INDEPENDENTLY VERIFIED BY PROSPECTIVE BUYERS OR TENANTS. NEITHER PETER DAVID PROPERTIES NOR ANY OF ITS EMPLOYEES OR AGENTS HAS ANY AUTHORITY TO MAKE OR GIVE ANY REPRESENTATION OR WARRANTY WHATSOEVER IN RELATION TO THIS PROPERTY.



## Road Map



## Hybrid Map



## Terrain Map



## Floor Plan

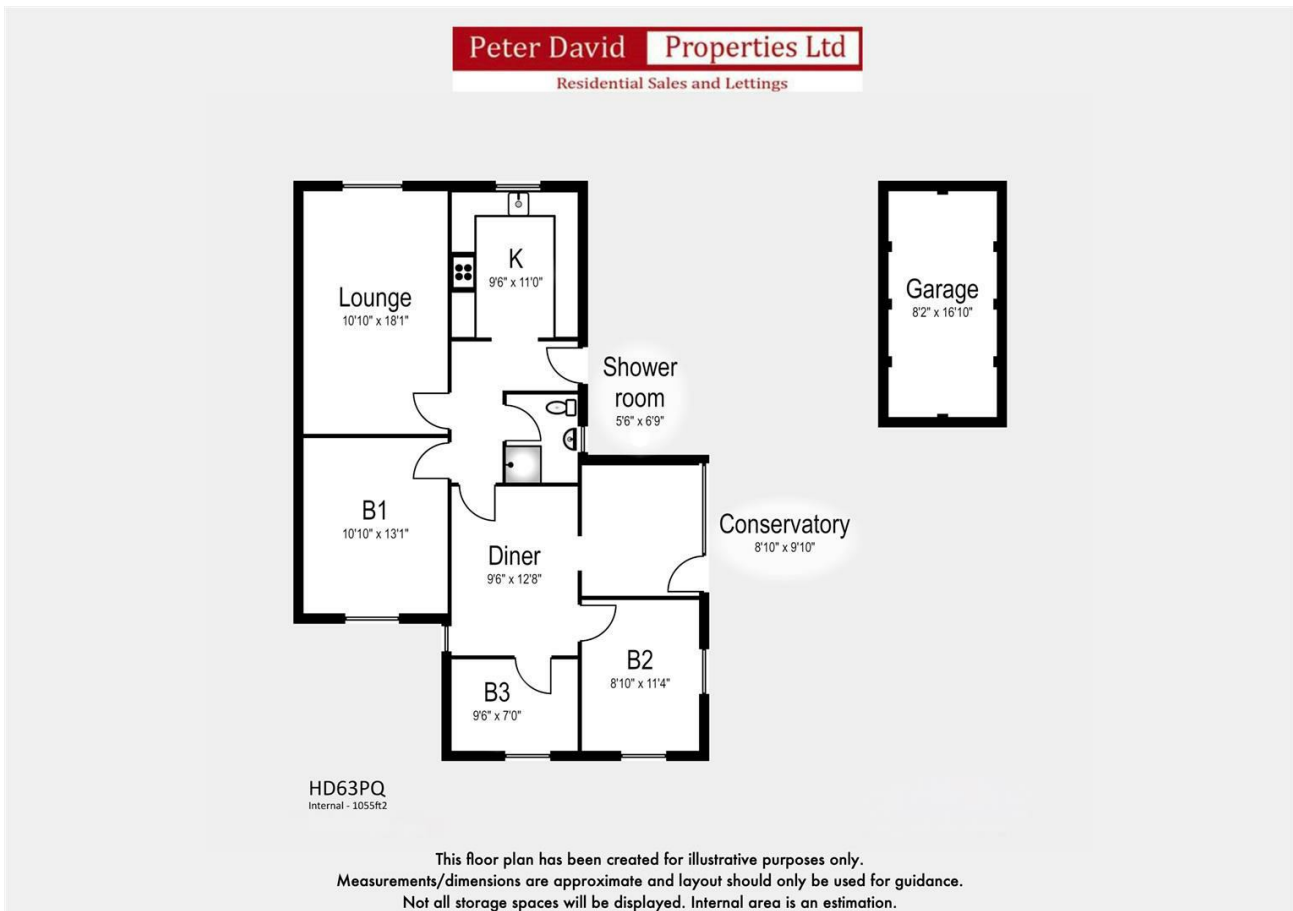

## Viewing

Please contact us on 01484 719191 if you wish to arrange a viewing appointment for this property or require further information.

## Energy Efficiency Graph

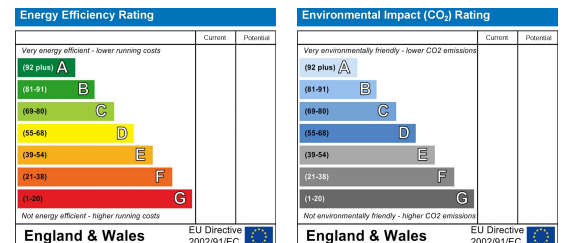

These particulars are for guidance only and do not constitute any part of a contract. No person within the company has the authority to make or give any representation or warranty in respect of the property. All measurements are approximate and for illustrative purposes only. None of the services and fittings or equipment have been tested. These particulars whilst believed to be accurate should not be relied on as statements of fact, and purchasers must satisfy themselves by inspection or otherwise as to their accuracy. Although these particulars are thought to be materially correct their accuracy cannot be guaranteed and they do not form part of any contract.