



Connells

Elsons Mews
Welwyn Garden City



Property Description

We are delighted to present this well proportioned four bedroom townhouse, ideally located in the sought-after Panshanger area.

Situated within Panshanger, the property offers easy access to Welwyn Garden City town centre, local shops and highly regarded schooling, making it a fantastic choice for families.

Arranged over three floors, the property offers flexible and spacious accommodation, making it an ideal family home. The ground floor comprises a welcoming entrance hall, a convenient downstairs cloakroom and a modern kitchen positioned across the rear of the property, providing a great space for family living and entertaining. The former integral garage has been converted to create an additional reception room, ideal for use as a home office, playroom or snug.

To the first floor, the property features a generous and bright principal bedroom complete with en-suite shower room, offering a private and comfortable retreat. There is also additional living space on this level, providing further versatility.

The second floor hosts three further well proportioned bedrooms along with a family bathroom, making it ideal for growing families.

Externally, the property benefits from off-road parking to the front and is conveniently located close to a range of local amenities, schools and transport links.



Kitchen

15' 3" x 10' 1" (4.65m x 3.07m)

Utility Room

7' 11" x 4' 1" (2.41m x 1.24m)

Study

12' 8" x 7' 10" (3.86m x 2.39m)

Lounge

17' x 15' 3" (5.18m x 4.65m)

Bedroom 1

10' 4" x 8' (3.15m x 2.44m)

En-Suite

7' x 5' 11" (2.13m x 1.80m)

Bedroom 2

15' 3" x 10' 4" (4.65m x 3.15m)

Bathroom

8' 3" x 6' 5" (2.51m x 1.96m)

Bedroom 3

10' 4" x 8' 3" (3.15m x 2.51m)

Bedroom 4

7' 7" x 6' 9" (2.31m x 2.06m)







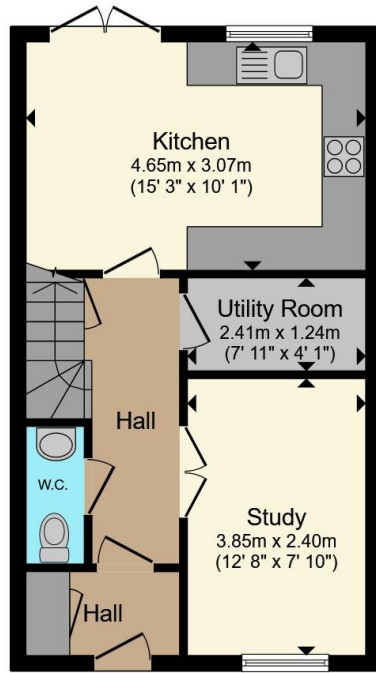

Ground Floor

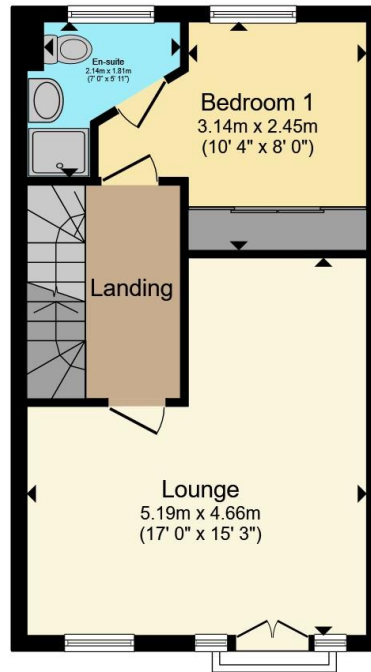

First Floor

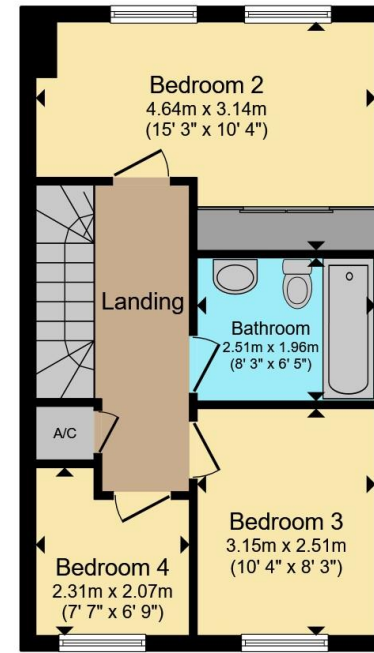

Second Floor

Total floor area 117.8 m² (1,268 sq.ft.) approx

This floor plan is for illustrative purposes only. It is not drawn to scale. Any measurements, floor areas (including any total floor area), openings and orientation are approximate. No details are guaranteed, they cannot be relied upon for any purpose and they do not form part of any agreement. No liability is taken for any error, omission or misstatement. A party must rely upon its own inspection(s). Powered by www.propertybox.io

Connells

To view this property please contact Connells on

T 01707 322 903
E welwyngardencity@connells.co.uk

38 Wigmores North
WELWYN GARDEN CITY AL8 6PH

EPC Rating: C Council Tax
Band: E

Tenure: Freehold

view this property online connells.co.uk/Property/WWY307533



1. MONEY LAUNDERING REGULATIONS Intending purchasers will be asked to produce identification documentation at a later stage and we would ask for your co-operation in order that there will be no delay in agreeing the sale. 2. These particulars do not constitute part or all of an offer or contract. 3. The measurements indicated are supplied for guidance only and as such must be considered incorrect. Potential buyers are advised to recheck measurements before committing to any expense. 4. We have not tested any apparatus, equipment, fixtures, fittings or services and it is in the buyers interest to check the working condition of any appliances.

Connells Residential is registered in England and Wales under company number 1489613, Registered Office is Cumbria House, 16-20 Hockliffe Street, Leighton Buzzard, Bedfordshire, LU7 1GN. VAT Registration Number is 500 2481 05.

See all our properties at www.connells.co.uk | www.rightmove.co.uk | www.zoopla.co.uk

Property Ref: WWY307533 - 0006