



## Hereford Road, W2

£4,500 Per calendar month

**Dexters**



## Hereford Road, W2

An immaculately presented well designed two double bedroom garden flat, situated on the sought-after, tree-lined Hereford Road in the heart of Notting Hill. The property boasts a stunning open-plan kitchen and reception room, offering exceptional living and entertaining space, with direct access to a private garden.

Hereford Road is one of Notting Hill's most sought-after tree-lined residential streets, ideally positioned moments from the boutiques, cafés and restaurants of Westbourne Grove, as well as the world-famous Portobello Road Market.

### Features

- Two Double Bedrooms
- Two Bathrooms
- Private Garden
- High Specification
- Professionally Managed



# Hereford Road, London, W2

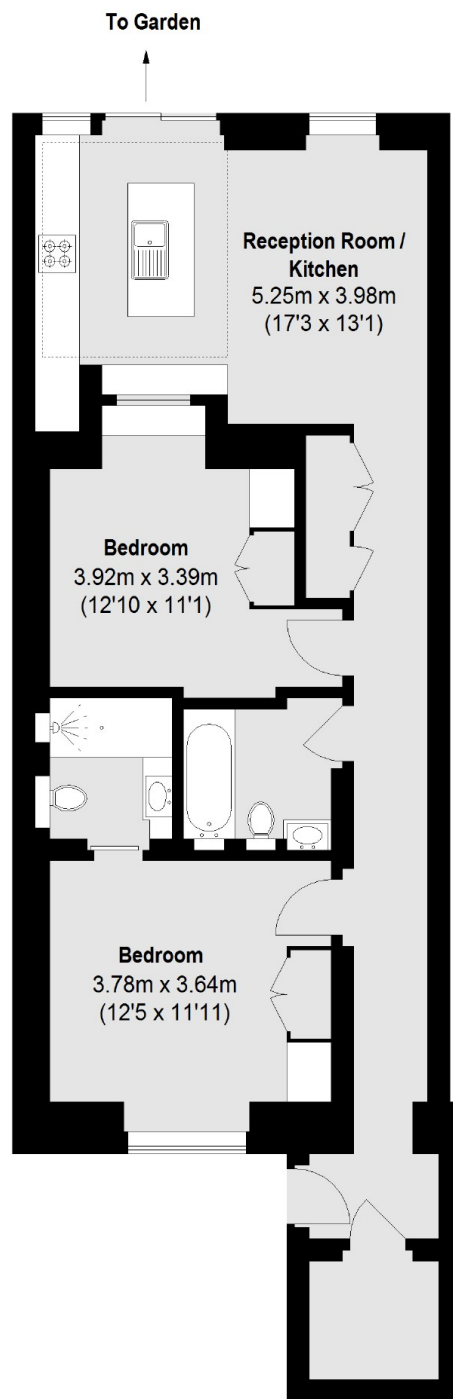

## Lower Ground Floor

Total area (approx.): 76.08 sq. m (819 Sq. ft)