



## Northumberland Street

Darlington DL3 7HB

£155,000



Venture  
PROPERTIES



This footer paragraph is an example only and should not be relied upon as complying with current legislation. These particulars, whilst believed to be accurate are set out as a general outline only for guidance and do not constitute any part of an offer or contract. Intending purchasers should not rely on them as statements of representation of fact, but must satisfy themselves by inspection or otherwise as to their accuracy. No person in this firm's employment has the authority to make or give any representation or warranty in respect of the property.

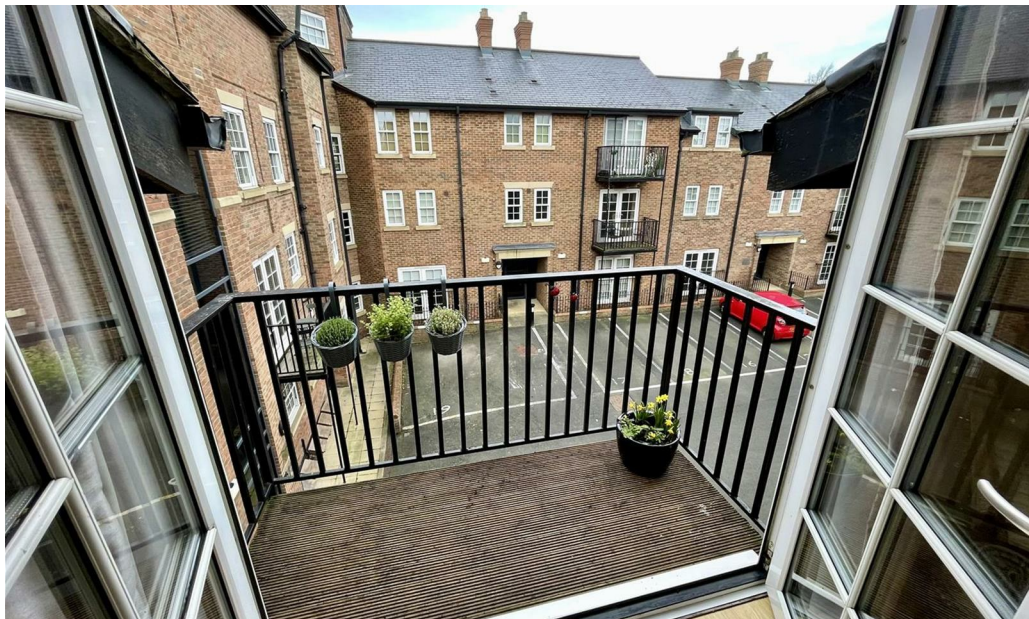

This footer paragraph is an example only and should not be relied upon as complying with current legislation. These particulars, whilst believed to be accurate are set out as a general outline only for guidance and do not constitute any part of an offer or contract. Intending purchasers should not rely on them as statements of representation of fact, but must satisfy themselves by inspection or otherwise as to their accuracy. No person in this firm's employment has the authority to make or give any representation or warranty in respect of the property.



# Northumberland Street

## Darlington DL3 7HB



- Two Bedroom Apartment
- Within Walking Distance to Town Centre
- Council Tax Band D

- West End/Town Centre Location in Darlington
- Close to Shops, Schools and Parks
- EPC Rating C

- Off Street Secure Parking
- Ideal First Time Buy
- En-Suite Shower Room

Welcome to this superb two-bedroom second floor apartment. Westpoint is located on Northumberland Street in the heart of Darlington, a delightful property, that offers a perfect blend of comfort and convenience. This apartment would be an ideal choice for both first-time buyers and those looking to downsize.

As you enter the apartment, you are greeted by a spacious, open access reception room, including lounge, dining areas and a well equipped kitchen. With a warm and inviting atmosphere, perfect for relaxing or entertaining guests, there is also a Juliet style balcony to enjoy which allows lots of natural light throughout the room.

The well-designed layout includes two generously sized bedrooms, one of which boasts an en-suite bathroom, ensuring privacy and comfort for its occupants. The additional bathroom is thoughtfully placed to serve guests and the second bedroom.

One of the standout features of this apartment is the secure allocated parking space, providing peace of mind and convenience for residents with vehicles. The property is situated within walking distance to the town centre, allowing easy access to a variety of shops, restaurants, and local amenities, making daily life both enjoyable and hassle-free.

This apartment truly must be seen to appreciate its charm and potential. With its modern features and prime location, it presents an excellent opportunity for those seeking a stylish and practical living space in Darlington. Don't miss your chance to make this lovely apartment your new home.

### Entrance Hall

Door to front and access to all rooms.

### Lounge/Kitchen/Diner

24'6 x 15'8 (7.47m x 4.78m)

Open aspect living space. To the rear of the property there are double doors to a Juliet style balcony in the lounge area, coving and spotlights to ceiling with two radiators.

There is space for a large table and chairs to the dining area.

The kitchen area is fitted with wall, base, drawer units and contrasting worktops,

including integrated wine rack feature. One and a half bowl stainless steel sink with mixer taps, four ring gas hob with extractor over and oven. Integrated appliances. With laminate flooring and spotlights to ceiling across the open living space. There are two sash windows to the front.

### Bedroom One

12'9 x 11'8 (3.89m x 3.56m)

Sash window to rear, coving to ceiling and access to en-suite shower room. Spotlights to ceiling and laminate flooring.

### En-Suite

Obscure Sash window to rear, walk in shower cubicle with wash hand basin and back to wall w.c. Part tiled walls and tiled floor with spotlights to ceiling.

### Bedroom Two

15'8 x 11'3 (4.78m x 3.43m)

Sash window to front with additional rooflight window. Fitted double storage cupboard, spotlights to ceiling and laminate flooring.

### Bathroom

Two rooflight windows to rear, panelled bath with shower over and screen. Back to wall w.c and wash hand basin in vanity unit. Part tiled walls, tiled floor and spotlights to ceiling.

### Externally

There is secure allocated parking for one vehicle.

### Tenure

Leasehold

### Property Details

Local Authority: Darlington

Council Tax Band: D

Annual Price: £2,372

Conservation Area Darlington Town Centre

Flood Risk Very low

Floor Area 0 ft 2 / 0 m 2

Plot size 0.03 acres  
Mobile coverage

EE  
Vodafone  
Three  
O2  
Broadband

Basic  
17 Mbps  
Superfast  
80 Mbps  
Satellite / Fibre TV Availability

BT  
Sky

### Note

IMPORTANT NOTE TO PURCHASERS: We endeavour to make our sales particulars accurate and reliable, however, they do not constitute or form part of an offer or any contract and none is to be relied upon as statements of representation or fact. The services, systems and appliances listed in this specification have not been tested by us and no guarantee as to their operating ability or efficiency is given. All measurements have been taken as a guide to prospective buyers only, and are not precise. Floor plans where included are not to scale and accuracy is not guaranteed. If you require clarification or further information on any points, please contact us, especially if you are travelling some distance to view. Fixtures and fittings other than those mentioned are to be agreed with the seller. We cannot also confirm at this stage of marketing the tenure of this house.

## GROUND FLOOR

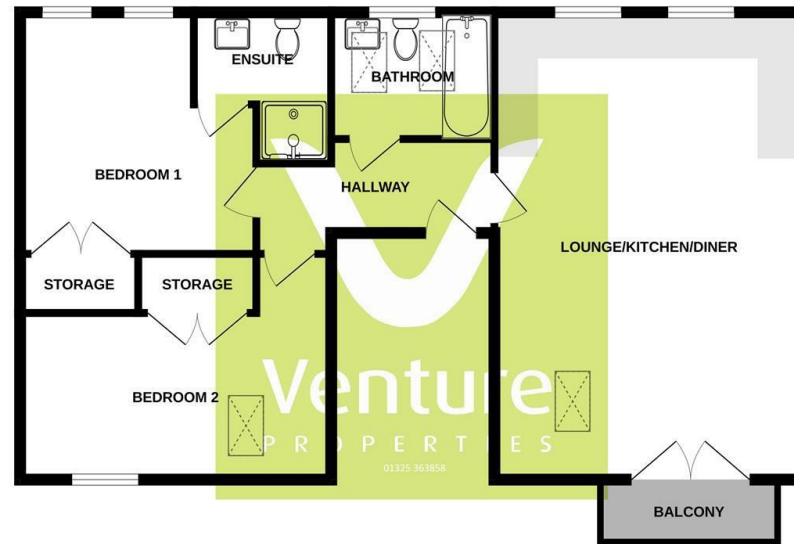

Whilst every attempt has been made to ensure the accuracy of the floorplan contained herein, measurements of doors, windows, rooms and any other items are approximate and no responsibility is taken for any error, omission or mis-statement. This plan is for illustrative purposes only and should be used as such by any prospective purchaser. The services, systems and appliances shown have not been tested and no guarantee as to their operability or efficiency can be given.  
Made with Metrepro ©2020.

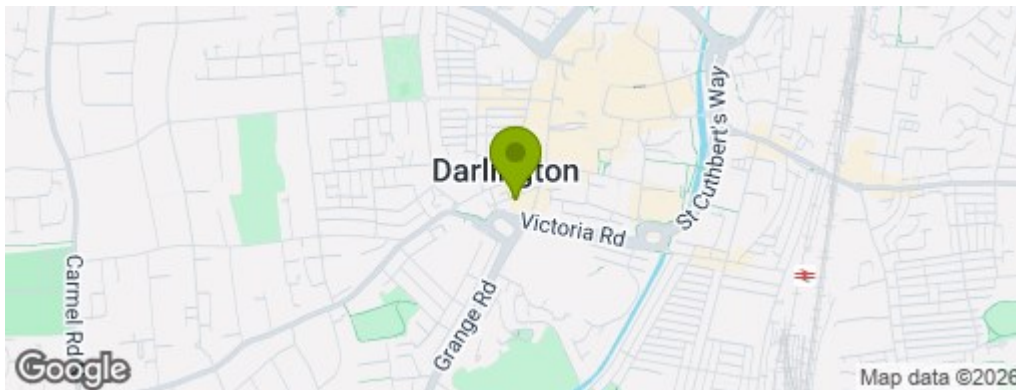

## Property Information

**01325 363858**

45 Duke Street, Darlington, County Durham, DL3 7SD  
sales@venturepropertiesuk.com