

GUIDE PRICE

**£700,000**

**Alexandra Crescent**

, BR1 4EU



EPC RATING: D COUNCIL TAX BAND: F

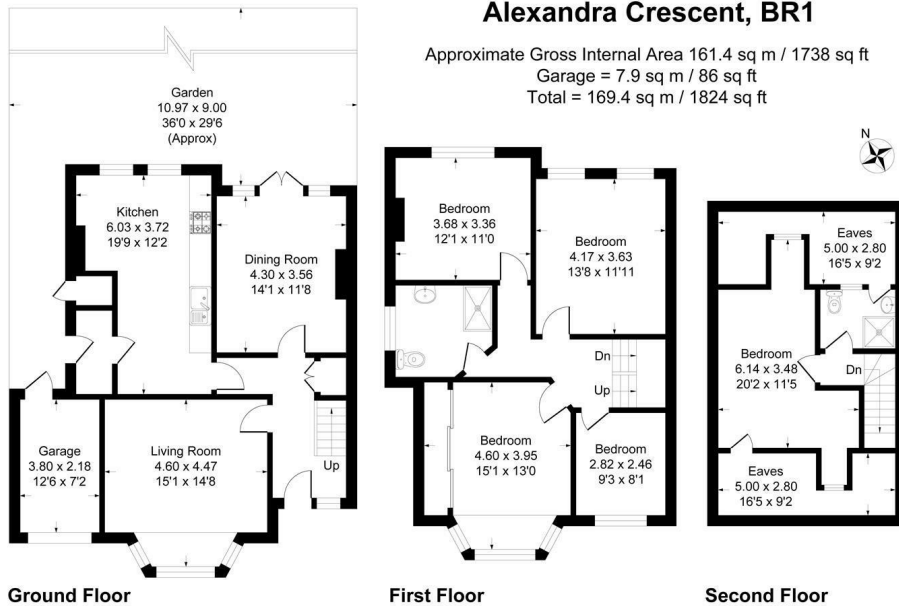

**Alexandra Crescent, BR1**

Approximate Gross Internal Area 161.4 sq m / 1738 sq ft  
 Garage = 7.9 sq m / 86 sq ft  
 Total = 169.4 sq m / 1824 sq ft

This plan is for layout guidance only. Not drawn to scale unless stated. Windows and door openings are approximate. Whilst every care is taken in the preparation of this plan, please check all dimensions, shapes and compass bearings before making any decisions reliant upon them.  
 Produced By Planpix



Energy Efficiency Rating		Current	Potential
Very energy efficient - lower running costs			
(92 plus)	A		81
(81-91)	B		
(69-80)	C		
(55-68)	D	62	
(39-54)	E		
(21-38)	F		
(1-20)	G		
Not energy efficient - higher running costs			
England & Wales		EU Directive 2002/91/EC	

Agents Note: Whilst every care has been taken to prepare these particulars, they are for guidance purposes only. All measurements are approximate and are for general guidance purposes only and whilst every care has been taken to ensure their accuracy, they should not be relied upon and potential buyers/tenants are advised to recheck the measurements



**OFFICE ADDRESS**

23 High Street  
 Bromley  
 Kent  
 BR1 1LG

**OFFICE DETAILS**

0208 464 5566  
 info@sinclairhammelton.co.uk