



Newcombe Court Burgess Springs, CHELMSFORD CM1 1QN



welcome to

Newcombe Court Burgess Springs, CHELMSFORD

Positioned within the highly desirable Newcombe Court development at Burgess Springs, this stylish first-floor apartment offers an excellent opportunity for both first-time buyers and investors alike. The property is also available to purchase through a shared ownership scheme, starting from a 25%.

Entrance Hall

Bathroom

7' 1" x 6' 3" (2.16m x 1.91m)

Kitchen / Lounge / Diner

23' 11" x 11' 3" (7.29m x 3.43m)

Bedroom

12' 6" x 6' 7" (3.81m x 2.01m)

Agents Note:

Lease: 125 years from 10 October 2018

Current ground rent £100 pa

Current service charge £3065.76 pa

Rent £544.13 per month

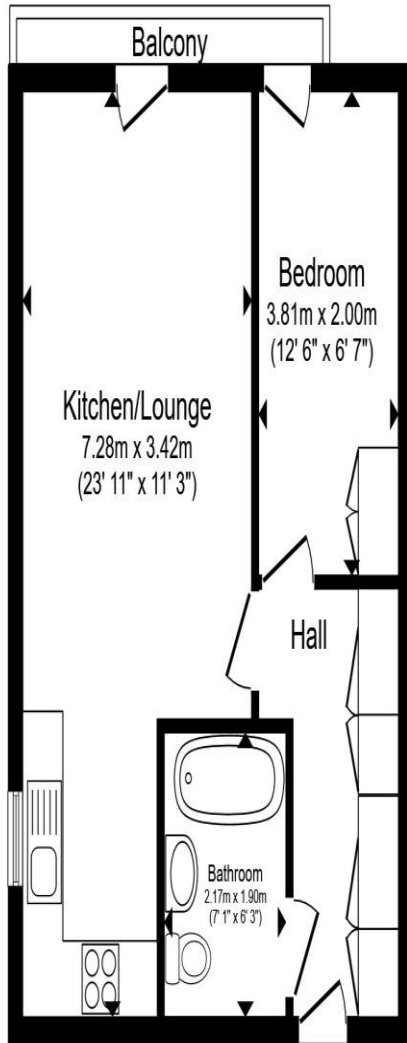

Total floor area 40.8 m² (440 sq.ft.) approx

This floor plan is for illustrative purposes only. It is not drawn to scale. Any measurements, floor areas (including any total floor area), openings and orientation are approximate. No details are guaranteed, they cannot be relied upon for any purpose and they do not form part of any agreement. No liability is taken for any error, omission or misstatement. A party must rely upon its own inspection(s). Powered by www.propertybox.io



welcome to

Newcombe Court Burgess Springs, CHELMSFORD

- 25% shared ownership – ideal first-time buyer opportunity
- Situated in the sought-after Newcombe Court development at Burgess Springs
- Short walk to Chelmsford Train Station – direct links to London Liverpool Street
- Easy access to Chelmsford city centre, shops, restaurants and amenities
- 24-hour concierge service, providing added security and peace of mind

Tenure: Leasehold EPC Rating: B

Council Tax Band: C Service Charge: 3027.24

Ground Rent: 100.00

This is a Leasehold property with details as follows; Term of Lease 125 years from 10 Oct 2018. Should you require further information please contact the branch. Please Note additional fees could be incurred for items such as Leasehold packs.

shared ownership



view this property online williamhbrown.co.uk/Property/CHE116151



Property Ref:
CHE116151 - 0005

1. MONEY LAUNDERING REGULATIONS Intending purchasers will be asked to produce identification documentation at a later stage and we would ask for your co-operation in order that there is no delay in agreeing the sale. 2. These particulars do not constitute part or all of an offer or contract. 3. The measurements indicated are supplied for guidance only and as such must be considered incorrect. Potential buyers are advised to recheck measurements before committing to any expense. 4. We have not tested any apparatus, equipment, fixtures or services and it is in the buyers interest to check the working condition of any appliances. 5. Where an EPC, or a Home Report (Scotland only) is held for this property, it is available for inspection at the branch by appointment. If you require a printed version of a Home Report, you will need to pay a reasonable production charge reflecting printing and other costs. 6. We are not able to offer an opinion either written or verbal on the content of these reports and this must be obtained from your legal representative. 7. Whilst we take care in preparing these reports, a buyer should ensure that his/her legal representative confirms as soon as possible all matters relating to title including the extent and boundaries of the property and other important matters before exchange of contracts.

William H Brown is a trading name of Sequence (UK) Limited which is registered in England and Wales under company number 4268443, Registered Office is Cumbria House, 16-20 Hockliffe Street, Leighton Buzzard, Bedfordshire, LU7 1GN. VAT Registration Number is 500 2481 05.



william h brown



01245 262266



Chelmsford@williamhbrown.co.uk



12 Duke Street, CHELMSFORD, Essex, CM1 1HL



williamhbrown.co.uk