



Angoods Lane, Chatteris, PE16 6RG

Nicely Presented - End Terraced House - 2 Double Bedrooms - Kitchen & Lounge/Diner - Ground Floor WC - First Floor Bathroom - Enclosed Rear Garden - Allocated Parking - No Upward Chain - Call To View (01354) 696700

£195,000



Ground Floor

Hall

Entrance door, fitted carpet, radiator, stairs to first floor and door to:

Kitchen

2.87m (9'5") x 1.83m (6') max
Fitted with a matching range of base and eye level units with worktop space over, stainless steel sink, plumbing for washing machine, space for fridge/freezer and cooker with extractor hood over and double-glazed window to front.

Lounge/Diner

4.90m (16'1") x 3.75m (12'4") max
Double glazed sliding door to rear, fitted carpet, storage cupboard and radiator.

WC

Fitted two-piece suite comprising low level WC, wash hand basin, part tiled walls, vinyl flooring, radiator and double-glazed window to side.

First Floor

Landing

Double glazed window to side, radiator, fitted carpet and door to:

Bedroom 1

3.75m (12'4") x 2.80m (9'2")
Double glazed window to rear, fitted carpet and radiator.

Bedroom 2

3.76m (12'4") x 2.88m (9'5") max
Two double glazed windows to front, boiler cupboard, fitted carpet and radiator.

Bathroom

Fitted with three-piece suite comprising jacuzzi bath, vanity wash hand basin and WC, tiled walls, heated towel rail and vinyl flooring.

Outside

The property has allocated parking to the front and side gate access into the enclosed rear garden which comprises of a patio area, lawn and a pathway leading to a shed.

EPC - TBC

Ground Floor

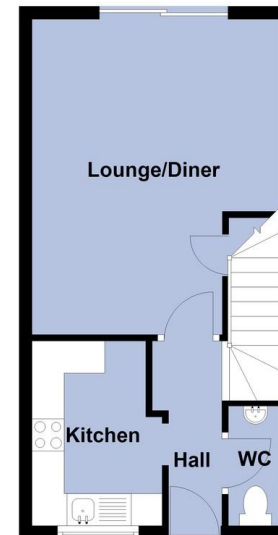

First Floor

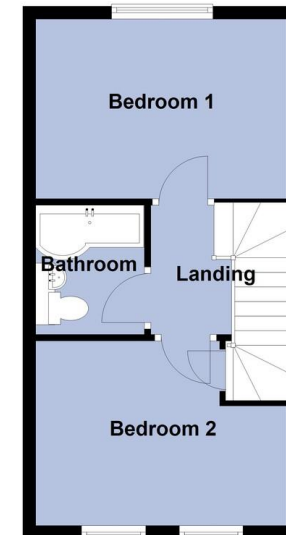

Call to arrange a viewing **01354 696700**

T Payne & Co
SALES & LETTINGS

Agents Notes: Whilst every care has been taken to prepare these sales particulars, they are for guidance purposes only. All measurements are approximate and for general guidance purposes only and whilst every care has been taken to ensure their accuracy, they should not be relied upon and potential buyers are advised to recheck the measurements.

