



Ulllyotts
Estate Agents

Flat 4, 14-16 Summerfield Road
Bridlington

YO15 3LF

GUIDE PRICE

£72,500

1 Bedroom Ground Floor Apartment

Est. 1891
Ulllyotts
Estate Agents

01262 401401

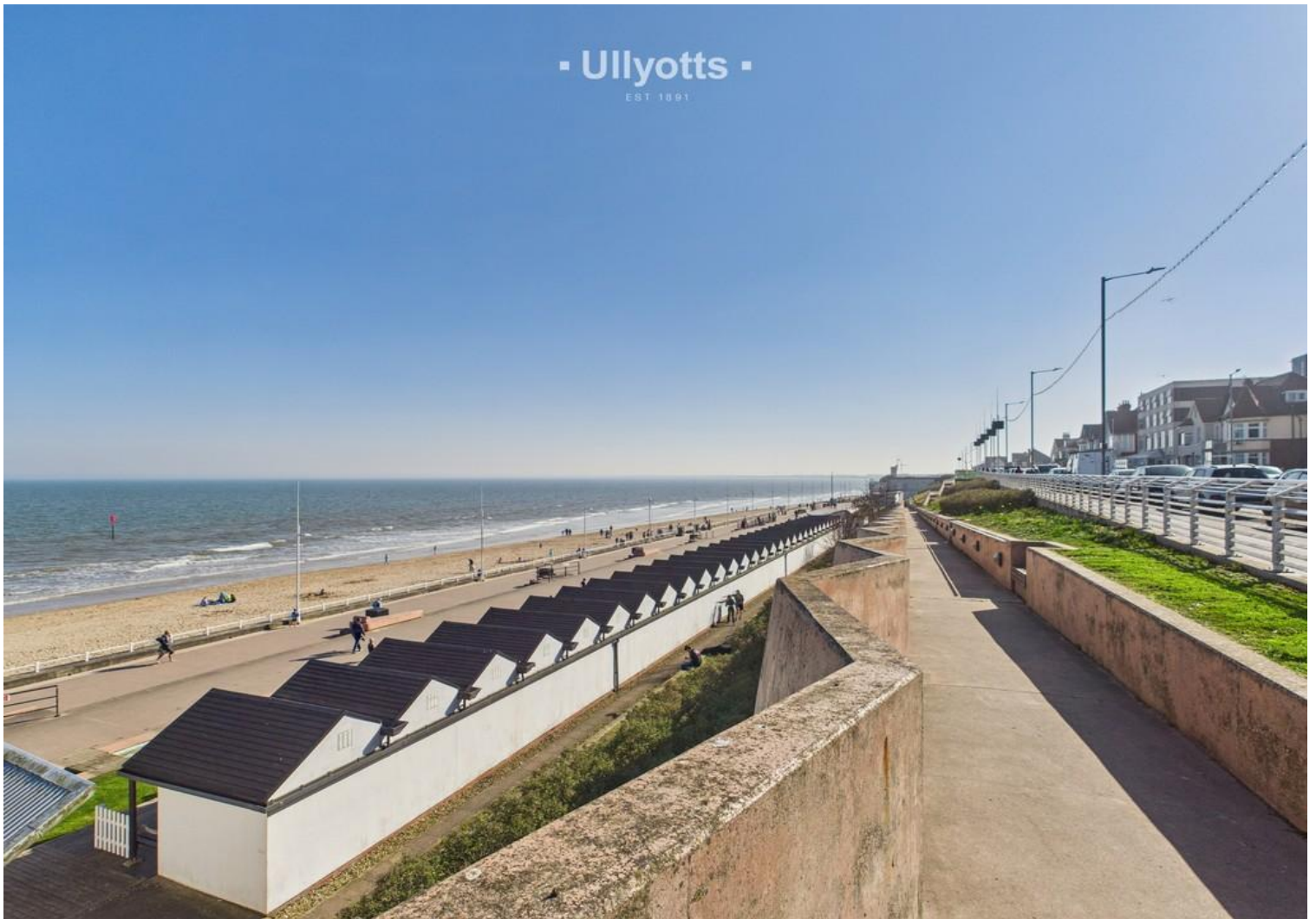

Nearby Sea Front



1



1



1



On Road
Parking



Gas Central Heating

Flat 4, 14-16 Summerfield Road, Bridlington, YO15 3LF

Situated on the ground floor to the rear of the main block of Marine Point Apartments, this self-contained one-bedroom apartment benefits from its own private entrance and offers well-presented accommodation throughout. The property features a good-sized lounge with a kitchen, one bedroom, and a modern shower room. Externally, there is access to a communal yard providing outdoor seating space. Ideally located just minutes from Southside Beach and the seafront, the apartment is also offered to the market with no onward chain, making it an excellent first-time purchase or investment opportunity.

Summerfield Road enjoys a prime southside position in Bridlington, just steps from the expansive sandy beach and attractive seafront promenade. The area offers an appealing mix of coastal leisure and convenience, with

Bridlington Spa, Gecco's, Yips, and the Old Lifeboat Station-now a popular destination for food and coffee-all within proximity. Richie's Café Bar sits directly on the beach, perfect for relaxed seaside refreshments, while Belvedere Golf Club and easy access to the town centre further enhance this well-connected and vibrant coastal setting.

Bridlington itself is a vibrant coastal town, renowned for its bustling harbour, sweeping beaches, and relaxed seaside atmosphere. Celebrated as the lobster capital of Europe, it boasts a strong food scene alongside independent shops, cafés, and a charming Old Town. With regular rail services and excellent road links, it offers easy access to nearby towns, cities, and the wider Yorkshire coast, making it a highly desirable location for coastal living.



Lounge



Lounge



Kitchen



Virtually Staged Kitchen

Accommodation

ENTRANCE

Entrance to the property is via a sliding uPVC door, opening directly into the lounge area.

LOUNGE

14' 6" x 12' 0" (4.44m x 3.68m)

The lounge benefits from natural light flowing through the sliding uPVC doors to the front elevation. The room features oak-style flooring and an electric wall heater, with doors providing access to all further rooms.

KITCHEN

7' 6" x 7' 3" (2.29m x 2.23m)

The kitchen benefits from a range of white gloss, soft-close wall, base and drawer units, complemented by a contrasting worktop with matching splashback and vinyl flooring. Fitted appliances include an electric oven, hob with stainless steel splashback, and a fitted extractor fan above. There is space for a washing machine and an under-counter fridge, along with a window to the front elevation providing natural light.

BEDROOM

14' 3" x 8' 10" (4.36m x 2.71m)

The bedroom benefits from a window to the front elevation and finished with an electric wall heater for added comfort.

SHOWER ROOM

5' 11" x 5' 2" (1.81m x 1.60m)

The shower room is fitted with wet wall panelling and wood-effect laminate flooring, offering a modern and low-maintenance finish. The suite comprises a wash hand basin, WC, and a corner shower unit with sliding doors and a double-head thermostatic shower over. A wall-mounted mirror adds practicality, while a useful cupboard houses the hot water tank.

CENTRAL HEATING

Gas fired central heating to radiators. The boiler also provides domestic hot water.

DOUBLE GLAZING

UPVC double glazing throughout.



Bedroom



Virtually Staged Bedroom

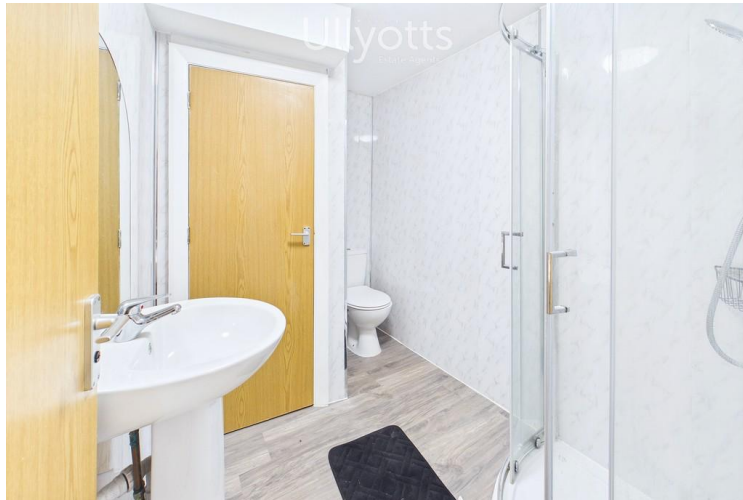

Shower Room



Communal Patio

OUTSIDE

A communal patio area provides an outdoor seating space, ideal for relaxing and enjoying the sun.

TENURE

The property is held on a 999-year lease from 1 June 2005. The freehold is owned by Marine Court Bridlington Limited, with each flat owner holding a share in the company.

SERVICES

All mains services are available at the property.

COUNCIL TAX BAND - B

ENERGY PERFORMANCE CERTIFICATE - RATED D

NOTE

Heating systems and other services have not been checked.

All measurements are provided for guidance only.

None of the statements contained in these particulars as to this property are to be relied upon as statements or representations of fact. In the event of a property being extended or altered from its original form, buyers must satisfy themselves that any planning regulation was adhered to as this information is seldom available to the agent.

Floor plans are for illustrative purposes only.

VIEWING

Strictly by appointment with Ulyotts 01262 401401 - Option 1.

Regulated by RICS



Marine Court Sign



Nearby Sea Front

The digitally calculated floor area is 39 sq m (420 sq ft). This area may differ from the floor area on the Energy Performance Certificate.

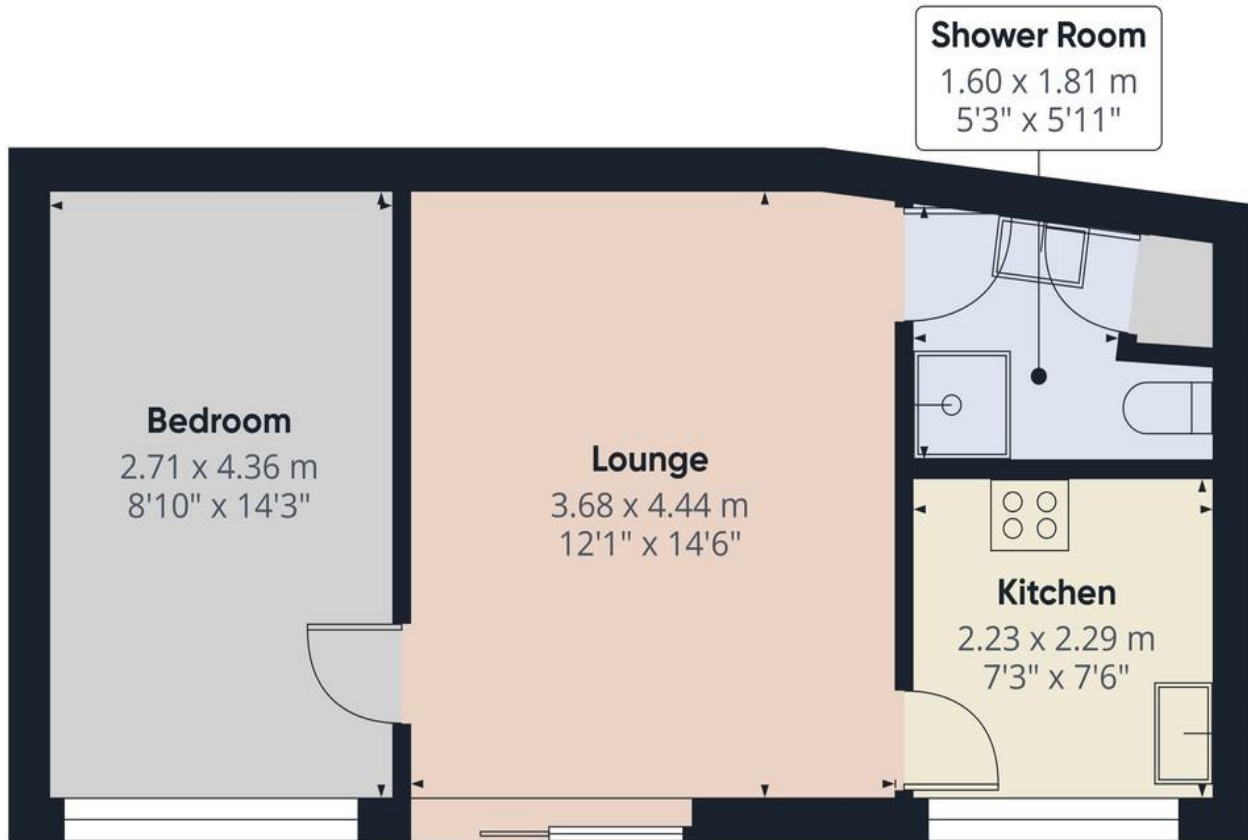

Approximate total area⁽¹⁾

38.4 m²
414 ft²

(1) Excluding balconies and terraces

Calculations reference the RICS IPMS 3C standard. Measurements are approximate and not to scale. This floor plan is intended for illustration only.

GIRAFFE360





Flat 4 Marine Court,14-16 Summerfield Road

▪ Est. 1891 ▪
Ullyotts
Estate Agents



16 Prospect Street,
Bridlington, YO15 2AL

Telephone 01262 401401

Email sales@ullyottsbrid.co.uk

64 Middle Street South,
Driffield, YO25 6QG

Telephone 01377 253456

Email sales@ullyotts.co.uk

www.ullyotts.co.uk



- Residential Sales
- Property Management
- Valuations

