



Pittis

Price

£925 PCM

Fees Apply



Available 27/06/26

Fort Street Sandown
PO36

Pittis
Helping you move forwards



Main Features

Open House 9th June

Courtyard Garden

Two Beds

Loft Room

Close To Town

Close To Beach



Deposit required is £1,067.31
Isle of Wight - Council Tax Band Tax Band B

Renting a property is a big commitment and we recommend that you visit the local authority website and these websites which offer helpful information and advice about letting

www.gov.uk/government/publications/how-to-rent

www.gov.uk/private-renting

www.pittis.co.uk/renting/tenancy-fees-individuals/

www.gov.uk/green-deal-energy-saving-measures

Call Ryde 01983 563785 ■ pittis.co.uk

IMPORTANT INFORMATION: Please contact our Lettings Team who will confirm the total costs involved in renting this property. For clarification, we wish to inform the prospective tenant that we have prepared these details as a general guide. The agent has not carried out a detailed survey nor tested the services, appliances, or specific fittings (unless otherwise stated), and no warranty can be given as to their condition. All room measurements are taken at floor level. We strongly recommend that all the information which we provide about the property is verified by yourself and your advisers. The contents of this publication are © Pittis, 2015. Pittis is a trading name of Arun Estates Limited Registered in England No. 2597969

Accommodation

Lounge 3.5m x 3.3m

Dining Room 2.5m x 2.8m

Kitchen 2m x 1.3m

Bathroom 2m x 1.6m

Toilet 2m x 0.9m

Upstairs Too-

Bedroom One 3.6m x 3.1m

Bedroom Two 3.1m x 3.2m

Upstairs To Loft Room

Courtyard Garden

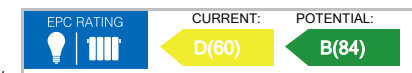

Ground Floor

Approx. 23.8 sq. metres (256.0 sq. feet)

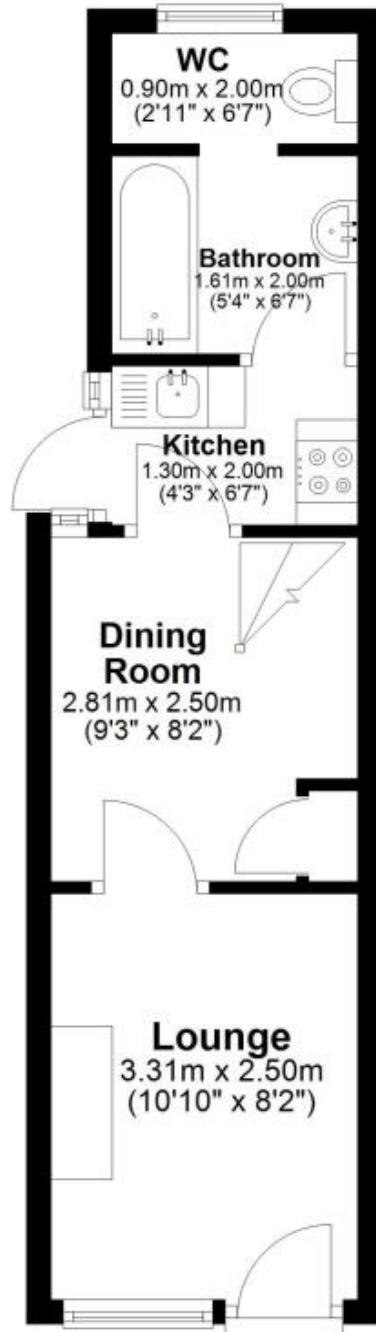

First Floor

Approx. 15.5 sq. metres (167.3 sq. feet)

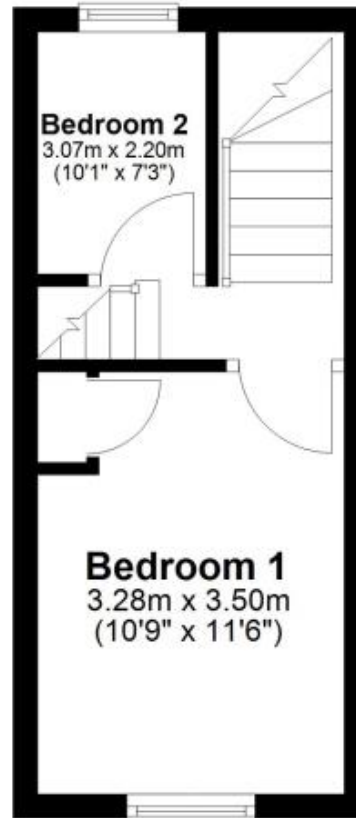

Second Floor

Approx. 6.3 sq. metres (68.3 sq. feet)

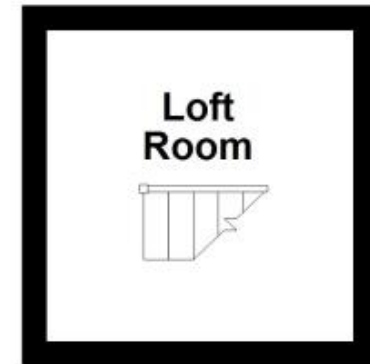

Total area: approx. 45.7 sq. metres (491.6 sq. feet)