

Stags Head Farm Bubbenhall
Guide Price £1,150,000

charlesrose.

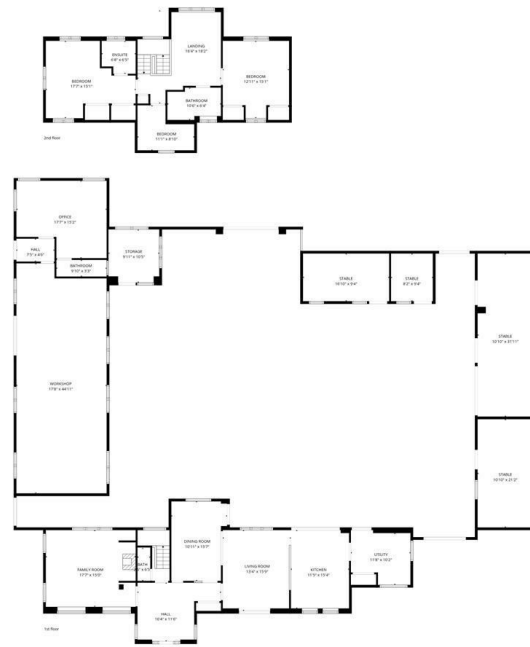

TOTAL: 4060 sq. ft
1st floor: 3190 sq. ft, 2nd floor: 870 sq. ft
EXCLUDED AREAS: "": 2 sq. ft, WALLS: 372 sq. ft

Measurements are calculated accurately but are not guaranteed.



A distinctive timber-framed country home set within just shy of four acres of landscaped grounds, approached via a long sweeping gravel driveway and extensively renovated in recent years. Originally constructed in 1981 to reflect the character of a traditional barn conversion, the property combines vaulted living spaces, exposed beams and beautifully refined interiors with exceptional versatility. Features include a striking vaulted kitchen/dining room, private rear courtyard, substantial workshops and outbuildings, extensive parking, three-phase electricity supply and a separate paddock with potential for equestrian use. Well suited to both lifestyle and business requirements, with dedicated work access and space for approximately 40 vehicles.

charlesrose.

- 01926 832411
- hello@charlesrose.co.uk
- charlesrose.co.uk

