

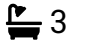



Property Webb
At the HEART of your move

Reid Crescent, Wester Inch, Bathgate, EH48 2TY

Offers Over £360,000

 4  3  2



Occupying an established position within the ever-popular Wester Inch development, this immaculately presented 4 bedroom detached home offers generous family accommodation, beautifully balanced living spaces and a landscaped garden designed for modern day living. Thoughtfully maintained throughout, it is a home that combines practicality with warmth, creating an inviting environment for families looking to settle into a well-connected community.

 01506 637553

 info@property-webb.co.uk

 www.property-webb.co.uk

 71 South Bridge St, Bathgate, EH48 1TJ



Property Webb
At the HEART of your move

- Detached family home
- Immaculately presented
- Bright lounge
- Large modern Kitchen/dining room
- Garden Room
- 4 double bedrooms
- Family bathroom & En-suite
- Landscaped garden
- Double driveway & garage
- Perfect family home

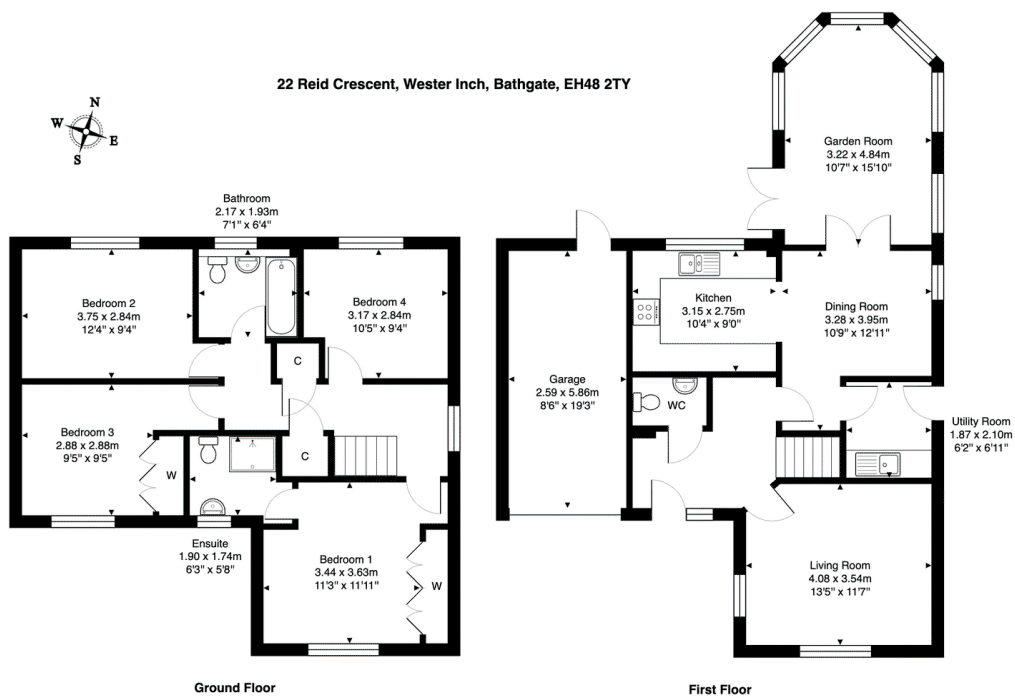

Total Area: 130.9 m² ... 1409 ft² (excluding garage)
All measurements are approximate and for display purposes only.

01506 637553

info@property-webb-co.uk

www.property-webb.co.uk



71 South Bridge St, Bathgate, EH48 1TJ