



FOR SALE

3 Bed Mid Terraced House in Keyham Lane West, Leicester, LE5 1RS
Offers Over £210,000

A fantastic opportunity to acquire this three-bedroom mid-terrace home in the ever-popular LE5 area — perfect for first-time buyers or savvy investors alike. Offering great potential, the property would benefit from some cosmetic updating, allowing you to add your own style and value. Inside, you'll find a generous lounge/diner ideal for both relaxing and entertaining, along with a fitted kitchen, three good-sized bedrooms, and a family bathroom. Outside, there are front and rear gardens, providing useful outdoor space. Ideally situated within walking distance of local amenities, reputable schools, and excellent transport links, this home combines convenience with exciting potential. Offered to the market with NO ONWARD CHAIN, this is an excellent opportunity not to be missed!



GROUND FLOOR
390 sq ft. (35.5 sq m.) approx.

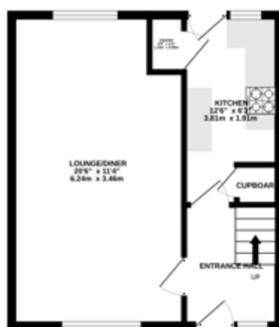

1ST FLOOR
410 sq ft. (38.1 sq m.) approx.

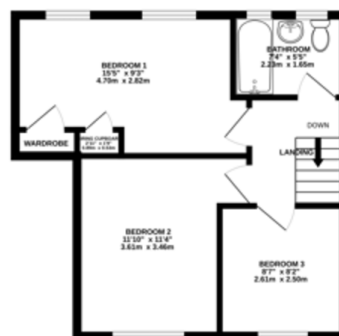

TOTAL FLOOR AREA: 770 sq ft. (71.5 sq m.) approx.
Whilst every attempt has been made to ensure the accuracy of the floorplan contained herein, measurements of floors, windows, rooms and any other areas are approximate and no responsibility is taken for any omission or misstatement. This plan is for illustrative purposes only and should be used as such by any prospective purchaser. The services, systems and appliances shown have not been tested and no guarantee as to their operability or efficiency can be given.
 Made with Hergo 12/18

- Three-bedroom mid-terrace home
- Ideal for first-time buyers or investors
- Popular LE5 location
- Spacious lounge/diner
- Fitted kitchen
- Three good-sized bedrooms
- Family bathroom
- Front and rear gardens

Agents Note: Whilst every care has been taken to prepare these sales particulars, they are for guidance purposes only. All measurements are approximate and are for general guidance purposes only and whilst every care has been taken to ensure their accuracy, they should not be relied upon and potential buyers are advised to recheck the measurements.

