



Blandfield Road, SW12

£585,000

?A generously proportioned ground-floor maisonette with a large private garden. Extending to 779 sq.ft, the property comprises a large double reception room with two original fireplaces, a separate kitchen and a double bedroom. To the rear is a charming, south-west facing garden. Offered to the market chain free and with a share of freehold.

Blandfield Road is a desirable road within the 'Nightingale Triangle', known for its close proximity to a wide range of local shops, bars and restaurants, along with superb transport links from Clapham South (Northern Line) and Wandsworth Common (Overground), and a superb array of schools across both the private and state sectors.

Features

- Ground Floor Maisonette
- Double Reception Room
- Separate Kitchen
- South West Facing Garden
- Share Of Freehold
- Chain Free

Blandfield Road,
London, SW12

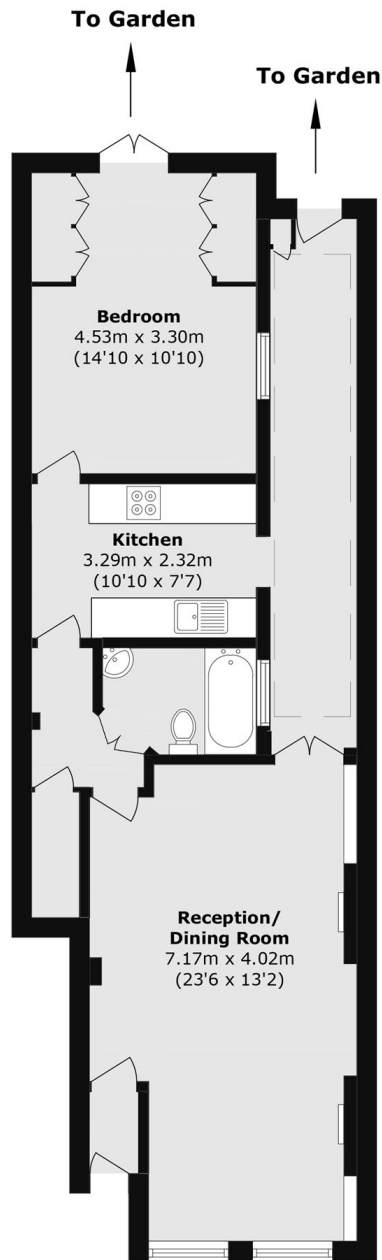

Total area (approx.): 72.4 sq. m (779.3 sq. ft)