

Total Area: 57.9 m² ... 623 ft²
All measurements are approximate and for display purposes only

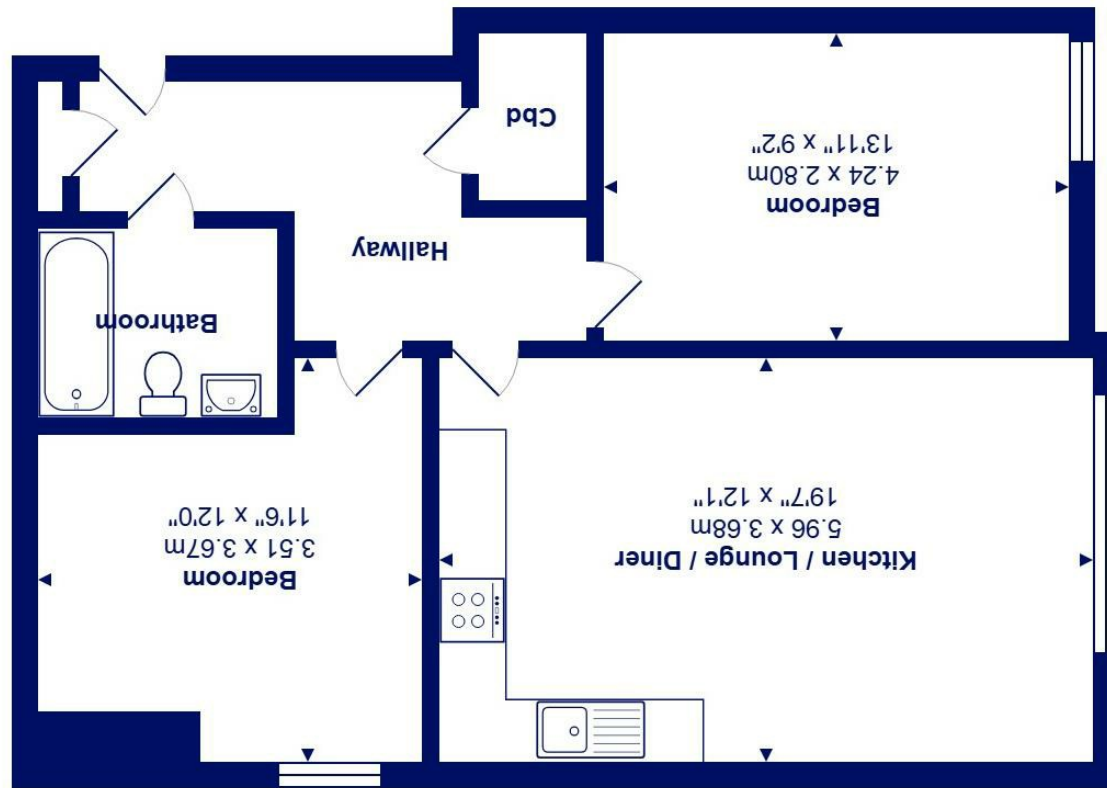

267 Lymington Road, Highcliffe On Sea, BH23 5FW £275,000

Mitchells
1963 — TODAY

A stylish two bedroom second floor apartment in this convenient development right on the high street in Highcliffe with passenger lift and allocated parking.

- Two good size double bedrooms
- Designer bathroom with tiling by Porcelanosa
- Gas fired central heating & Upvc double glazing
- Quality flooring throughout, Flat plastered ceilings & LED lighting
- Pet friendly subject to freeholder consent
- Allocated parking space
- Remainder of 10 Year New Home Warranty
- Lease 125 years from 2020, no ground rent payable
- Maintenance approx £1500 p/a
- Excellent location on the bustling high street and walking distance of the cliff top and beach



EPC Rating Band: B
Council Tax Band: C
Leasehold

Successful buyers will be required to complete online identity checks provided by Lifetime Legal. The cost of these checks is £45 inc. VAT per purchase which is paid in advance, directly to Lifetime Legal. This check verifies your identity in line with our obligations as stipulated by our regulatory body, HMRC

