



**\*\*AVAILABLE IMMEDIATELY\*\* \*\*BRAND NEW BATHROOM INSTALLED\*\***

**\*\*FURNISHED\*\* \*\*ALLOCATED OFF STREET PARKING SPACE\*\***

This two bedroom, first floor apartment is ideally situated at The Mews within Newcastle City Centre. The Mews, originally constructed in the 1980's, is tucked just off Leazes Lane and close to the popular Leazes Park. The apartment is also perfectly placed for convenient access to the RVI and both Universities whilst also giving excellent access to everything that Newcastle City Centre has to offer, including its countless great shops, cafés, bars and restaurants. The apartment also benefits from being placed a short walk from Haymarket Metro Station, providing excellent transport links throughout the region.

The accommodation briefly comprises: communal entrance hall with secure telephone entry system and stairs to all floors; private entrance hall; lounge diner measuring close to 16ft with walk in bay and separate storage cupboard; kitchen with fitted units and work surfaces; two bedrooms, bedroom one with fitted wardrobe storage; newly installed bathroom complete with three piece suite including bath with electric shower over. With allocated off-street parking and available on a furnished basis.

Available Immediately | £1,050pcm | Furnished | First Floor Apartment | 518 Sq ft (48.2m<sup>2</sup>) | Two Bedrooms | Lounge/Diner | Kitchen | Brand New Bathroom WC | Allocated Off-Street Parking | Great City Centre Location | DG & Elec Heating | Council Tax Band: B | EPC Rating: D

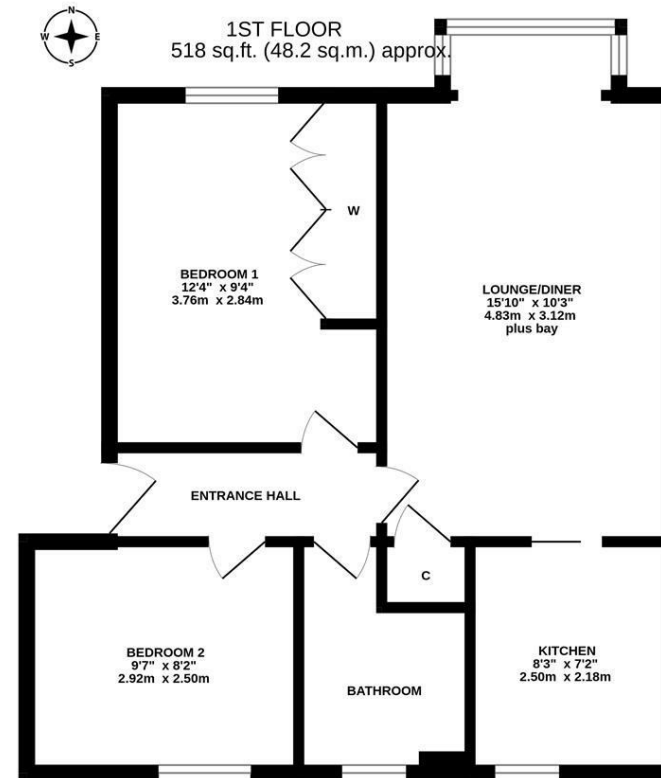

TOTAL FLOOR AREA: 518 sq.ft. (48.2 sq.m.) approx.  
Whilst every attempt has been made to ensure the accuracy of the floorplans contained here, measurements of doors, windows, rooms and any other items are approximate and no responsibility is taken for any error, omission or mis-statement. This plan is for illustrative purposes only and should be used as such by any prospective purchaser. The services, systems and appliances shown have not been tested and no guarantee as to their operability or efficiency can be given.  
Made with Metropix (2022)

**£1,050 PCM**

**IMPORTANT NOTE:** These particulars and the descriptions and measurements herein do not constitute representation and whilst every effort has been made to ensure accuracy, this cannot be guaranteed.

