



31 Livingstone Road

Gillingham ME7 2EH

Guide Price £270,000



3



1



2



GUIDE PRICE £270,000 - £280,000

Situated on Livingstone Road in the town of Gillingham, this charming mid-terrace house, built in the early 1900s, offers a delightful blend of character and modern living. The property boasts an impressive amount square feet, and this property's plot is larger than the average mid-terrace, providing ample space for families or those seeking extra room to breathe. Upon entering, you are greeted by two inviting reception rooms, perfect for entertaining guests or enjoying quiet evenings at home. The well-appointed kitchen, accompanied by a convenient utility area, ensures that all your culinary needs are met. The ground floor also features a practical bathroom, enhancing the functionality of the home.

The first floor comprises three separate bedrooms, each offering a comfortable retreat for rest and relaxation. The layout is ideal for families, providing privacy and space for everyone.

Externally, the property boasts a rear garden that is wider than standard, featuring a lovely decking area to the side, perfect for alfresco dining

The property has a small court yard frontage adding to its curb appeal, and is close to many amenities and falls under council tax band B. Don't miss out on this wonderful opportunity to purchase a true gem
parking permits available



Area Map



Floor Plans

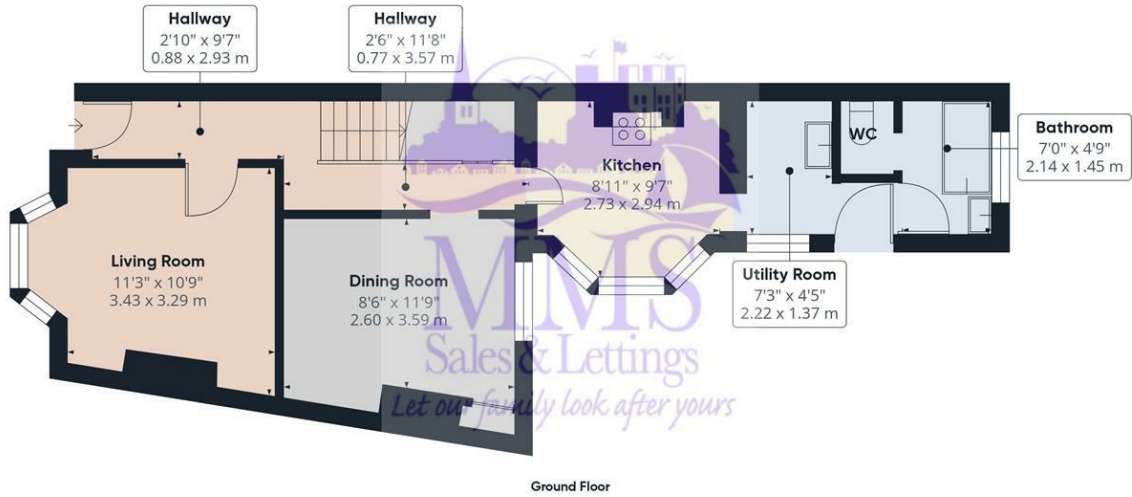

Approximate total area⁽¹⁾
885 ft²
82.2 m²

(1) Excluding balconies and terraces

Calculations reference the RICS IPMS 3C standard. Measurements are approximate and not to scale. This floor plan is intended for illustration only.

GIRAFFE360

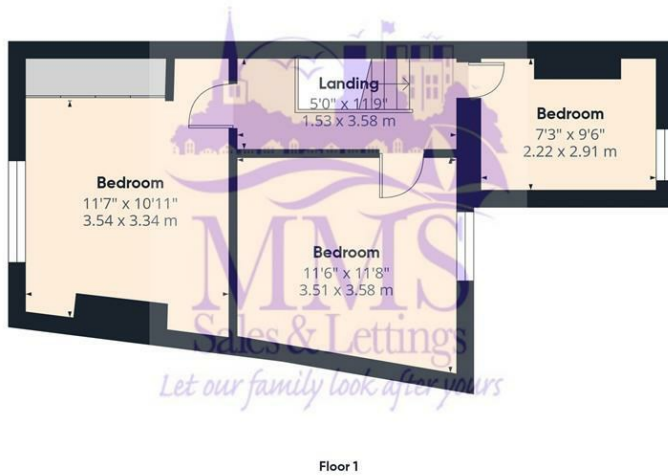

Energy Efficiency Graph

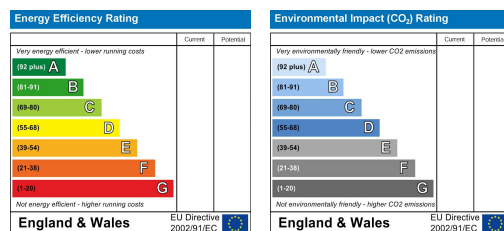

These particulars, whilst believed to be accurate are set out as a general outline only for guidance and do not constitute any part of an offer or contract. Intending purchasers should not rely on them as statements of representation of fact, but must satisfy themselves by inspection or otherwise as to their accuracy. No person in this firm's employment has the authority to make or give any representation or warranty in respect of the property.

159 High Street, Strood, Rochester, Kent, ME2 4TH

Tel: 01634 735335 Email: justine@medwaymortgageshop.co.uk <https://www.medwaymortgageshop.co.uk>