

3
BED

Offering Potential to Personalise with No Chain

20, Agnes Street, Brighton, BN2 3AS



Price £525,000

Freehold

phillipmann
we do more

www.phillipmann.com

20 Agnes Street, BN2 3AS

Approximate Gross Internal Floor Area = 81.87 sq m / 881 sq ft

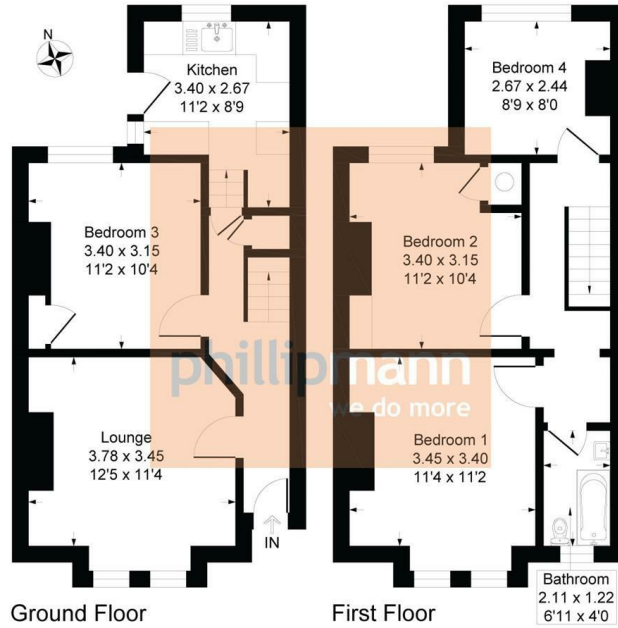

Illustration for identification purposes only, measurements are approximate, not to scale

inbrief...

Nestled in the vibrant heart of Brighton situated in the Elm Grove area, this charming terraced house on Agnes Street offers a delightful blend of comfort and convenience. With three well-proportioned bedrooms, this property is perfect for families, potential investors to utilise the dining room as a fourth bedroom or any client wishing to create their own dream home. The location on Agnes Street places you within easy reach of Brighton's renowned amenities, including shops, restaurants, and the beautiful seafront.

As you step inside, full of character with further potential to restore throughout, the layout is in its original format. The lounge is situated at the front of the property. South facing, natural light floods through the windows, enhancing the welcoming feel of the home whilst providing space for your soft furnishings. The adjacent dining room has a window to rear, storage cupboard and comprises space for your associated furniture.

The kitchen is fitted with a range of wall and base units. Features include: space for cooker and white goods, inset sink drainer with window overlooking garden, breakfast bar, door to side and wall mounted boiler.

Upstairs, the home offers three well-proportioned bedrooms with original feature fireplaces. All rooms offer space for freestanding furniture and offer a blank canvas for your own ideas. To accompany and finish the accommodation, the family bathroom is fitted with: a bath with mixer tap and overhead shower, w/c, wash basin, aqua boarding and frosted window to front.

Externally, the rear garden has excellent potential for improvement and landscaping. The space is enclosed by timber fencing and offers a blank canvas for buyers to create an attractive outdoor seating or entertaining area.

NO CHAIN



EPC - D

Council Tax Band - C

moreinfo...



Phillip Mann Peacehaven Office
226-230 South Coast Road, Peacehaven, BN10 8JR
01273 586622

To see more details on this & all our homes go to www.phillipmann.com