



17 Woodside Crescent, Ebbw Vale

£99,950 Freehold

Stone Mid Terrace • Three Bedroom • Two Reception Rooms • Kitchen • Bathroom • Rear Garden • Forecourt To Front • EPC - D



1 Bethcar Street, Ebbw Vale, Gwent, NP23 6HH
Tel: 01495 302301 Email: ebbwvale@bidmeadcook.co.uk
www.bidmeadcook.co.uk

A three bedroom mid terrace property within the town of Ebbw Vale, which is conveniently located for access to the A465 Heads of the Valley Road, local amenities, and train station.

The accommodation comprises entrance porch, living/dining room, kitchen, bathroom and three bedrooms. Benefits include upvc double glazing, a combi boiler gas central heating system and a rear garden with outdoor storage.



The town of Ebbw Vale has a range of shops, supermarkets, a hospital, college, primary and secondary schools, leisure facilities and a weekly street market in the town centre. The passenger railway currently runs hourly to Cardiff from the station located within the former Garden Festival and also located within Ebbw Vale town.

Council Tax band: A

Tenure: Freehold

EPC Energy Efficiency Rating: D





Ground Floor

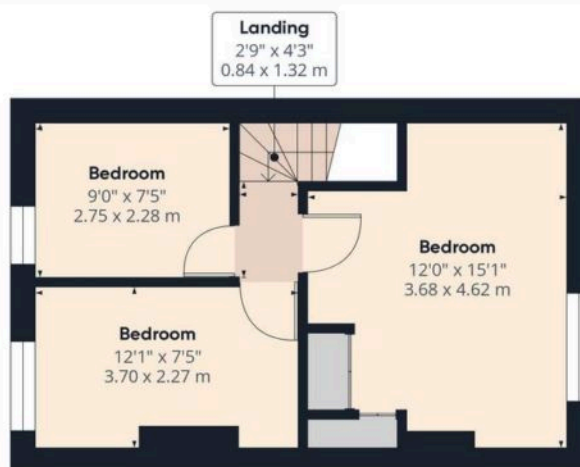

Floor 1



Approximate total area⁽¹⁾
838.06 ft²
77.86 m²

(1) Excluding balconies and terraces

While every attempt has been made to ensure accuracy, all measurements are approximate, not to scale. This floor plan is for illustrative purposes only.

Calculations were based on RICS IPMS 3C standard. Please note that calculations were adjusted by a third party and therefore may not comply with RICS IPMS 3C.

GIRAFFE360

You can include any text here. The text can be modified upon generating your brochure.

You can include any text here. The text can be modified upon generating your brochure.

