



St. Marks Road, W10

£670,000



- Own Entrance
- Front & Rear Garden
- Low Service Charge
- Chain Free
- Turnkey Condition
- Ground Floor



ABOUT THE PROPERTY

A two bedroom ground floor flat with its own entrance and private front and rear gardens, offering well-proportioned accommodation in turnkey condition on St. Marks Road.

Entered via a private entrance, the flat provides around 696 sq ft of well-balanced accommodation. The rear reception and dining room opens directly onto the garden, creating a bright and sociable living space, while the adjacent kitchen benefits from two large windows, good storage and practical worktop space.

There are two bedrooms, including a well-proportioned principal, and two bathrooms providing flexibility for guests or shared living. The property also features both front and rear private gardens, rare for flats in the area, along with an 11 ft by 8 ft garden shed offering excellent additional storage for bicycles or household items.

Presented in turnkey condition, many appliances including the boiler, fridge, dishwasher and washer/dryer have been updated within the past two to three years. The lease was also extended last year and now runs to approximately 170 years, further enhancing the long-term appeal.



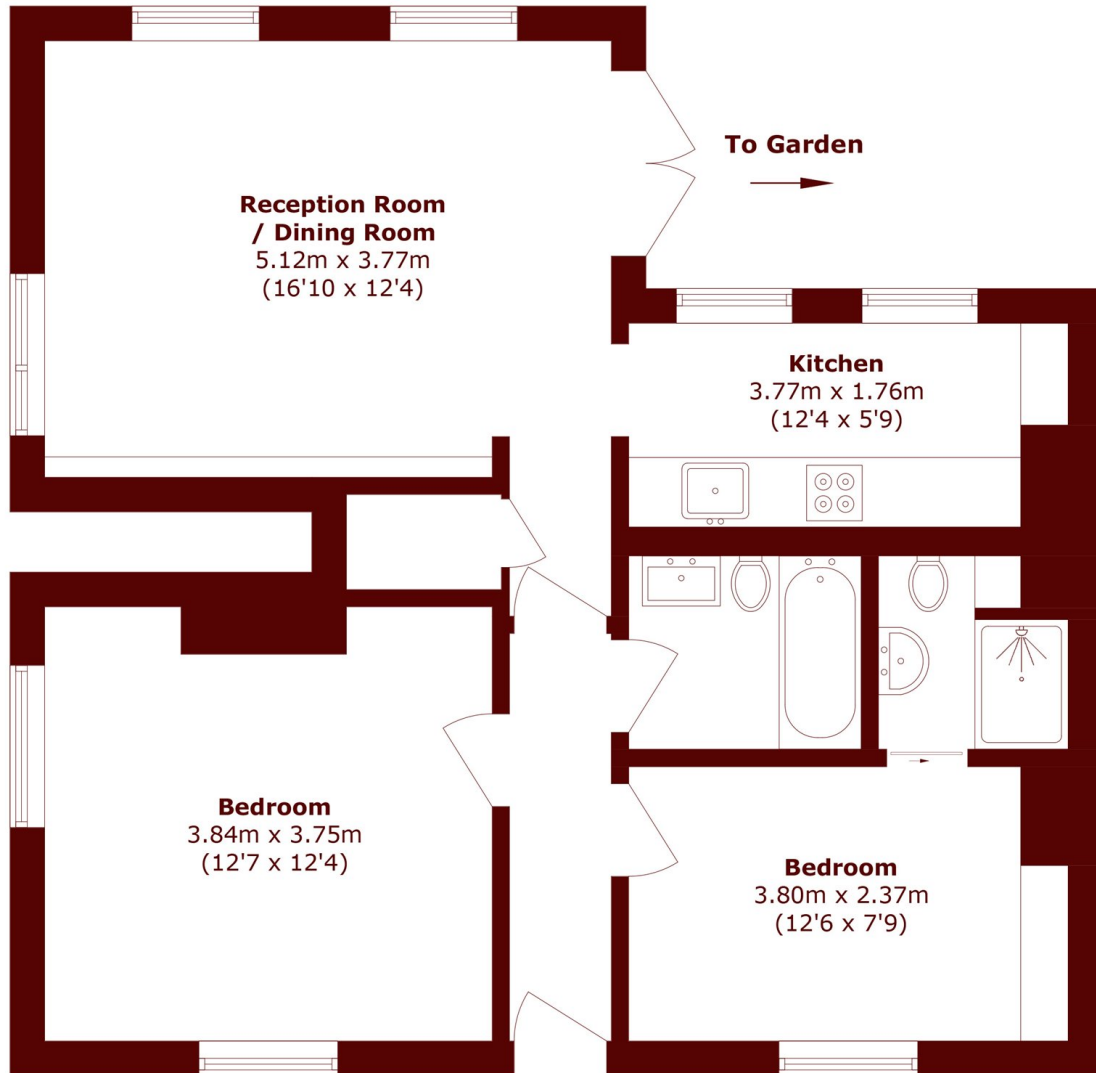

Total area (approx.): 64.7 sq. m (696.4 sq. ft)

Marsh & Parsons North Kensington

136 Lancaster Road, London,
W11 1QU
020 7313 8350