

Kingsway

Hove

LEXTONS / SALES
LETTINGS
AUCTIONS
COMMERCIAL



About the property

Guide Price £160,000 - £170,000

Enviably positioned on Hove seafront, just moments from the ever-popular Rockwater, this spacious and light-filled studio apartment boasts west-facing large windows that flood the space with natural light.

Situated on the first floor of a secure, purpose-built block with a convenient elevator servicing all floors, the apartment features a well-appointed separate kitchen, a generously sized modern shower room, and useful cupboard storage. A hallway from the main entrance enhances the sense of space and privacy.

Set back from the main road, yet just moments from the beach, this prime location offers easy access to the recently regenerated Kingsway, which now features an array of leisure options. Additionally, Hove Lagoon and King Alfred Leisure Centre are within close proximity. Aldrington Train Station is also a short distance away, providing excellent transport links.

**Kingsway
Hove**



1

BEDROOM

0

RECEPTION

1

BATHROOM







First Floor

Approx. 25.6 sq. metres (275.4 sq. feet)

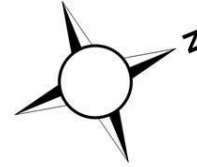

SCAN HERE TO OFFER ON THIS PROPERTY

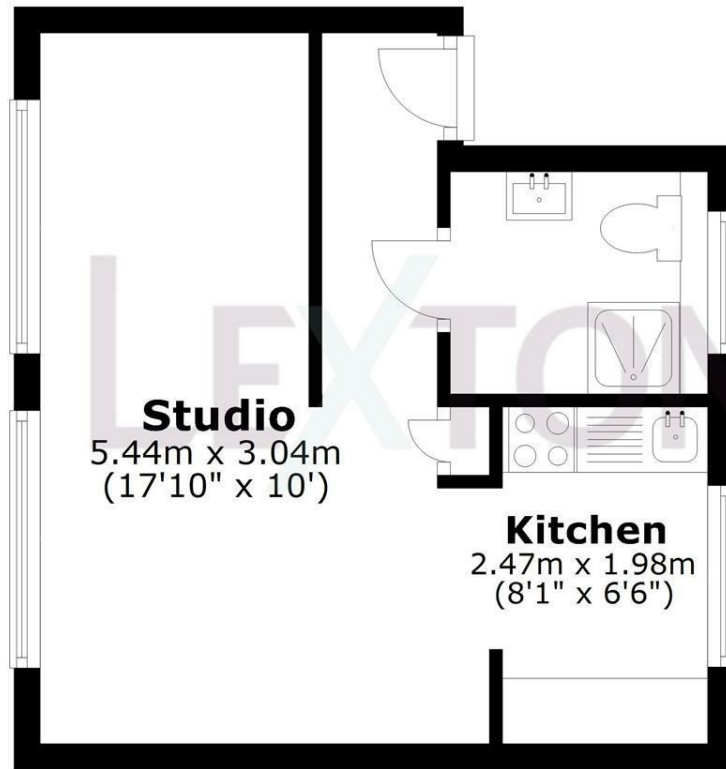

Total area: approx. 25.6 sq. metres (275.4 sq. feet)

Energy Efficiency Rating		
	Current	Potential
<i>Very energy efficient - lower running costs</i>		
(92 plus) A		
(81-91) B		
(69-80) C		
(55-68) D		
(39-54) E		
(21-38) F		
(1-20) G		
<i>Not energy efficient - higher running costs</i>		
England & Wales	EU Directive 2002/91/EC	