

52a, Bexley High Street, Bexley DA5 1AJ  
Guide Price £265,000



Situated in the heart of Bexley Village is this spacious CHAIN FREE 2 bedroom split level flat which does require updating. Offered with a BRAND NEW 149 YEAR LEASE upon completion, the property comprises of a kitchen, spacious lounge with a small balcony area to the front and rear, two double bedrooms and a bathroom. In addition there is a garage which is located en bloc to the rear. An ideal first time buy or buy to let investment your earliest viewing is very highly recommended.

Ground Rent: £150 per annum.

Local Authority: {prop\_LA\_county}  
 Council Tax Band: {council\_tax\_band}



**01322 553322**

60-62 High Street, Bexley, Kent, DA5 1AH

bexley@parkestates.co.uk  
 www.parkestates.co.uk

## Bexley High Street, DA5

Approximate Gross Internal Area = 78.8 sq m / 849 sq ft

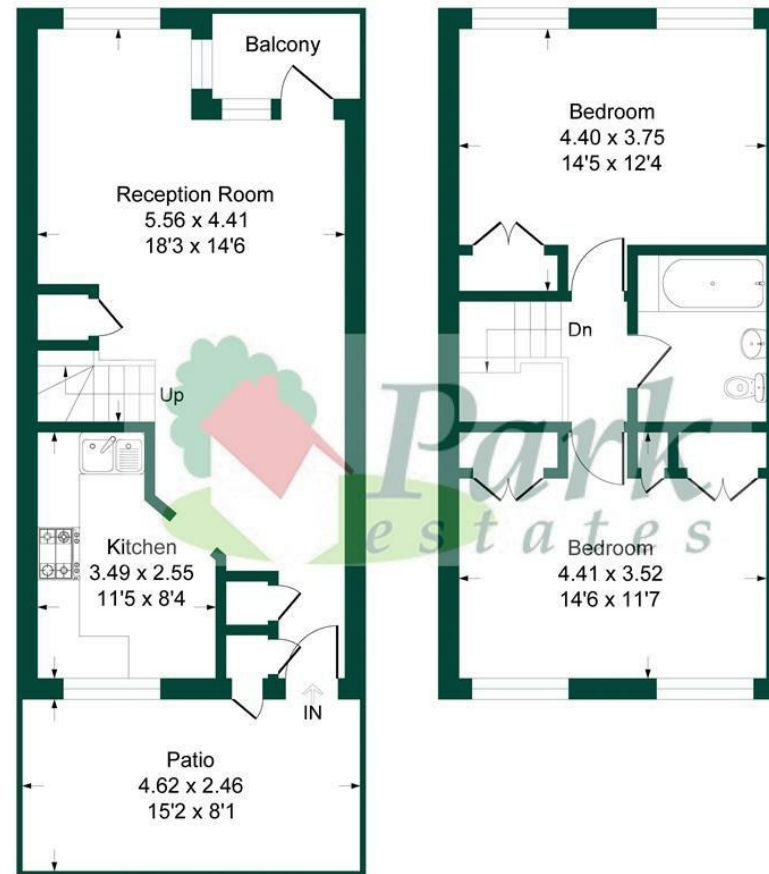

**First Floor**

**Second Floor**

This plan is for layout guidance only. Not drawn to scale unless stated. Windows and door openings are approximate. Whilst every care is taken in the preparation of this plan, please check all dimensions, shapes and compass bearings before making any decisions reliant upon them.  
 Produced By Planpix

Every care has been taken with the preparation of details, but accuracy is in no way guaranteed. These particulars do not constitute a contract and are issued and accepted on the express understanding that all negotiations will be conducted through Park Estates. The seller does not make or give, nor do we or our employees have any authority to give a representation or warranty in relation to the property. Please contact this office before viewing the property. If there is any point which is of particular importance to you, we will be pleased to check the information for you and confirm that the property remains available. This is particularly important if you are contemplating travelling some distance to view the property. We would strongly recommend that all the information that we provide about the property is verified by yourself on inspection and also by your conveyancer, especially where statements have been made by us to the effect that the information provided by us has not been verified.