

Woodcote Fold, Goose Eye, Oakworth, Keighley, BD22 0QG

£1,350PCM (Deposit: £1,557)

 5  4  1



	Current	Potential
Very energy efficient – lower running costs		
(92 plus) A		
(81-91) B		
(69-80) C	76	83
(55-68) D		
(39-54) E		
(21-38) F		
(1-20) G		
Not energy efficient – higher running costs		

Tax Band: E Furnished: Unfurnished

A recently **redecorated** and well-presented five bedroom modern townhouse offering spacious and flexible accommodation **over three floors**. The property includes **four bathrooms (two en-suites)**, a **ground floor lounge** and cloakroom/WC, and a superb **open plan dining kitchen with integrated appliances**, utility room, and access to a rear patio overlooking the stream. Externally there is an **integral garage and double driveway**. Situated in the sought-after village of Goose Eye, the property enjoys a quiet position with convenient access to nearby towns, schools, and transport links.

Key Features

- Five Bed Modern Town House
- Ground Floor WC
- Terrace Overlooking Stream
- Newly Decorated Throughout with New Floor Coverings
- Deposit £1,615
- En-Suite to Two Bedrooms
- Garage & Double Drive
- Popular Hamlet
- Large Dining Kitchen with Additional Utility
- Council Tax Band E | EPC Band C

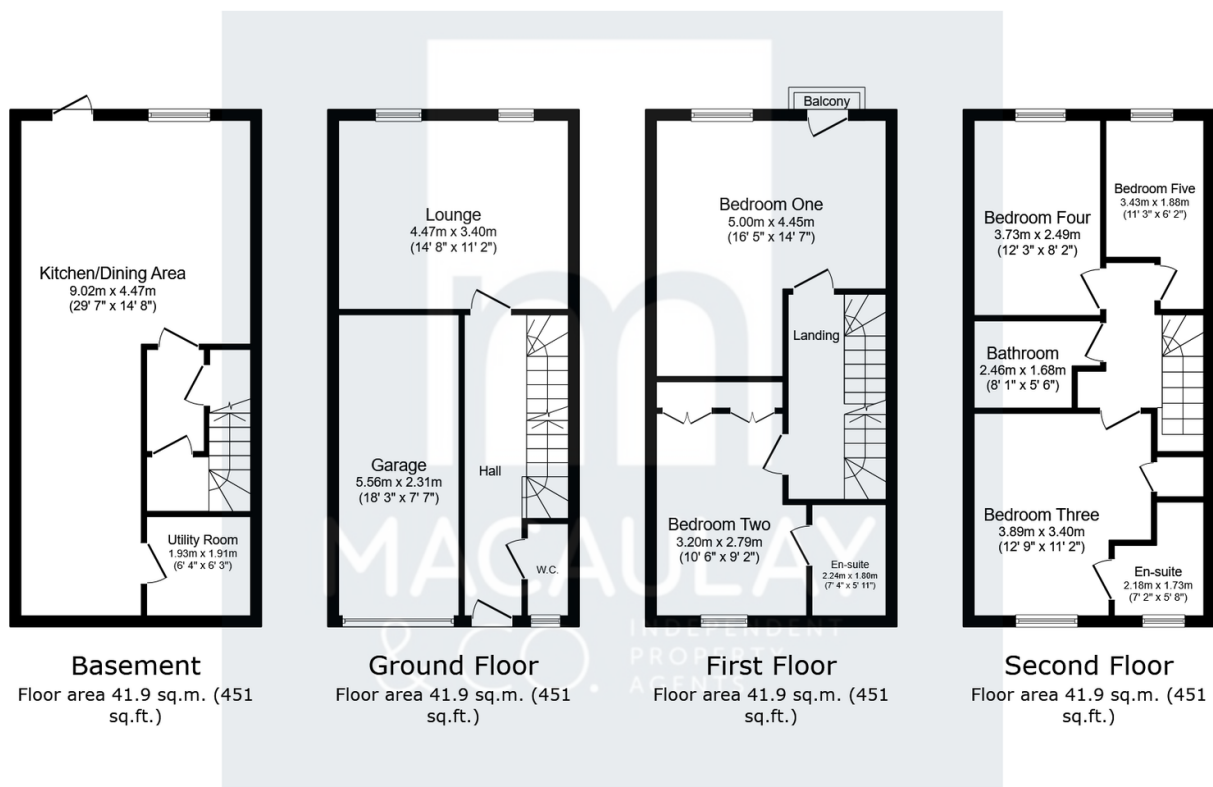

Total floor area: 167.7 sq.m. (1,805 sq.ft.)

This floor plan is for illustrative purposes only. It is not drawn to scale. Any measurements, floor areas (including any total floor area), openings and orientations are approximate. No details are guaranteed, they cannot be relied upon for any purpose and do not form any part of any agreement. No liability is taken for any error, omission or misstatement. A party must rely upon its own inspection(s). Powered by www.Propertybox.io