

Hardwick Avenue Barton Seagrave

richard james

www.richardjames.net

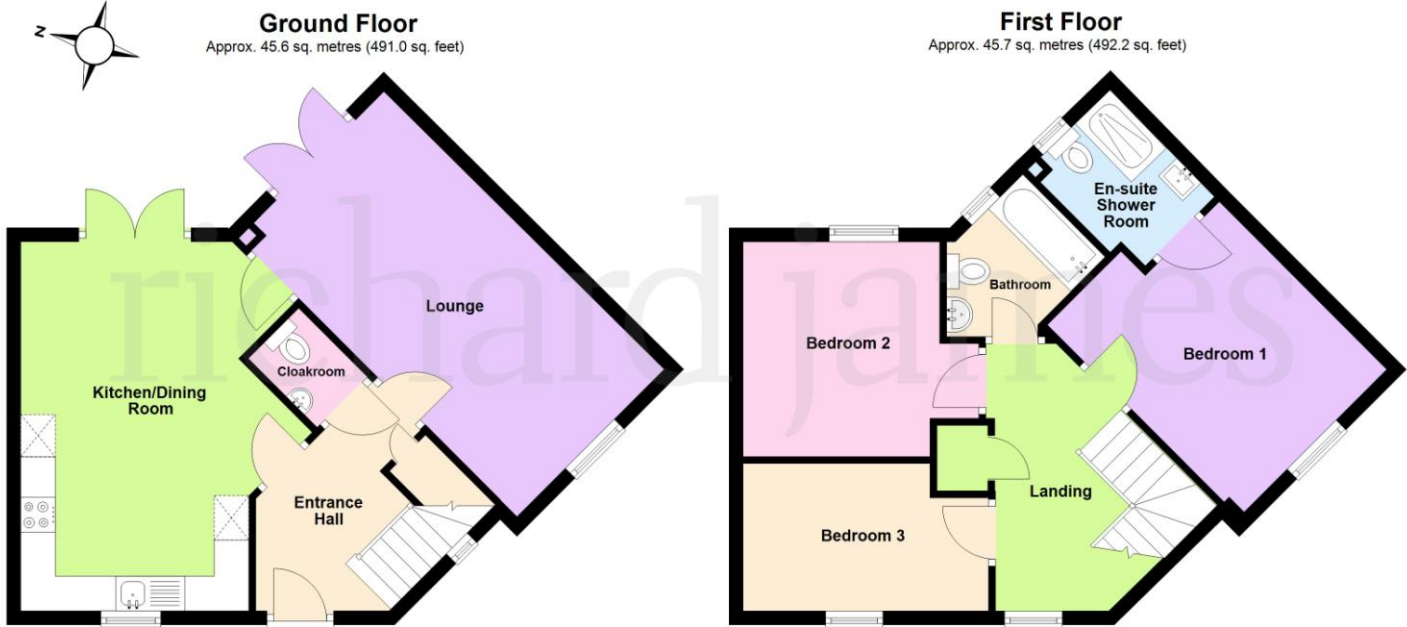

Total area: approx. 91.3 sq. metres (983.2 sq. feet)



Hardwick Avenue Barton Seagrave NN15 5LD
Freehold Price £280,000

Wellingborough Office
27 Sheep Street Wellingborough
Northants NN8 1BS
01933 224400

Irthlingborough Office
28 High Street Irthlingborough
Northants NN9 5TN
01933 651010

Rushden Office
74 High Street Rushden
Northants NN10 0PQ
01933 480480



This plan is a guide only to represent the layout of the property and is not totally to scale. The bathroom fittings and kitchen units may vary in shape and size.

The information given in these particulars is intended to help you decide whether you wish to view this property and to avoid wasting your time in viewing unsuitable properties. We have tried to make sure that these particulars are accurate, but to a large extent we have to rely on what the seller tells us about the property. We do not check every single piece of information ourselves as the cost of doing so would be prohibitive and we do not wish to unnecessarily add to the cost of moving house. Once you find the property you want to buy, you will need to carry out more investigations into the property than it is practical or reasonable for an estate agent to do when preparing sales particulars. For example, we have not carried out any kind of survey of the property to look for structural defects and would advise any homebuyer to obtain a surveyor's report before exchanging contracts. If you do not have your own surveyor, we would be pleased to recommend one. We have not checked whether any equipment in the property (such as central heating) is in working order and would advise homebuyers to check this. You should also instruct a solicitor to investigate all legal matters relating to the property (e.g. title, planning permission etc) as these are specialist matters in which estate agents are not qualified. Your solicitor will also agree with the seller what items (e.g. carpets, curtains etc) will be included in the sale.

Situated on the Bertone Gardens Development in the popular area of Barton Seagrave is this three bedroom semi detached property built by David Wilson Homes in 2018. The property benefits from uPVC double glazing, gas radiator central heating and a range of built in kitchen appliances to include oven, hob, dishwasher, washing machine and fridge freezer and further offers a cloakroom, a 17ft kitchen/dining room, three well proportioned bedrooms with ensuite shower room to the master bedroom, a spacious landing with room for a computer desk to use as a study area and off road parking for two vehicles. A viewing is highly recommended to appreciate the space of the accommodation which briefly comprises entrance hall, cloakroom, lounge, kitchen/dining room, master bedroom with ensuite shower room, two further bedrooms, bathroom, gardens to front and rear and off road parking.

Enter via composite door with top lighter to.

Entrance Hall

Stairs to first floor landing, understairs storage cupboard, telephone point, ethernet point, radiator, doors to.

Cloakroom

White suite comprising low flush W.C., pedestal hand wash basin, tiled splash back, radiator, extractor vent.

Lounge

18' 7" x 10' 0" (5.66m x 3.05m)

Window to front aspect, uPVC French doors to rear garden, two radiators, T.V. point, door to kitchen/dining room.

Kitchen/Dining Room

17' 5" x 13' 9" max (5.31m x 4.19m)(This measurement includes the area occupied by the kitchen units)

Comprising single stainless steel drainer sink unit with cupboards under, base and eye level units providing work surfaces, with matching upstands, built in electric oven and gas hob with extractor hood over, integrated dishwasher, washing machine and fridge/freezer, cupboard housing gas fired combination boiler serving domestic hot water and central heating, two radiators, door to lounge, window to front aspect, uPVC French doors to rear garden.

First Floor Landing

Two windows to front aspect, access to loft space, airing cupboard, radiator, doors to.

Bedroom One

12' 10" max into wardrobe recess narrowing to 11' 3" x 10' 2" (3.91m x 3.1m)

Window to front aspect, radiator, door to.

Ensuite Shower Room

White suite comprising tiled shower enclosure with electric shower, low flush W.C., pedestal hand wash basin, tiled splash back, towel radiator, extractor vent, obscure window to rear aspect.

Bedroom Two

10' 0" x 9' 4" plus door recess(3.05m x 2.84m)

Window to rear aspect, radiator.

Bedroom Three

11' 7" max x 7' 2" max (3.53m x 2.18m)

Window to front aspect, radiator.

Bathroom

White suite comprising panelled bath, low flush W.C., pedestal hand wash basin, tiled splash back, towel radiator, extractor vent, obscure glazed window to rear aspect.

Outside

Front - Mainly laid to lawn, shrubs, hedge, driveway providing off road parking for two vehicles.

Rear - Mainly laid to patio, artificial lawn, shed, enclosed by brick wall and feather board fencing, gated pedestrian access to front.

N.B

The purchasers legal representative will need to establish if there is any estate management charges payable. We understand the vendors have not been requested to pay any estate management charge to-date.

Material Information

The property Tenure is Freehold.

Energy Performance Rating

This property has an energy rating of B. The full Energy Performance Certificate is available upon request.

Council Tax

We understand the council tax is band C (£2,132.87 per annum. Charges for 2026/2027).

Agents Note

Please be aware that some photographs used in our particulars are obtained using a wide-angle lens.

Conveyancing

We are able to offer a free quotation for your conveyancing from a panel of local solicitors or licensed conveyancers.

Offers

For offers to be submitted in the best light, the majority of vendors require us to confirm buyers have been financially qualified. We will require a Mortgage Certificate or Agreement In Principle (A.I.P.) and proof of deposit or cash. This information will be treated confidentially and will not be seen by any other party. We are obliged by law to pass on all offers to the vendors until contracts have been exchanged.

Money Laundering Regulations 2017 & Proceeds of Crime Act 2002

In order to comply with the above Regulations, an intending purchaser will be required to provide official I.D; proof of address, evidence of funding and source of deposit clearly showing the name of the account holder. If funds are being provided by a third party i.e. family, we will require the same from them too. We will verify clients identity electronically from the details provided. The information will be checked against various databases. This is not a credit check of any kind and does not affect credit history. We will retain a record on file.

General Data Protection Regulations 2018

Should you view or offer on this property, we will require certain pieces of personal information in order to provide a professional service to you and our client.

The personal information provided by you may be shared with the seller, but it will not be shared with any other third parties without your consent.

More information on how we hold and process your data is available on our website - www.richardjames.net

Mortgages

We are able to offer our clients mortgage advice through our association with an independent mortgage advisor. Written quotations are available on request. A life policy may be required.

YOUR HOME MAY BE REPOSSESSED IF YOU DO NOT KEEP UP REPAYMENTS ON YOUR MORTGAGE.

