



Hosier Lane, EC1A

£3,650 Per calendar month

A spacious, modern two bedroom apartment featuring two large double bedrooms with built in storage, both offering access to the balcony. The open plan kitchen and reception room is bright and spacious, with full width windows and doors opening the balcony with rooftop views across Clerkenwell.

Situated close to Barbican and Farringdon Stations (Circle, Hammersmith and City, Metropolitan and Elizabeth Line), St. Paul's (Central Line) and City Thameslink under a quarter of a mile walk.

Features

- Two Bedroom
- Penthouse
- Modern
- Full Width Balcony
- 24 Hour Concierge
- Modern Finish

Hosier Lane, London, EC1A

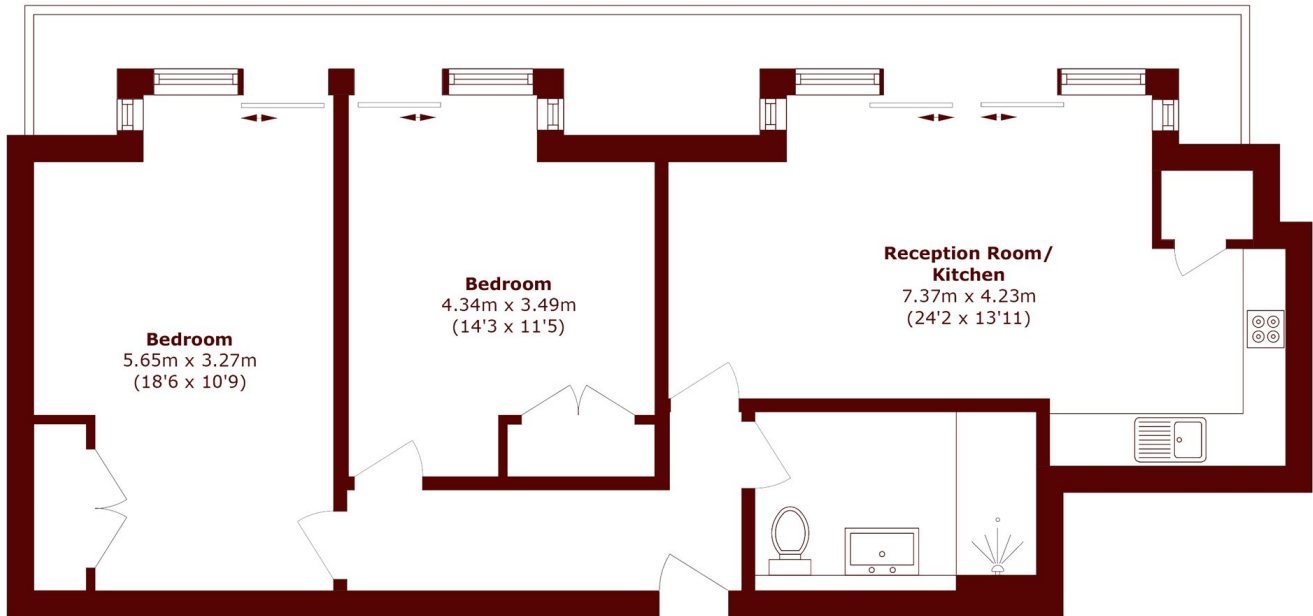

Total area (approx.): 71.8 sq. m (772.8 sq. ft)