

SPENCE WILLARD



Saltbox B7, The West Bay, Yarmouth, Isle of Wight, PO41 0RJ

A beautifully presented one bedroom, fully furnished holiday home located at The West Bay.

VIEWING
YARMOUTH@SPENCEWILLARD.CO.UK 01983 761005
WWW.SPENCEWILLARD.CO.UK

Perfect for two guests, this one bedroom holiday cottage is designed to maximise space and is well-equipped.

Kitchen/Diner/Sitting Room

20'9" x 8'3"

Wall and floor cupboards with an integrated gas hob, oven, and extractor fan. Double stainless-steel sink, and ample room for a dining table and two chairs. The west facing sitting room is filled with natural light with French doors leading to the decked area where you can enjoy views over the well kept communal gardens.

Bedroom

12'0" x 8'8"

A good sized double with a door leading to the front of the cottage. Built in cupboard.

Bathroom

Bath with shower over, WC and wash hand basin.

Services

All main services are connected to the property.

Approximate Gross Internal Area
434 sq ft - 40 sq m

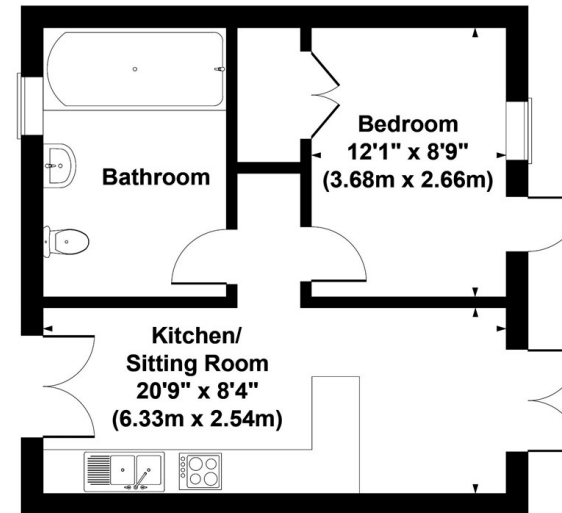

SKETCH PLAN FOR ILLUSTRATIVE PURPOSES ONLY

All measurements walls, doors, windows, fittings and appliances, their sizes and locations, are approximate only. They cannot be regarded as being a representation by the seller, nor their agent.

Produced by Potterplans Ltd. 2018

Tenure

Leasehold - 125 years from 2006.

Service & Maintenance Charge - £3,426.41 per annum.

Ground Rent - £460.96 per annum.

No pets allowed

EPC Rating

C.

Viewings

Viewing is strictly by appointment with the selling agents, Spence Willard.

SPENCEWILLARD.CO.UK

IMPORTANT NOTICE: 1. Particulars: These particulars are not an offer or contract, nor part of one. You should not rely on statements by Spence Willard in the particulars or by word of mouth or in writing ('information') as being factually accurate about the property, its condition or its value. Neither Spence Willard nor any joint agent has any authority to make any representations about the property, and accordingly any information given is entirely without responsibility on the part of the agents, seller(s) or lessor(s). 2. Photos etc: The photographs show only certain parts of the property as they appeared at the time they were taken. Areas, measurements and distances given are approximate only. 3. Regulations etc: Any reference to alterations to, or use of, any part of the property does not mean that any necessary planning, building regulations or other consent has been obtained. A buyer or lessee must find out by inspection or in other ways that these matters have been properly dealt with and that all information is correct. 4. VAT: The VAT position relating to the property may change without notice.