



## 2 BELL BARN ROAD EDGBASTON, B15 2DJ

£225,000  
LEASEHOLD

Beautiful apartment overlooking the park and city centre skyline. Large double size balcony. Allocated parking space in gated residents car park. LOW SERVICE CHARGE!

# Davidson

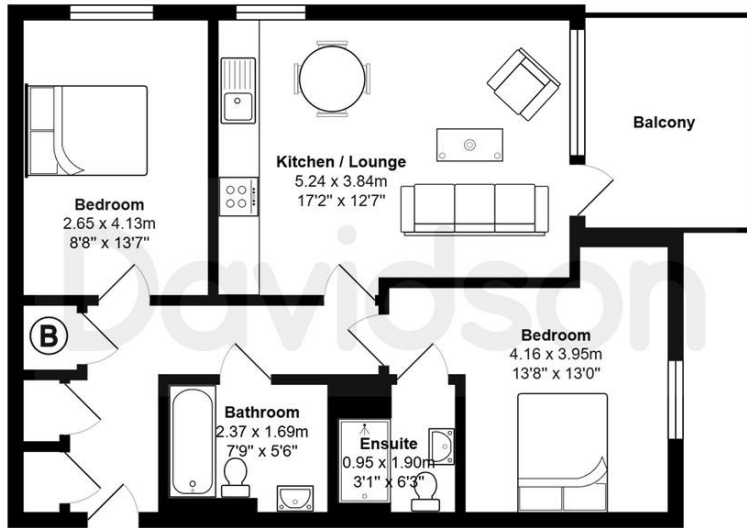

Total Area: 65.2 m<sup>2</sup> ... 702 ft<sup>2</sup> (excluding balcony)  
 All measurements are approximate and for display purposes only

Score	Energy rating	Current	Potential
92+	A		
81-91	B		81 B
69-80	C	73 C	
55-68	D		
39-54	E		
21-38	F		

# Davidson

OFFICE  
 22 Harborne Road  
 Birmingham  
 West Midlands  
 B15 3AA

0121 455 7727  
[info@davidsonstates.co.uk](mailto:info@davidsonstates.co.uk)  
[www.davidsonstates.co.uk](http://www.davidsonstates.co.uk)

Agents Note: Whilst every care has been taken to prepare these particulars, they are for guidance purposes only. All measurements are approximate and are for general guidance purposes only and whilst every care has been taken to ensure their accuracy, they should not be relied upon and potential buyers/tenants are advised to recheck the measurements