



## Bush Grove

Stanmore

£700,000

An exceptional, Liang-built house with four bedroom, semi-detached house available chain free with Davidson Frost-Wellings.

On the ground floor the house has two reception rooms, each with bay windows, plus an eat-in kitchen, downstairs shower room and integrated garage. On the first floor the house has four bedrooms and a family bathroom.

The rear, West-facing garden extends to over 50' including patio and mostly laid to lawn. The front of the property offers driveway parking for multiple cars. The whole house enjoys higher-than-average ceilings ensuring the property is bright, airy and full of natural light.

Harrow Council tax band F.

### Viewing

Please contact our Davidson Frost-Wellings Office on 020 8954 8806 if you wish to arrange a viewing appointment for this property or require further information.

- Four bedrooms
- Two bathrooms
- West facing garden
- Higher-than-average ceilings
- Extension potential (STPP)
- Semi-detached freehold

# Floor Plan

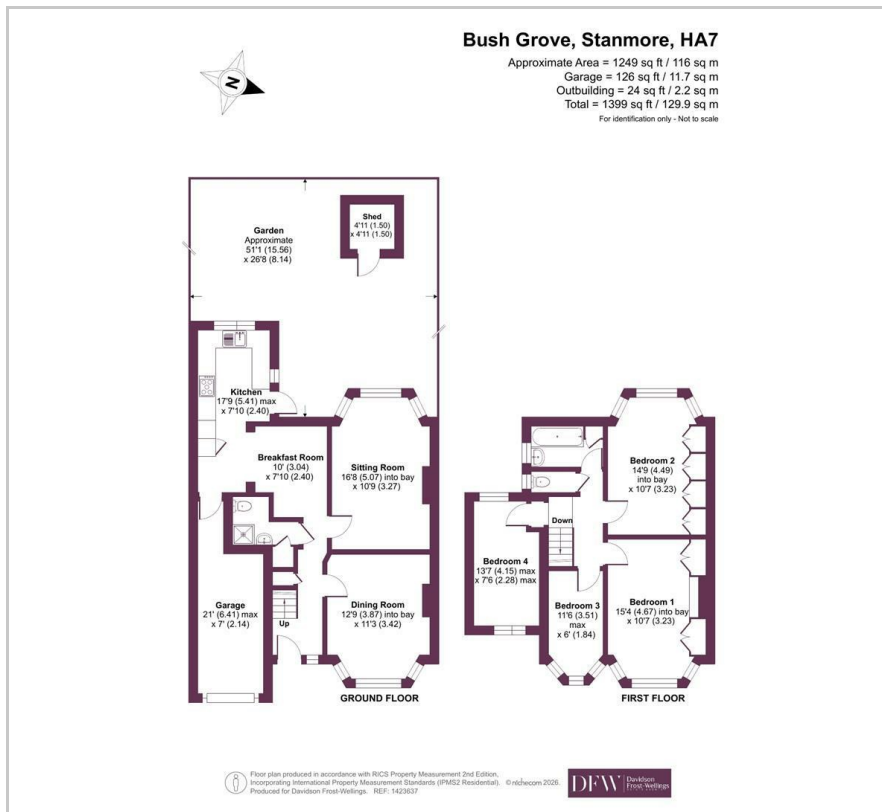

# Area Map

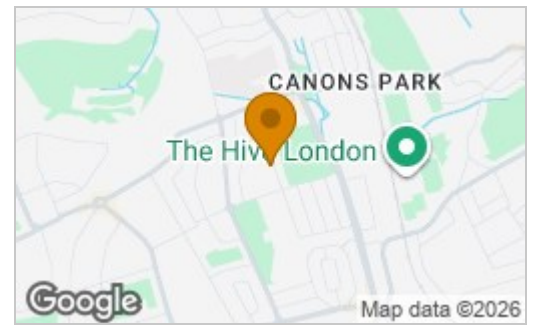

## Energy Efficiency Rating

	Current	Potential
Very energy efficient - lower running costs		
(92 plus) <b>A</b>		
(81-91) <b>B</b>		<b>86</b>
(69-80) <b>C</b>		
(55-68) <b>D</b>	<b>67</b>	
(39-54) <b>E</b>		
(21-38) <b>F</b>		
(1-20) <b>G</b>		
Not energy efficient - higher running costs		
<b>England &amp; Wales</b>	EU Directive 2002/91/EC	



These particulars, whilst believed to be accurate are set out as a general outline only for guidance and do not constitute any part of an offer or contract. Intending purchasers should not rely on them as statements of representation of fact, but must satisfy themselves by inspection or otherwise as to their accuracy. No person in this firm's employment has the authority to make or give any representation or warranty in respect of the property.