

CHESTERTONS





Thornwood Gardens

Holland Park, W8 7ER

“*This exquisite three-bedroom apartment near Holland Park exemplifies luxury living in one of London’s most desirable neighbourhoods. It seamlessly blends modern design with classic elegance, creating a sophisticated yet inviting home.*”

Long let: £5,600 per week / £24,266.65 per month

3



3



2,811
sqft





Property Description

Discover unparalleled luxury within this exquisite third-floor lateral apartment nestled in a distinguished Kensington landmark development. This residence's remarkable 56-foot reception room epitomizes expansive, light-filled living and entertaining spaces. This area's sheer size and luminosity create an inviting atmosphere for relaxation and social gatherings.

Delight in the dual benefit of two balconies that offer breath taking views overlooking the charming communal square, enhancing the apartment's appeal and providing a serene escape amidst the urban landscape.

Step into the heart of the home—a separate modern kitchen exuding style and equipped with top-of-the-line Miele appliances, promising culinary excellence and convenience.

The crowning jewel of this opulent apartment is the luxurious principal bedroom suite, featuring a spacious walk-in dressing room and a chic en suite bathroom exquisitely designed with a separate bath and shower. Adding to the allure, the two additional double bedrooms each boast their own en-suite bathrooms.

Further enhancing functionality, the residence includes a guest cloakroom and a utility cupboard. The development has 24 hour concierge and underground parking.



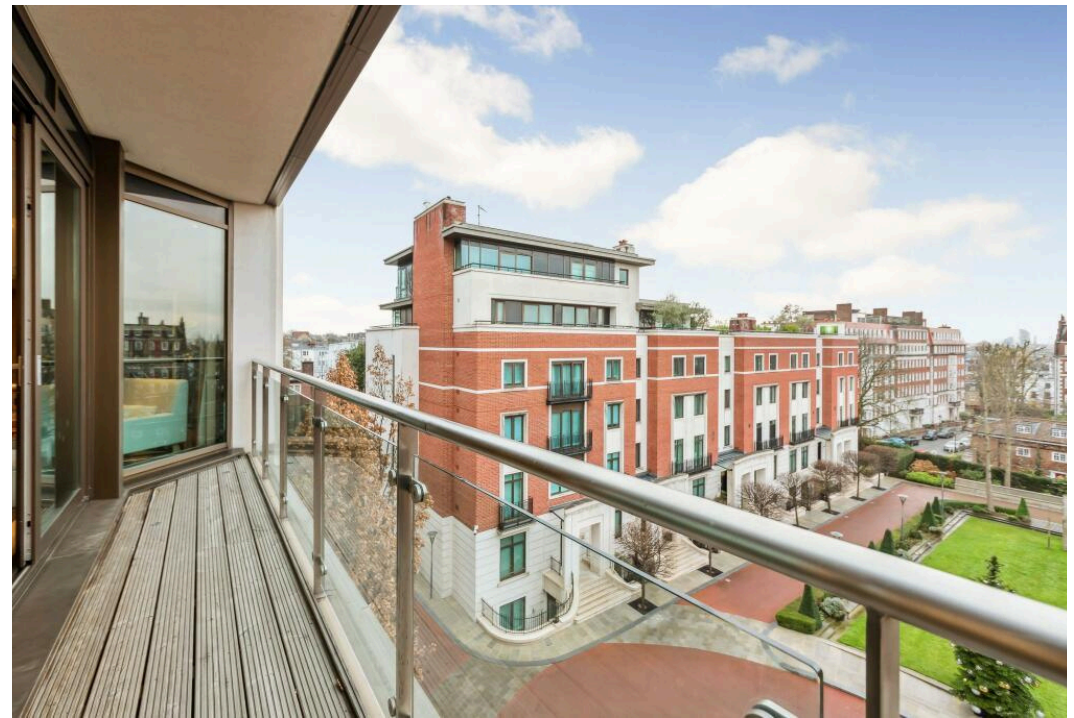

Thornwood Lodge, Thornwood Gardens, W8

Approximate Gross Internal Area
2633 sq ft / 244.6 sq m
External Area = 178 sq ft / 16.5 sq m
Total = 2811 sq ft / 261.1 sq m



Third Floor

Illustration for identification purposes only,
measurements are approximate, not to scale.