

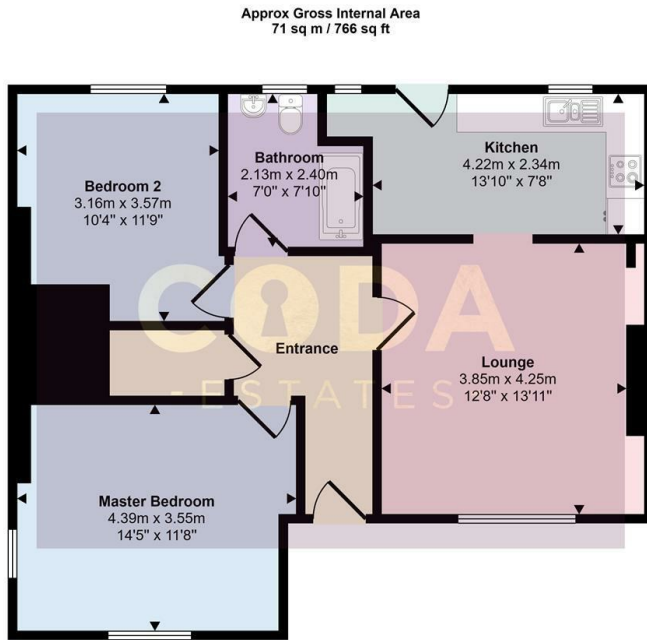

## 18 Woodhead Avenue, Kirkintilloch, Glasgow, G66 3DL

Offers Over £140,000

- Stylish and spacious lower cottage flat
- Spacious fitted kitchen
- Sought-after Kirkintilloch location
- Council Tax Band- B
- Two generous double bedrooms
- Modern bathroom
- Walking distance to local amenities
- Well proportioned lounge
- Large rear garden
- EER- D



Floorplan

This floorplan is only for illustrative purposes and is not to scale. Measurements of rooms, doors, windows, and any items are approximate and no responsibility is taken for any error, omission or mis-statement. Icons of items such as bathroom suites are representations only and may not look like the real items. Made with Made Snappy 360.

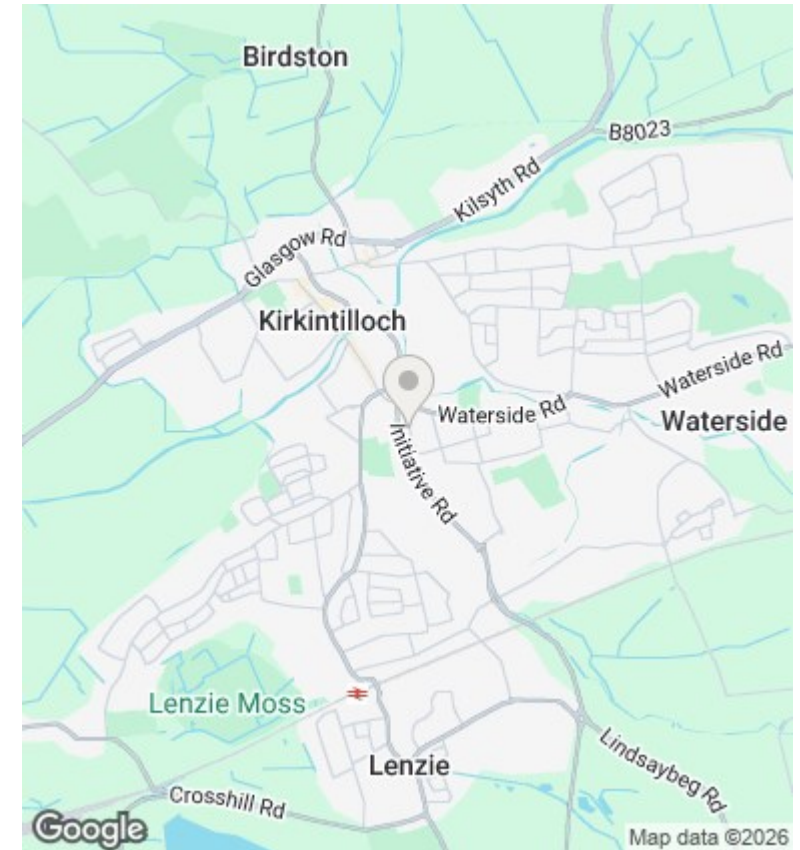

## Directions

## Viewings

Viewings by arrangement only. Call 01417751050 to make an appointment.

## Council Tax Band

B

## EPC Rating:

D

Energy Efficiency Rating		
	Current	Potential
<i>Very energy efficient - lower running costs</i>		
(92 plus) <b>A</b>		
(81-91) <b>B</b>		
(69-80) <b>C</b>		
(55-68) <b>D</b>	66	74
(39-54) <b>E</b>		
(21-38) <b>F</b>		
(1-20) <b>G</b>		
<i>Not energy efficient - higher running costs</i>		
<b>Scotland</b>	EU Directive 2002/91/EC	