



The Drive

Isleworth, TW7

£675,000

A superb three bedroom, two bathroom semi-detached 1930's family home on The Drive, a popular residential road just off Spring Grove Road. This fabulous home is ideally located for Hounslow East Tube Station, Isleworth Mainline Station and some the areas best schools.

- Beautiful Three Bedroom Semi-Detached Family Home
- Great Location - Close to Hounslow East Tube Station
- Substantial Garden - over 140ft Long
- Potential To Extend (STPP)
- Popular Residential Road
- Garage
- Family Bathroom & Downstairs Shower Room
- Excellent Primary & Secondary School Nearby





The Drive, TW7 4AA

Approximate Gross Internal Area

Main House 1023 sq ft - 95 sq m

Garage 118 sq ft - 11 sq m

Total 1141 sq ft - 106 sq m

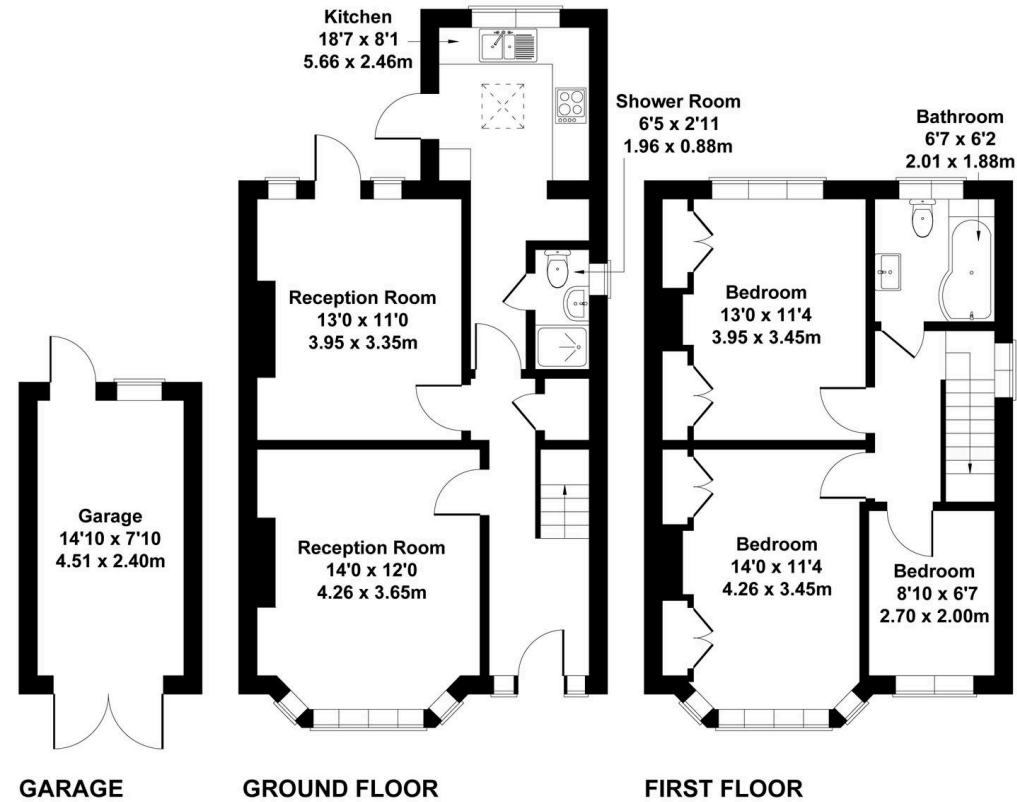

This floorplan is for guidance only and does not form part of an offer or contract.
Buyers or tenants should verify all details through inspection, searches, and surveys.
Measurements are approximate and should not be relied upon for valuation or transactions.
Produced by Plan Portal.
www.evolveLondon.co.uk

