



Naoroji Street, WC1X

£700,000

A two double bedroom apartment situated on the third floor of a secure modern development with lift and concierge. This lateral flat comprises kitchen/reception, two double bedrooms and two bathrooms (one en-suite). The property is sold chain free with a long lease and share of the freehold.

Naoroji Street is a private, portered development positioned just north of Rosebery Avenue on the upper end of Margery Street. Sadlers Wells theatre and the eateries of Exmouth Market are just a short walk. Angel tube station and the popular Upper Street are also under ten minutes walk away, whilst Kings Cross St Pancras is within easy reach under 1/2 mile away.

Features

- Two Bedrooms
- Two Bathrooms
- Third Floor
- Chain Free
- Share of Freehold

Naoroji Street, London, WC1X

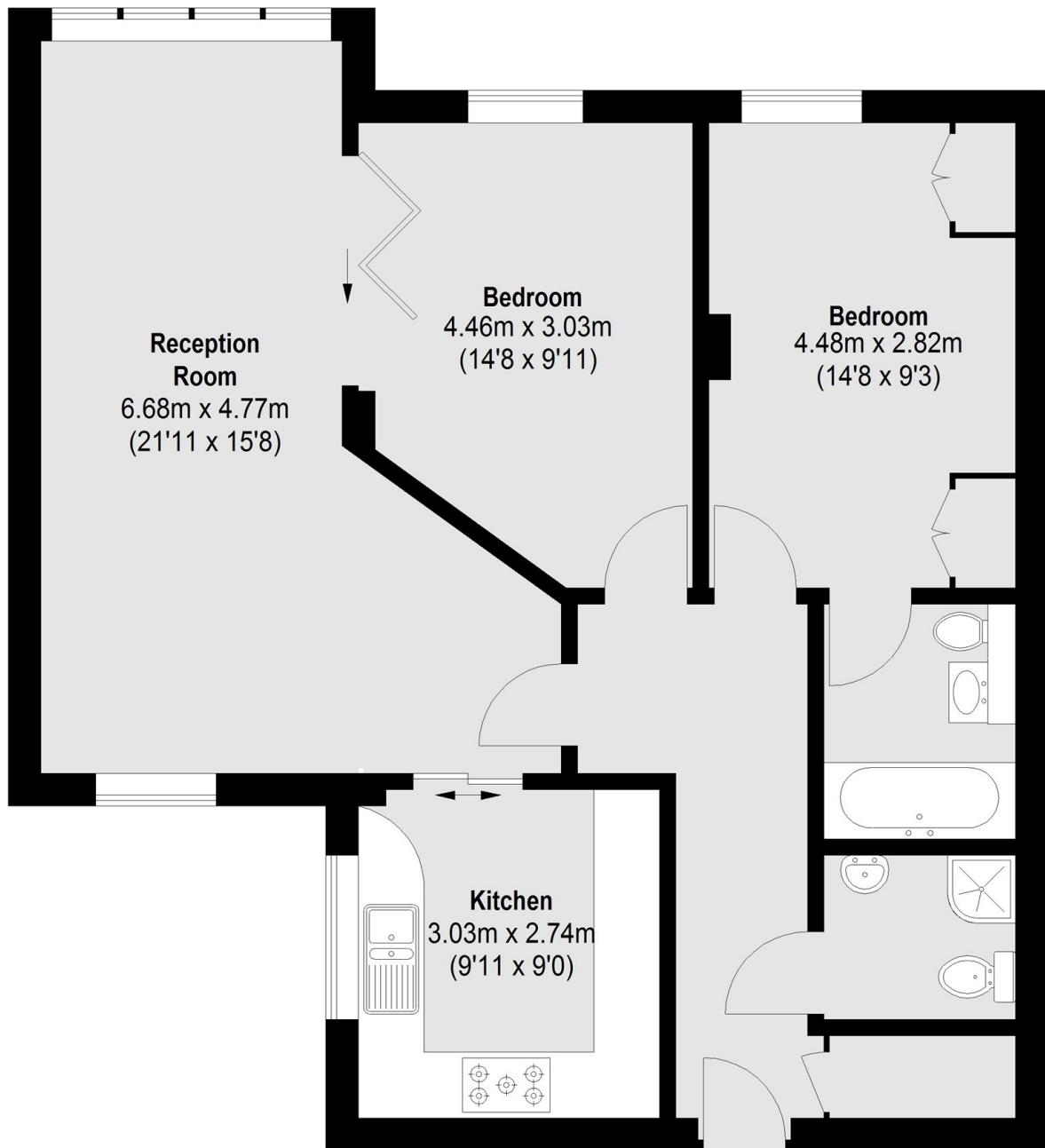

Total area (approx.): 74.09 sq. m (797 Sq. ft)