



## Eagle Drive, NW9

£1,300 Per calendar month

A spacious second floor studio apartment within this quiet modern development large studio room, arch into kitchen, bathroom/WC, communal gardens, and off street parking

Situated in the popular development in the heart of Colindale, within easy reach of Colindale Underground station, and all amenities on Edgware Road (NW9)

### Features

- Studio
- Sought After Development
- Spacious Apartment
- Close to Transport & Amenities
- Off Street Parking
- Communal Gardens

Eagle Drive,  
London, NW9

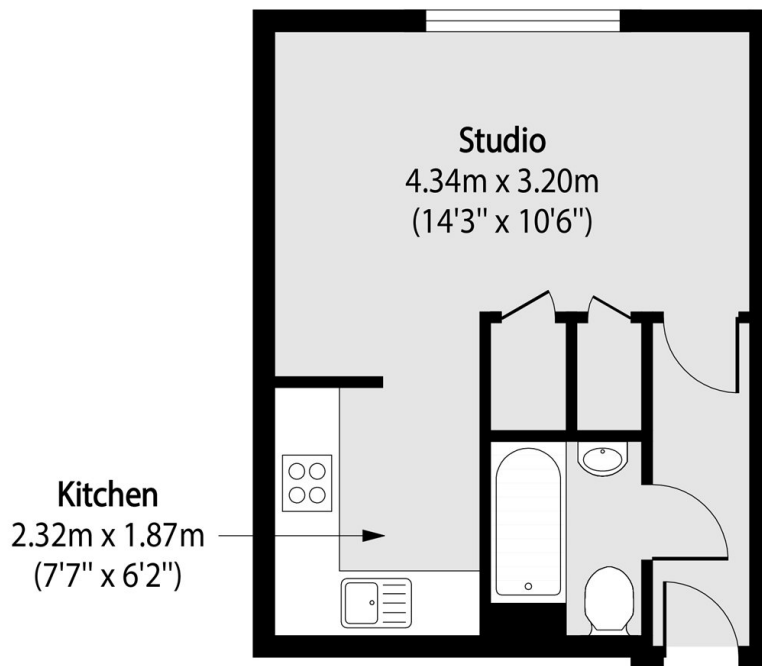

Total area (approx): 24.73 sq m (266 sq. ft)