



*jordanfishwick*

Reeman Court

£925 Per Month



## Reeman Court, WILMSLOW, SK9 4DB

£925 Per Month

Tucked away on this quiet cul de sac in a small quiet development with views over open countryside is this refurbished one-bedroom apartment

Ideal for a single person or couple looking for modern and clean accommodation within walking distance of Wilmslow town centre and train station, local shops are within easy walking distance and the development has unallocated off road parking.

Offered PART FURNISHED and AVAILABLE BEG MAY with viewings to commence from 01/05/2026

Having been completely renovated including new kitchen and bathroom this delightful property benefits from wood effect flooring throughout and neutral decor to the walls, curtains and new light fittings are in the process of being fitted

Communal entrance hall with fob access and stairs to apartment, private entrance hall with storage and entry phone system, modern fitted dining kitchen with appliances including new washer dryer and fridge freezer, lounge with open aspect views, double bedroom with open aspect views, bathroom with shower over bath

Gas central heating

VIEWING RECOMMENDED

Contact Wilmslow 01625 536300 £925.00pcm

COUNCIL TAX A

EPC C

### LOCATION

Jordan Fishwick Estate and Letting Agents Wilmslow office is located in a prime position central to the bustling and stylish town centre. With our impressive frontage it's impossible to miss our attractive office.

Managed by Guy Grainger, Partner, who has been an Estate Agent since 1980, and has a wealth of local knowledge and experience

With busy sales and lettings departments all under the same roof along with our independent mortgage advisor on hand the Wilmslow branch has everything you need to help with your sales or lettings transactions.

Knowledgeable and friendly staff also compliment the range of services we offer and we are known throughout the Wilmslow area for our proactive approach in helping people find their dream home

### DIRECTIONS

From Wilmslow town centre proceed out of Wilmslow down Church Street and pass The Carrs country park on the right hand side. Proceed up The Cliff and at the top of the hill go straight across onto Lacey Green Road. Take the turning on the left to Barlow Road and at the bottom turn right onto Twinnies Road. Follow the road round past the shops and turn left onto Carr Mill Mews and Reeman Court can be found at the bottom. SK9 4DB

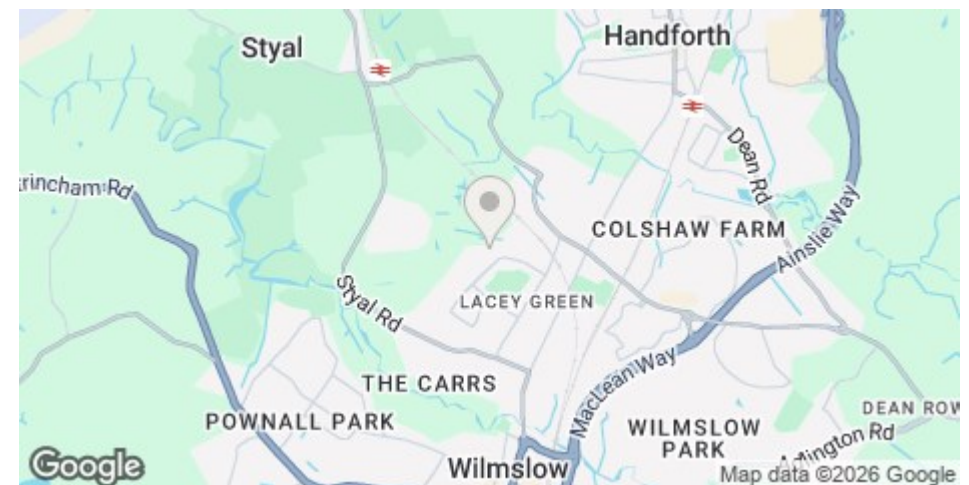

- ONE BEDROOM
- REFURBISHED
- WALKING DISTANCE OF WILMSLOW AND STATION
- QUIET LOCATION
- PART FURNISHED
- FIRST FLOOR APARTMENT
- COUNCIL TAX A
- EPC C

Postcode - SK9 4DB

EPC Rating - C

Floor Area - sq ft

Local Authority - Cheshire East

Council Tax - A



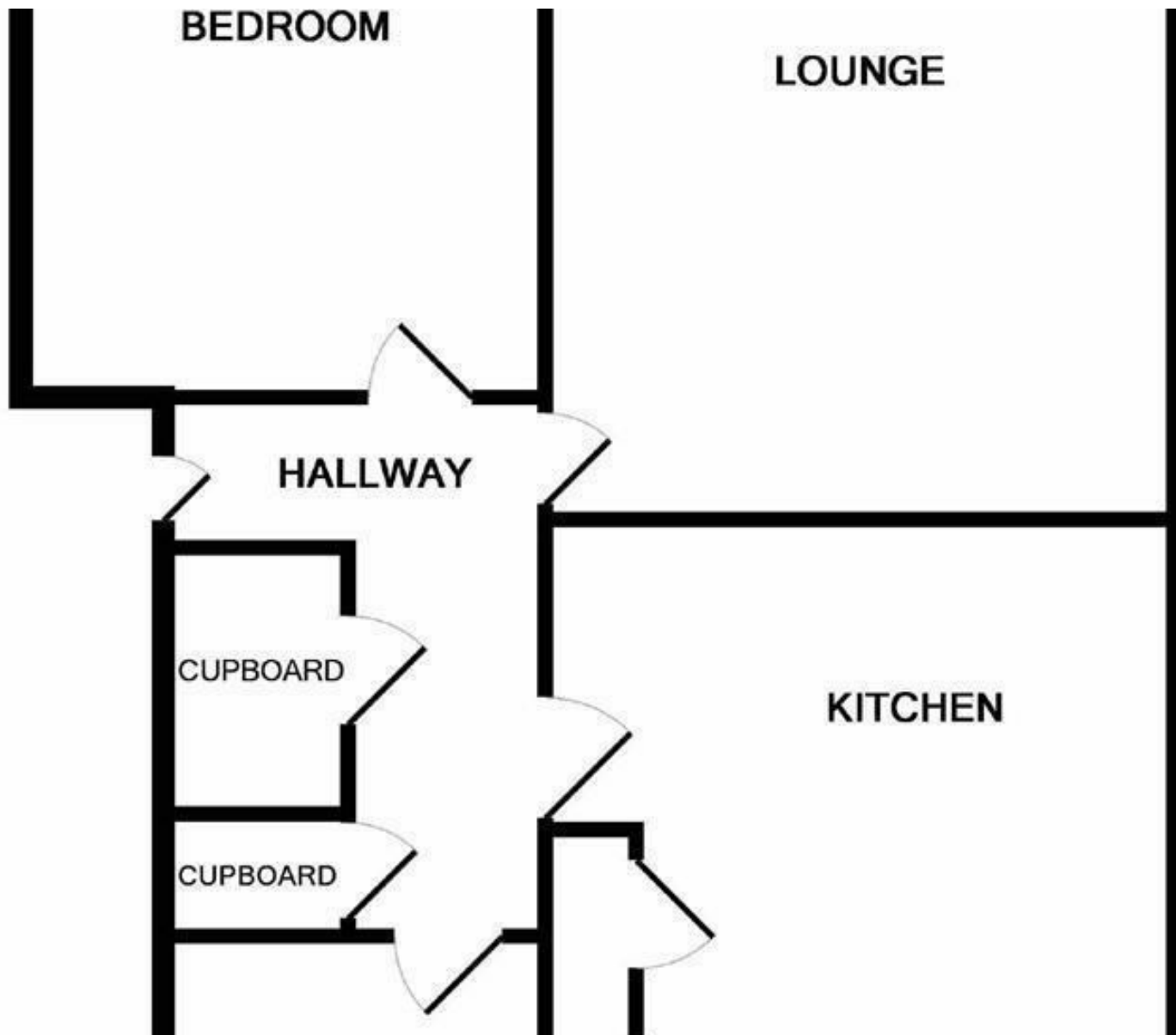

These particulars are believed to be accurate but they are not guaranteed and do not form a contract. Neither Jordan Fishwick nor the vendor or lessor accept any responsibility in respect of these particulars, which are not intended to be statements or representations of fact and any intending purchaser or lessee must satisfy himself by inspection or otherwise as to the correctness of each of the statements contained in these particulars. Any floorplans on this brochure are for illustrative purposes only and are not necessarily to scale.

Offices at: Offices at Chorlton, Didsbury, Disley, Hale, Glossop, Macclesfield, Manchester Deansgate, Manchester Whitworth Street, New Mills, Sale, Wilmslow and Withington

01625 536300