

Buy. Sell. Rent. Let.



Haycroft Street, Grimsby



When it comes to
property it must be

lovelle



£65,000



An exciting BTL opportunity located in Grimsby.

Key Features

- BTL Opportunity
- Currently LET
- Two Bed Terrace
- Grimsby Town Centre

- GCH & uPVC DG
- EPC rating D
- Tenure: Freehold





ATTENTION BUY TO LET INVESTORS

Lovelle offer to market this two bedroom terrace house currently LET producing £525pcm. Located within central Grimsby positioned well for the vast range of nearby amenities. The property consists of Two reception rooms, two bedrooms, kitchen and bathroom. Externally there is a garden to the rear. Viewings are highly recommended.

Disclaimer

We endeavour to make our sales particulars accurate and reliable, however, they do not constitute or form part of an offer or any contract and none is to be relied upon as statements of representation or fact. Any services, systems and appliances listed in this specification have not been tested by us and no guarantee as to their operating ability or efficiency is given. All measurements have been taken as a guide to prospective buyers only, and are not precise. If you require clarification or further information on any points, please contact us, especially if you are travelling some distance to view.

Mobile and broadband

It is advised that prospective purchasers visit checker.ofcom.org.uk in order to review available wifi speeds and mobile connectivity at the property.



Ground Floor
Approx. 40.0 sq. metres (430.9 sq. feet)

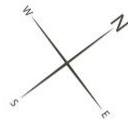
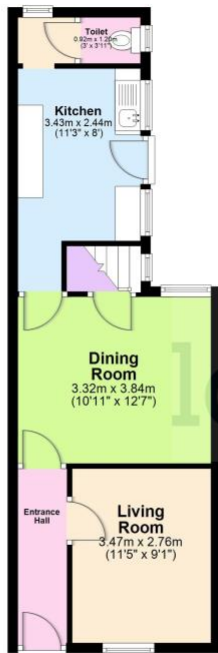

First Floor
Approx. 37.1 sq. metres (399.6 sq. feet)



Total area: approx. 77.2 sq. metres (830.6 sq. feet)

The provided floor plan is intended for general informational purposes only and may not accurately represent the exact dimensions, layout, or features of the property. The floor plan should not be relied upon for making decisions about purchasing, renting, or modifying the property. Actual measurements and features may vary. It is recommended that interested parties conduct a physical inspection of the property to verify the accuracy of the floor plan and obtain specific information about the property's condition, amenities, and any other relevant details.
Plan produced using PlanUp.



When it comes to **property**
it must be

lovelle

01472 251918

grimsby@lovelle.co.uk

