

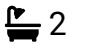

Blenheim Gardens, NW2

Guide Price £1,350,000

 3  2  1

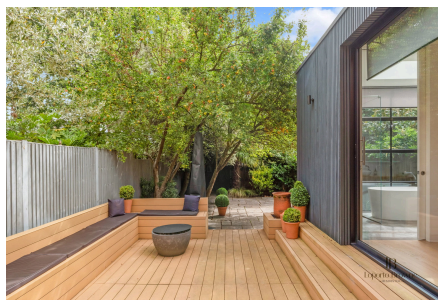

A beautifully reimagined and extended period home on one of Willesden Green's most desirable tree-lined streets which occupies the entire raised ground floor of a handsome period building and offers a rare combination of heritage charm and high-spec contemporary design. This substantial three-bedroom, two-bathroom garden apartment features sole use of main entrance, private front and rear gardens, and off-street parking, an exceptionally rare combination in this location.

Oli and Liana are proud to present this home. Please watch the video and contact us today to arrange your private viewing.

Key Features

- Three double bedrooms & two luxurious bathrooms
- High ceilings and abundant natural light
- Underfloor heating and air conditioning
- Smart tech ready with CAT 5 cabling, SKY Q points, and security system wiring in place
- Oli and Liana are proud to present this home. • Please watch the video and contact us today to arrange your private viewing.
- Private front and rear gardens, off-street parking and own main entrance
- Exceptional principal suite
- Landscaped garden with composite decking, built-in seating and a Paloform concrete gas firepit
- Excellent location just 2 mins from Willesden Green Station with easy access to Gladstone Park

Blenheim Garden
 Approx. Gross Internal Area 1472 Sq Ft - 136.77 Sq M

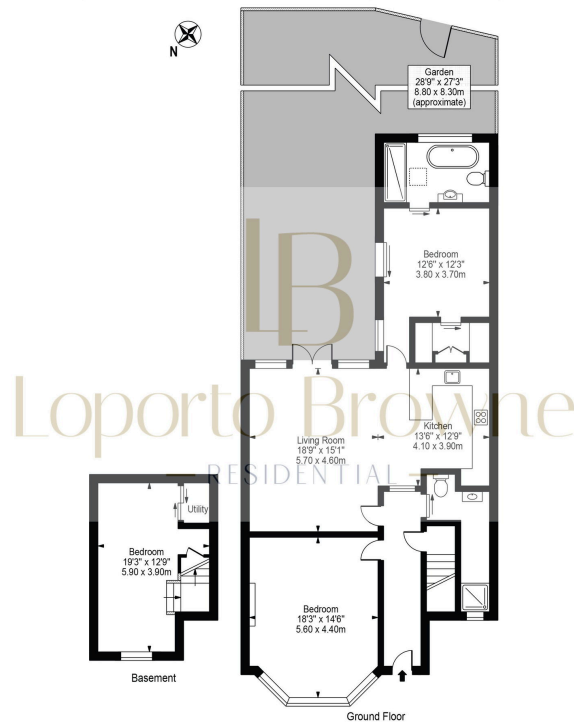

For Illustration Purposes Only - Not To Scale

This floor plan should be used as a general outline for guidance only and does not constitute in whole or in part an offer or contract.
 Any intending purchaser or lessee should satisfy themselves by inspection, searches, enquiries and full survey as to the correctness of each statement.
 Any areas, measurements or distances quoted are approximate and should not be used to value a property or be the basis of any sale or let.