



A two-story red brick house with a dark tiled roof and a large chimney. The house features white window frames and a small dormer window. A large, mature evergreen tree stands in the front garden, partially obscuring the house. To the right, a gravel driveway leads to a light blue garage. The sky is overcast.

NORTH VIEW

Forest Road, Waltham Chase, SO32 2LA

Asking Price £395,000

WELLER
PATRICK



PROPERTY FEATURES

An attractive character home offering flexible and spacious accommodation in the popular village of Waltham Chase

Entrance Hall • Kitchen • Family Room / Dining Room • Sitting Room • Wet Room / Shower Room

Two Bedrooms • Shower Room • Garage with Studio Room • Driveway Parking • Good Size Garden

No forward Chain • Viewing Recommended



DESCRIPTION

This attractive character house offers a convenient location within the popular village of Waltham Chase.

The property offers flexible accommodation and includes a ground floor wet room/cloakroom, a kitchen with door to the garden plus the separate sitting and dining room.

On the first floor are two bedrooms and a shower room.

The garden is a particular feature being of a very good size overall and including a driveway and parking, good sized garage with a studio room to the rear.

The property also benefits from being only a distance away from Waltham Chase's popular primary school, pub, village store and recreation ground.

The traditional country town of Bishop's Waltham is within a short drive and offers a range of shops and amenities from its high street.

Nearby Botley has a mainline railway station and the Cathedral City of Winchester and Southampton Airport are also just under half an hour away, along with all main motorway access routes also being within easy reach.

The property is being offered for sale with no forward chain and viewing is recommended to appreciate all this home has to offer.

DIRECTIONS

From Bishops Waltham proceed on the B2177 to Waltham Chase. At the traffic lights in Waltham Chase turn left into Forest Road. The property can be found on the right-hand side after a short distance.

Particulars amended 9th February 2026

LOCAL AUTHORITY AND SERVICES

Winchester City Council

Council tax band D

Services Mains electricity, gas, water and drainage.

VIEWINGS

By appointment through Weller Patrick.

Tel: 01489 893555





North View
Forest Road
Waltham Chase
SO32 2LA



GROUND FLOOR

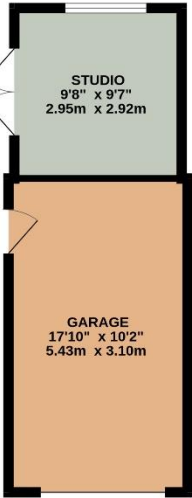

1ST FLOOR

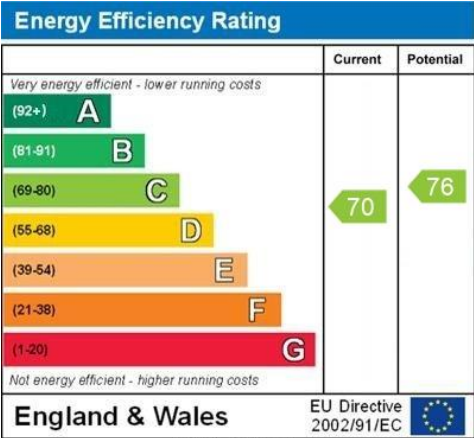
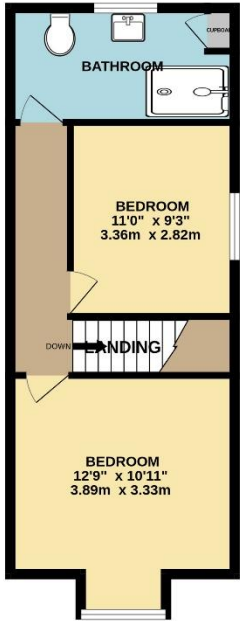

WWW.EPC4U.COM

Whilst every attempt has been made to ensure the accuracy of the floorplan contained here, measurements of doors, windows, rooms and any other items are approximate and no responsibility is taken for any error, omission or mis-statement. This plan is for illustrative purposes only and should be used as such by any prospective purchaser. The services, systems and appliances shown have not been tested and no guarantee as to their operability or efficiency can be given.
Made with Metropix ©2025