



TO LET

15 Portland Rise, Corsham, SN13 9GT

£2,100 Per Month



- Four bedroom detached house
- Garage & parking
- Enclosed rear garden
- Modern feel throughout
- EPC - B (85)
- Council Tax - E (Wiltshire Council)

Corsham in Wiltshire offers the charm of a historic market town with handsome stone buildings, a traditional high street and a friendly, village-like atmosphere, while still having good links to nearby Bath and the wider Cotswolds. Living here means enjoying a relaxed pace of life, independent shops and cafes, and green countryside on the doorstep, making it easy to combine everyday convenience with easy access to walks and scenic drives. There is plenty to do in and around the town: residents can visit Corsham Court and its parkland, explore art, theatre and film at The Pound arts centre, browse regular craft and creative markets, or use the leisure facilities at Springfield Community Campus. Nearby attractions such as the city of Bath, the picturesque villages of Lacock and Castle Combe, and major Wiltshire landmarks like Stonehenge and Avebury add even more options for day trips, culture, and outdoor activities within easy travelling distance

THE PROPERTY

Welcome to 15 Portland Rise, Corsham. A well presented four bedroom detached home with garage and driveway parking for two vehicles.

The ground floor accommodation comprises entrance hall, cloakroom, kitchen dining room with patio doors onto the rear garden, utility space and lounge. The first floor accommodation comprises landing with airing cupboard, principal bedroom with en-suite shower room, three further bedrooms and bathroom.

The property further benefits from an enclosed rear garden with gated access, a single garage with power and lighting, driveway parking for two cars, gas central heating and double glazing.

The property will be let unfurnished.
The landlord would prefer no pets.

SITUATION

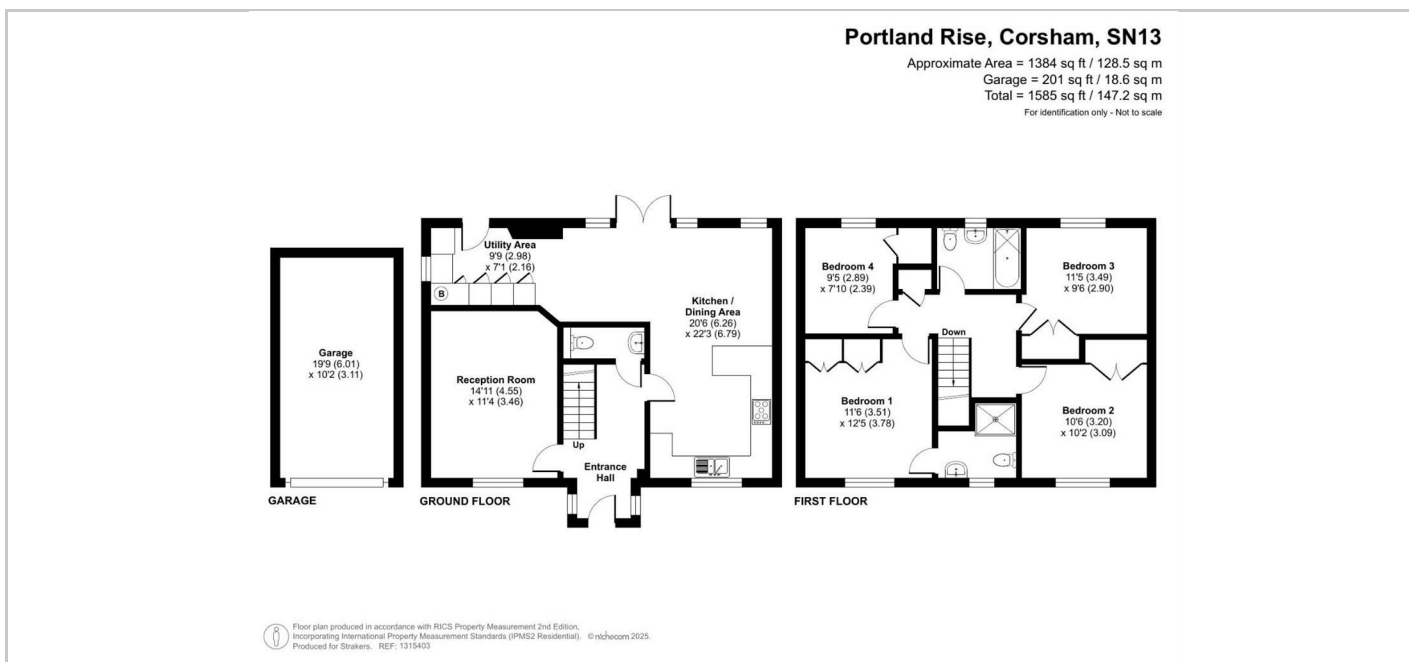

Directions