



Hunter Drive, Irvine, KA12 9BE

Offers Over £75,000

🛏️ 3 🚿 1 🚗 1



- Spacious mid-terrace villa
- Bright dual-aspect lounge with ample dining space
- Modern wet room
- Sought after residential location
- EPC band D (57)
- Three well-proportioned bedrooms
- Large dining kitchen with direct garden access
- Excellent storage throughout
- Private front and rear gardens
- Council tax band B



Spacious and well-maintained three-bedroom family home offering generous room sizes, excellent storage, private gardens, conveniently located close to schools, amenities and transport links.

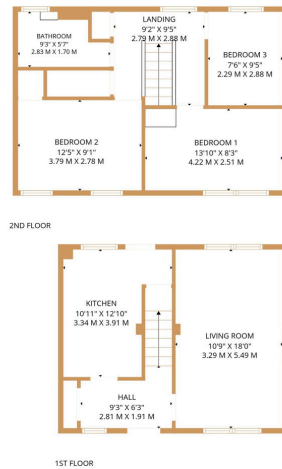

TOTAL: 876 sq. ft. 82 m²
 1st floor: 397 sq. ft. 37 m², 2nd floor: 479 sq. ft. 45 m²
 EXCLUDED AREAS: WALLS: 87 sq. ft. 8 m²
SIZES AND DIMENSIONS ARE APPROXIMATE, ACTUAL MAY VARY. © FLOOR WALLS MEDIA.

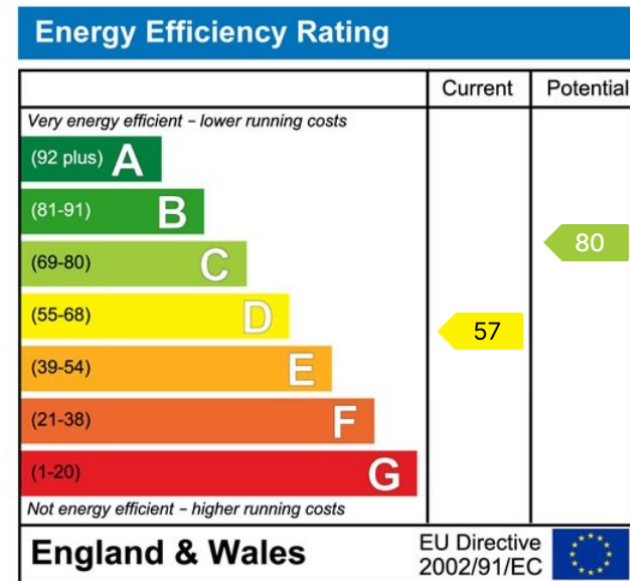

01292 437 045
 office@belmontproperty.com
 24 Dalmellington Road, Ayr, KA7 2PZ

belmontproperty.com

Agents Note: Whilst every care has been taken to prepare these sales particulars, they are for guidance purposes only. All measurements are approximate and for general guidance purposes only and whilst every care has been taken to ensure their accuracy, they should not be relied upon and potential buyers are advised to recheck the measurements