

## 11 Chalkdown, Stevenage, SG2 7BG

**Guide price £490,000**

**\*\* Guide Price £490,000 - £500,000 \*\***

Located in Chells Manor is this chain free, detached four bedroom family home with a garage and off road parking.

Step inside a bright and welcoming entrance hall, with space to store coats and bags. The lounge is a generously proportioned room, filled with natural light from French doors opening onto the south-facing garden. At its heart is a fireplace with a log burner and oak surround, creating a warm and inviting atmosphere, perfect for cooler evenings.

The kitchen and dining room is spacious, with bi-fold doors leading out to the garden, ideal for entertaining family and friends. There is ample worktop space for cooking and baking, together with a convenient breakfast bar for more informal dining. Appliances include a range cooker with hob and extractor, along with space for a dishwasher. Off the kitchen is a practical utility room with space for a



Floor Plan

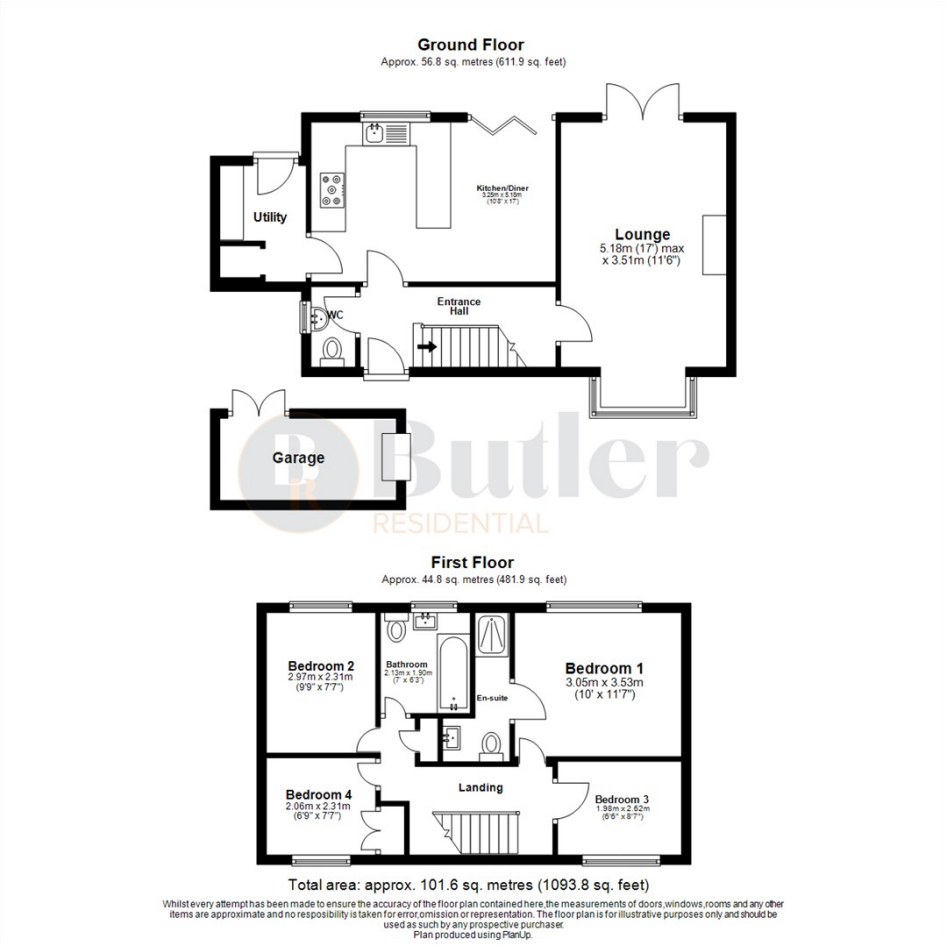

Area Map

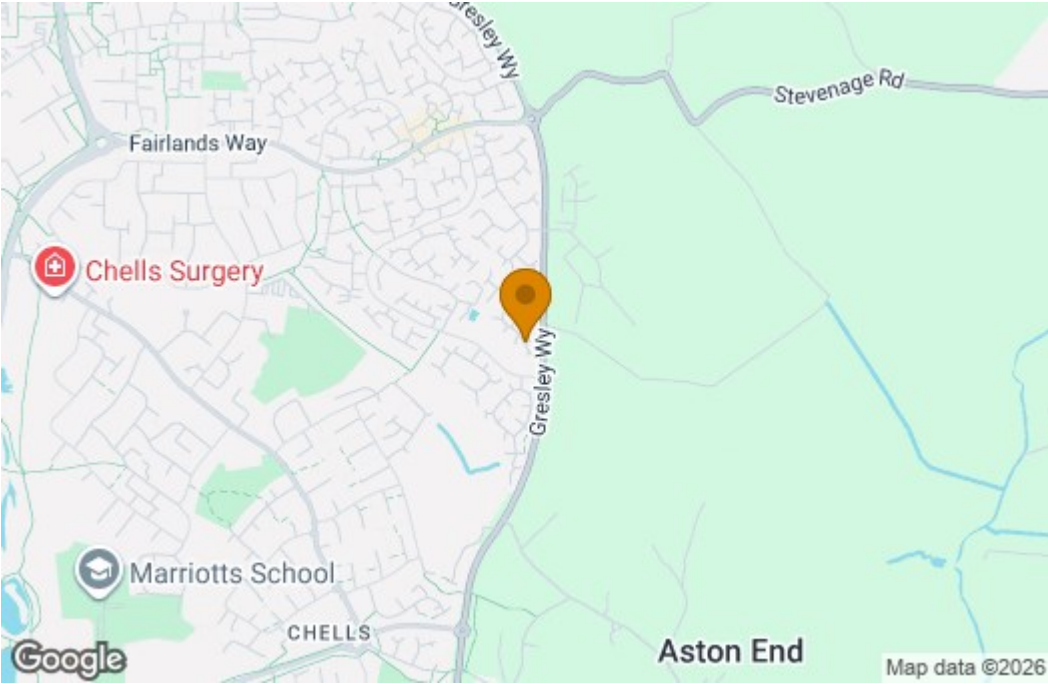

Energy Efficiency Graph

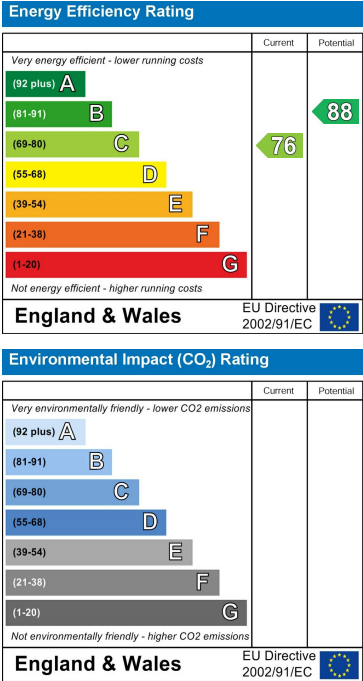

These particulars, whilst believed to be accurate are set out as a general outline only for guidance and do not constitute any part of an offer or contract. Intending purchasers should not rely on them as statements of representation of fact, but must satisfy themselves by inspection or otherwise as to their accuracy. No person in this firm's employment has the authority to make or give any representation or warranty in respect of the property.