



Musgrove Road, SE14

£250,000

This lower ground one bedroom apartment is now available. There is a spacious open plan kitchen reception room, a double bedroom and family bathroom. This property is offered with no onward chain.

Musgrove Road is a prestigious tree lined road in the sought after Telegraph Hill Conservation Area, perfectly positioned for the popular cafés, shops and restaurants in New Cross and Brockley. Frequent rail links can be found at nearby New Cross Gate station, with access to London Bridge in as little as 10 minutes.

Features

- Victorian Apartment
- Lower Ground
- No Onward Chain
- Double Bedroom
- Open Plan
- Gas Central Heating

Musgrove Road, London, SE14

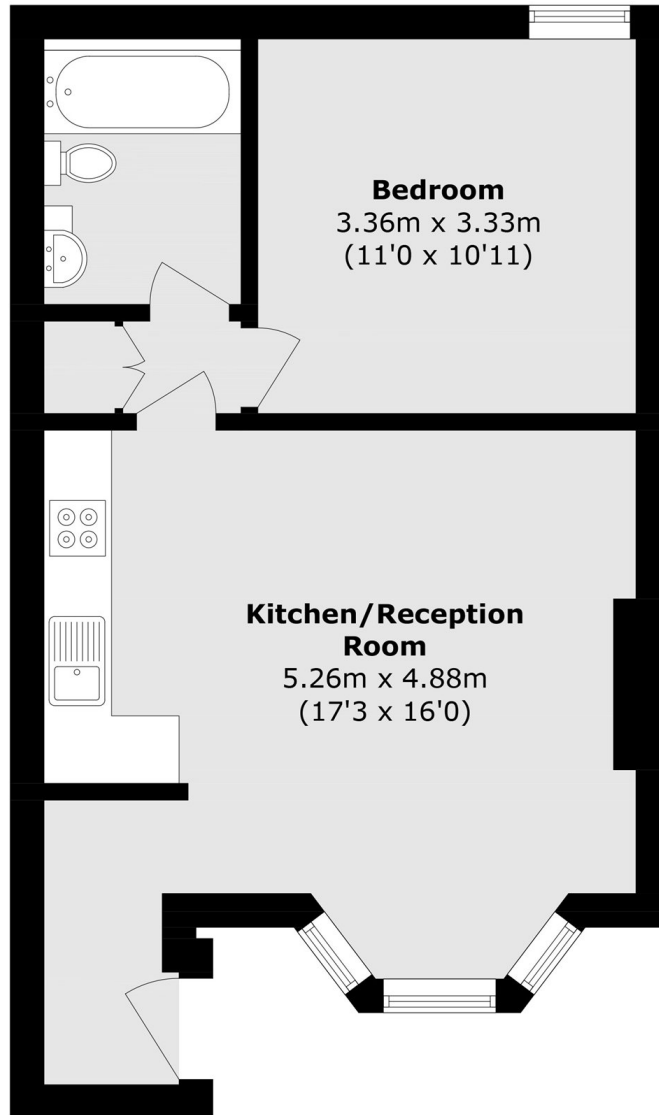

Total area (approx.): 43.2 sq. m (465 sq. ft)